

RAF SE5a Bauanleitung



Hallo, wir sind Tony Ray & Sebastian Hansen. Zusammen sind nun seit einiger Zeit in der Modellbau-Szene unterwegs.

Von Eindecker bis Doppeldecker, von großen Modellfliegern bis kleinen Slow Flyern.

In unserer Modellbauwerkstatt verbringen wir gut und gerne eine ganze Nacht am entwerfen neuer Pläne.

Seit Anfang 2019 verkaufen wir nun unsere ersten eigenen Baukästen in Europa.

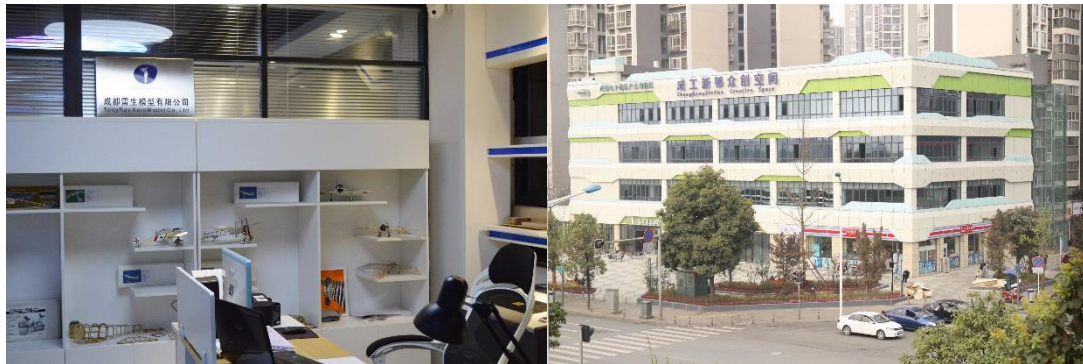

Allzeit guten Flug!

Holm und Rippenbruch,

Ihr Tony & Sebastian

Hier haben Sie ein paar Eindrücke von unserer Arbeit!



Jeder startet einmal klein. So verkaufen wir seit einiger Zeit unsere verschiedenen Modelle erfolgreich in Europa.



Wenn Tony einmal anfängt über Baupläne und seine Flieger zu reden, ist er gar nicht mehr zu stoppen!

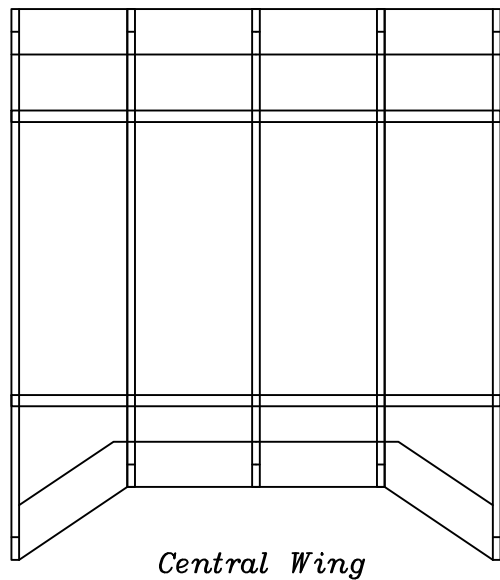
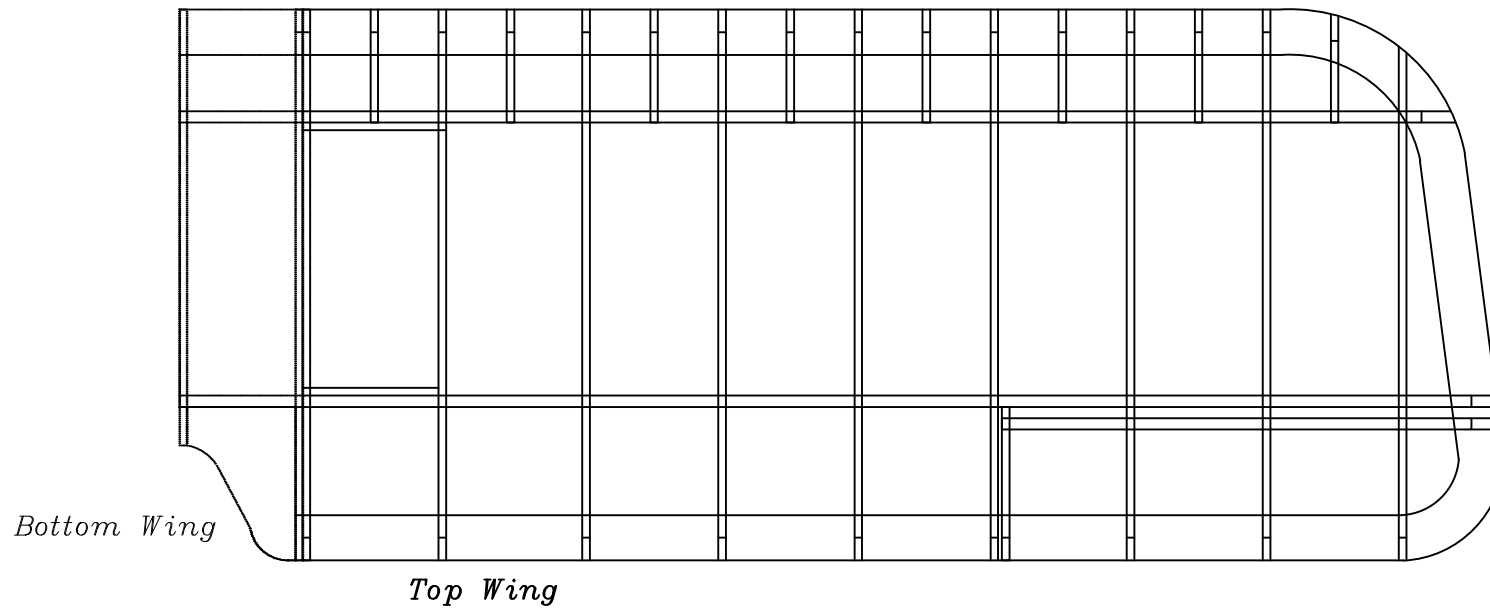

Right Wings

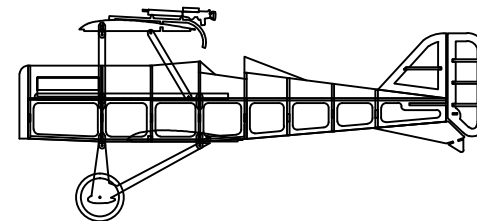
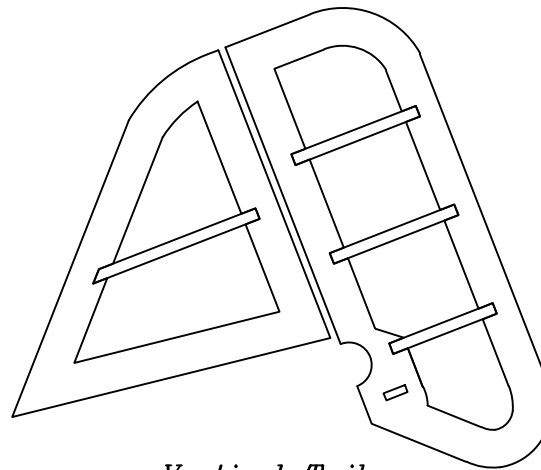

RAF SE5A
TonyRay's AeroModel
page 2 of 2

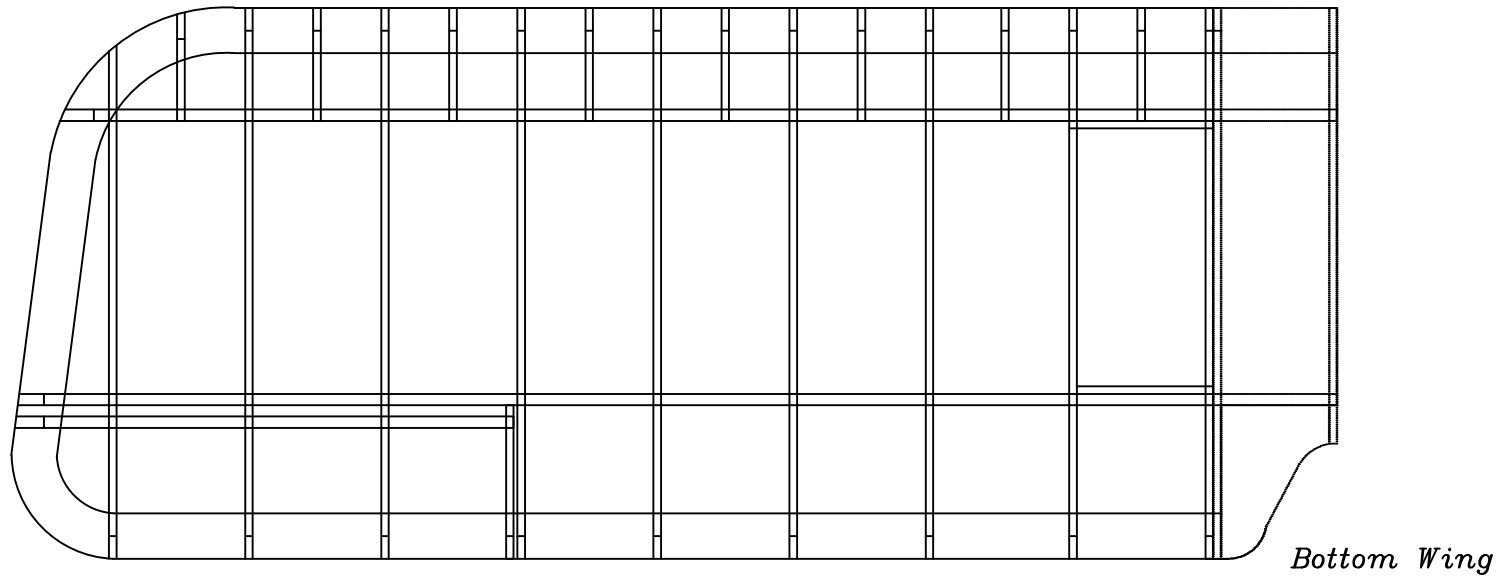

Left Wings

Top Wing

Bottom Wing

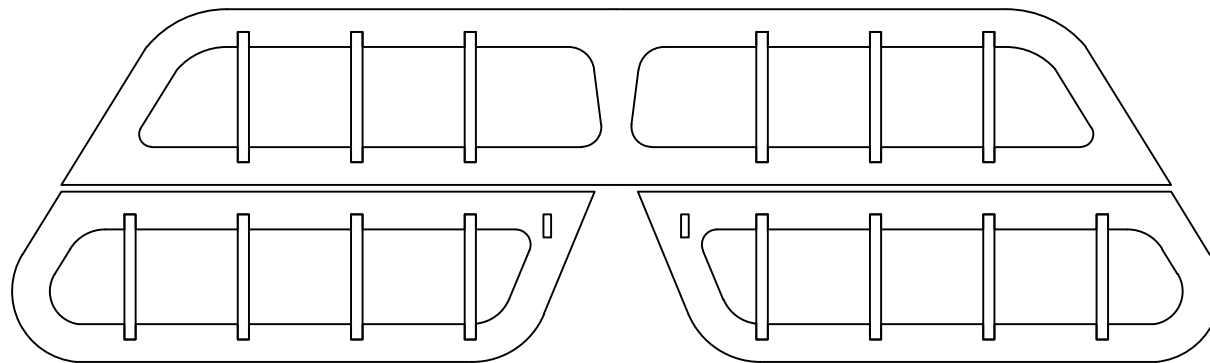

Horizontal Tail

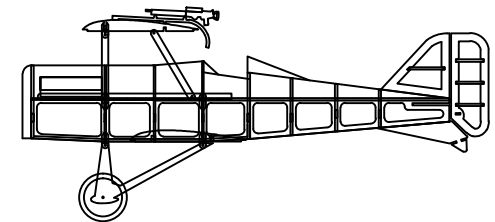

RAF SE5A

TonyRay's AeroModel

page 1 of 2

RAF SE5A Bau Anleitung

www.slowflyer-bausaetze.de/bauanleitungen7

Flugzeugdaten: RAF SE5A / Spannweite: 380 mm / Gewicht ohne Elektronik: 30,5 g /
Fluggewicht: +- 48,4 g



RAF SE5A – KIT Lieferumfang:

- 6 x Balsa-Holz-Blatt, 1 x Sperrholz Blatt
- 2 x Carbon Stab, 1 x Scharniervlies, 20 x Micro Schraube, 2 x Gummi Reifen, 8 x Mini Magnet, 1 x Schrumpfschlauch
- 1 x Bespannmaterial (Japanpapier mit 17 g pro m²)
- NICHT MIT DABEI: Sticker-Aufkleber, Elektronik, Komponenten

Wichtige Info: Wir sind bei allen Problemen für Sie da. Egal was, egal wann. Wir haben für jedes Modell **Ersatzteile** auf Lager, die wir Ihnen bei Bedarf zuschicken.

Schreiben Sie uns an unter info@slowflyer-bausaetze.de

Drucken Sie diese Anleitung aus oder benutzen Sie Ihr Tablet oder andere Bildschirme.

Montageanleitung in 122 Schritten (4 Teile)

Step1

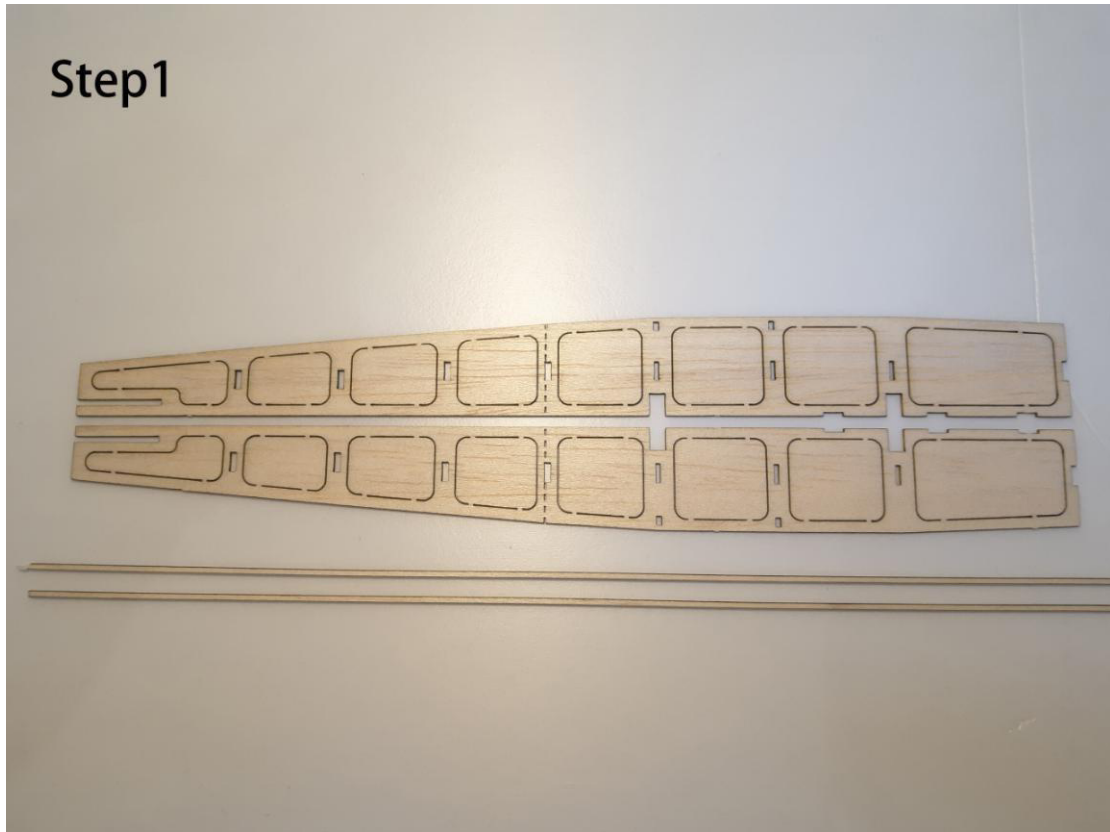

Step2

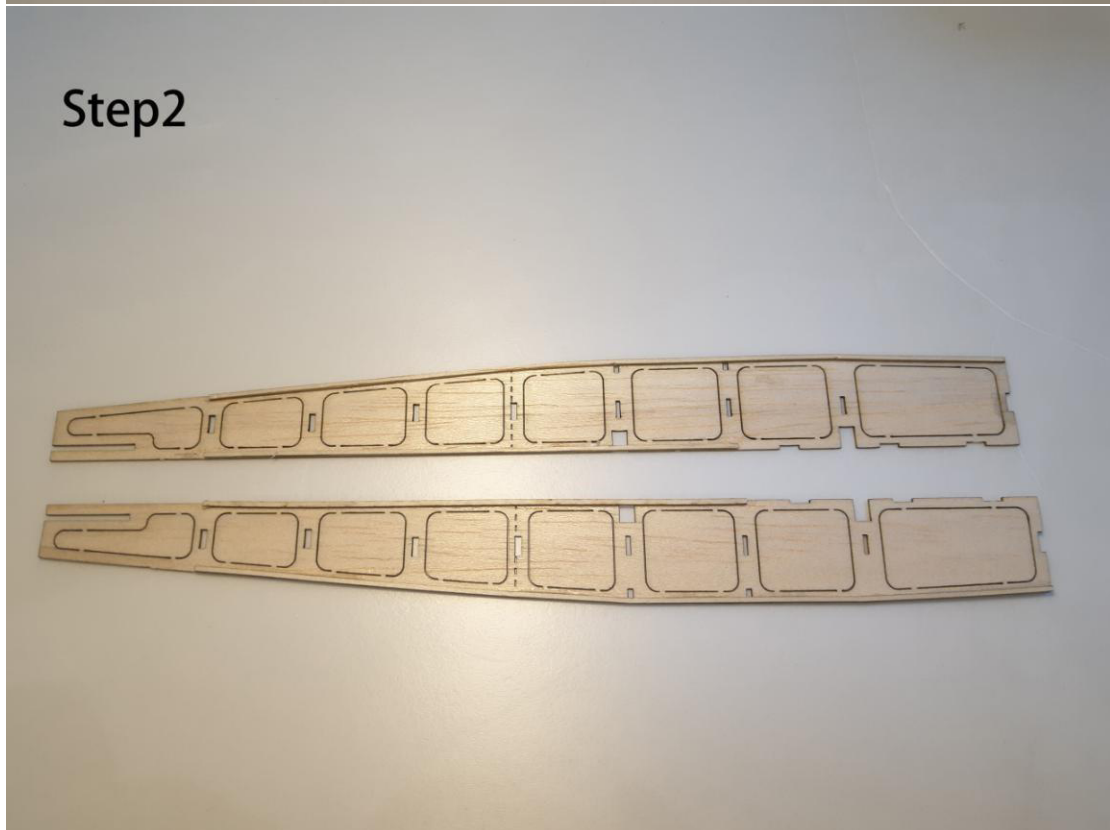

Step3

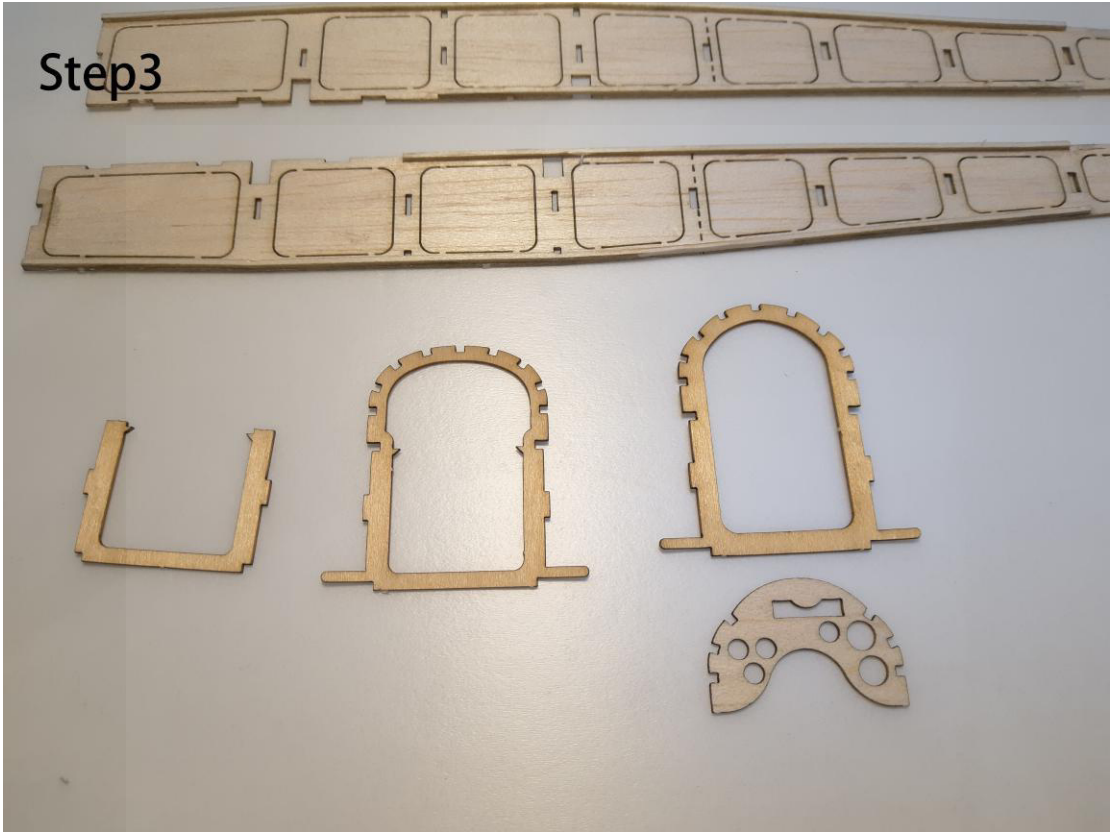

Step4

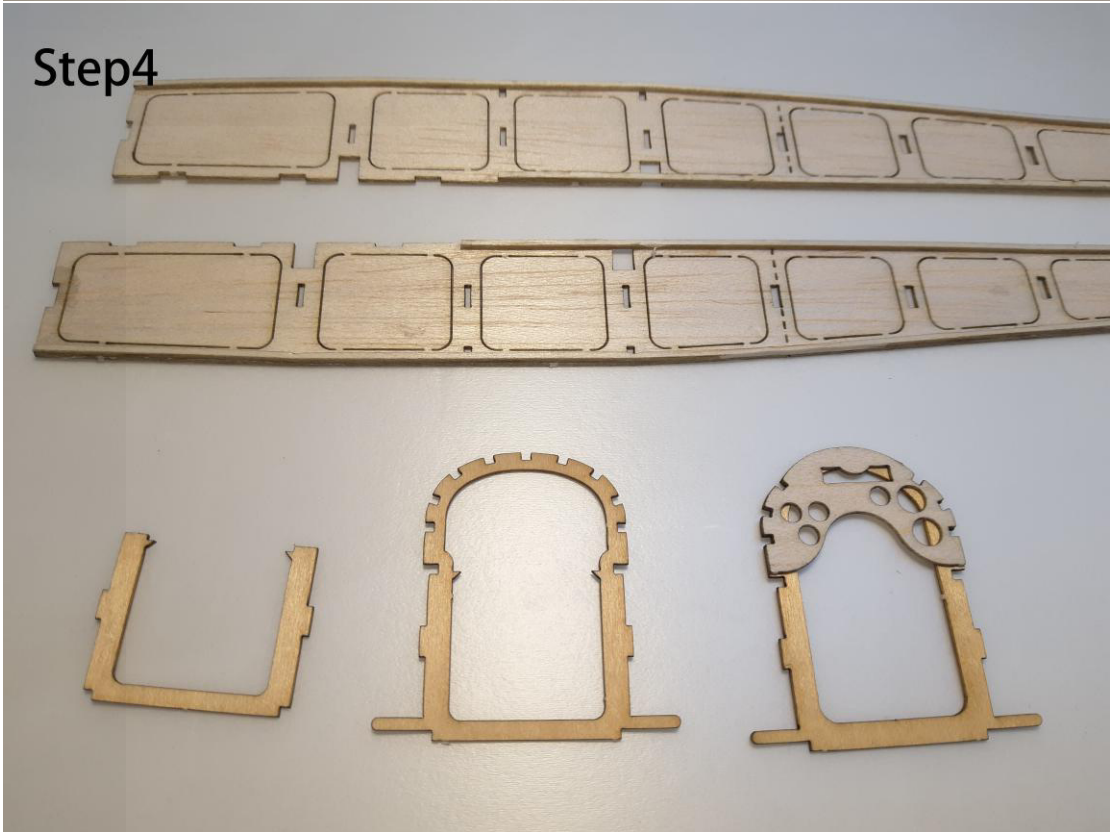

Step5

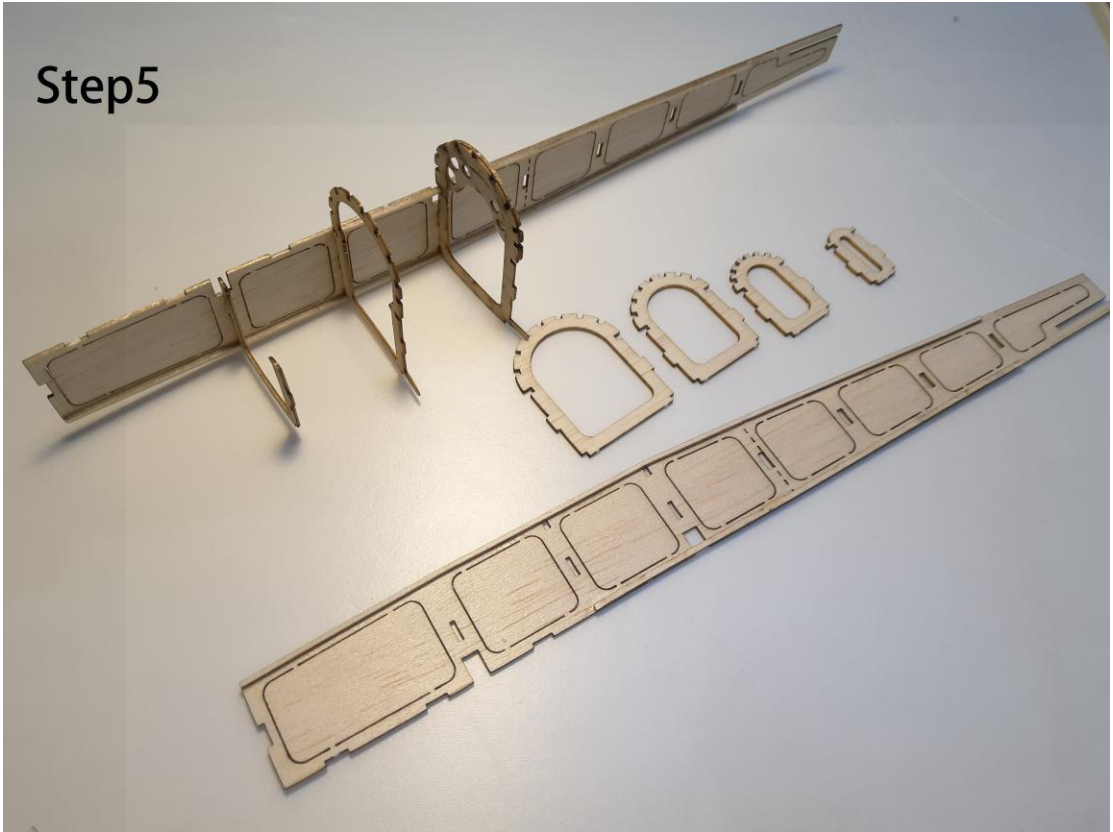

Step6

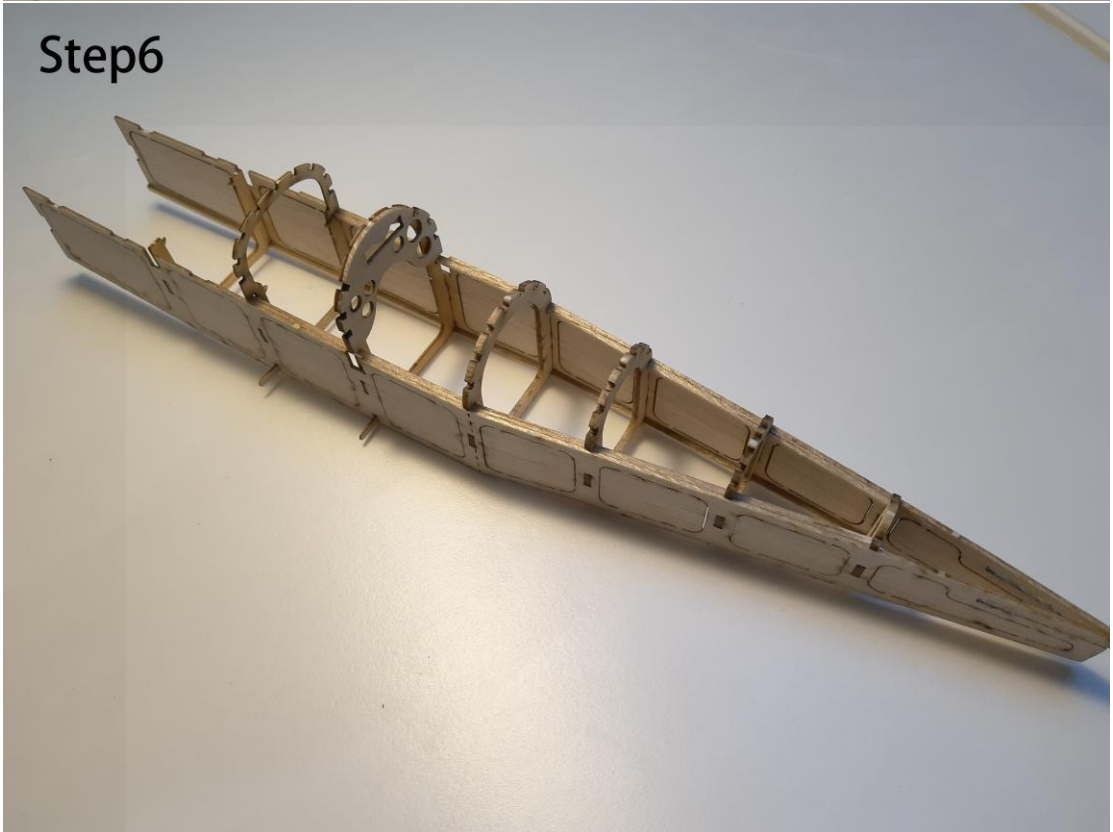

Step7

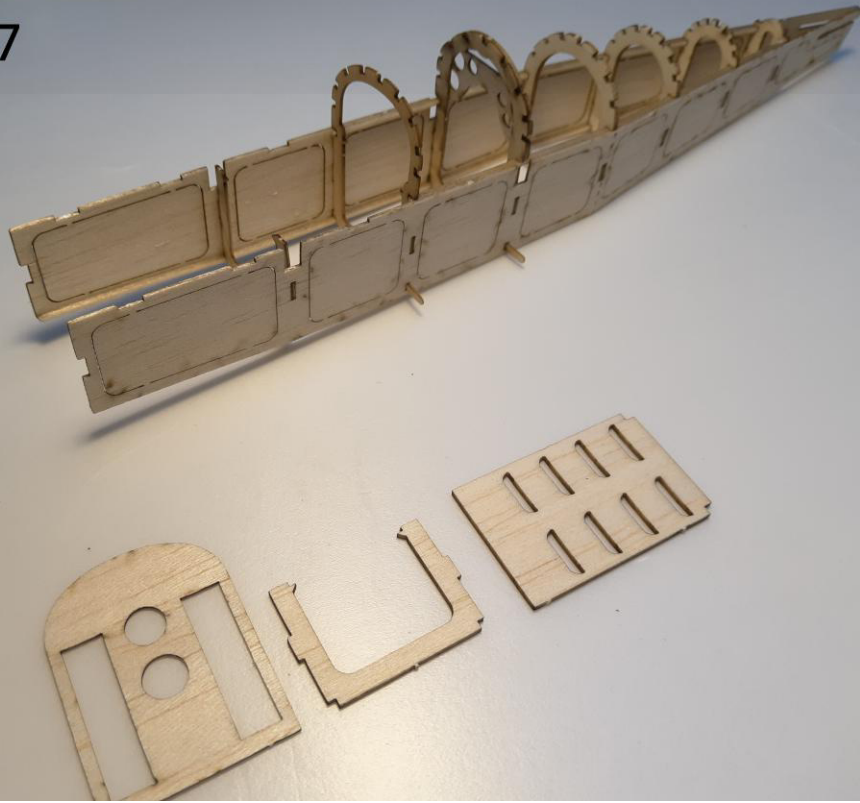

Step8

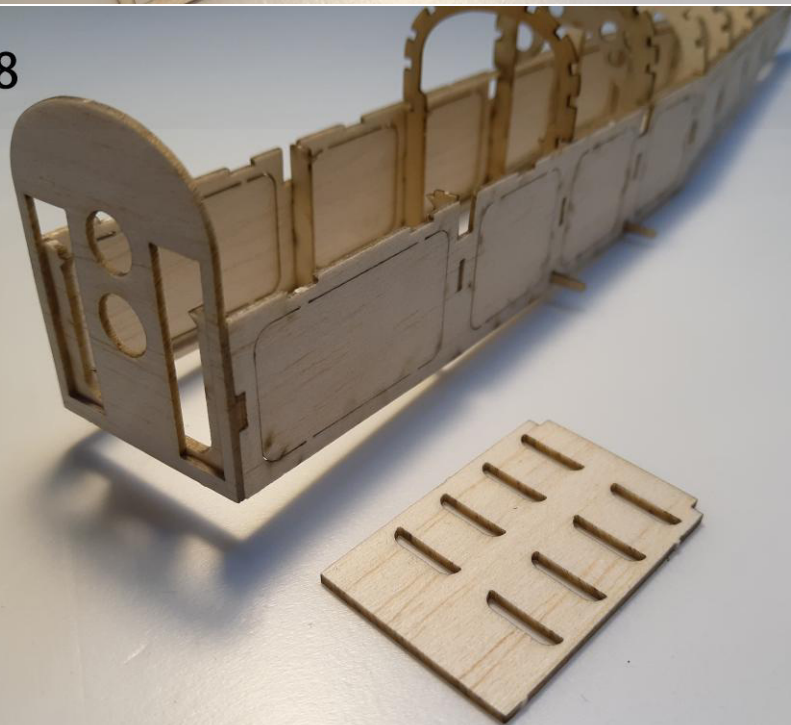

Step9

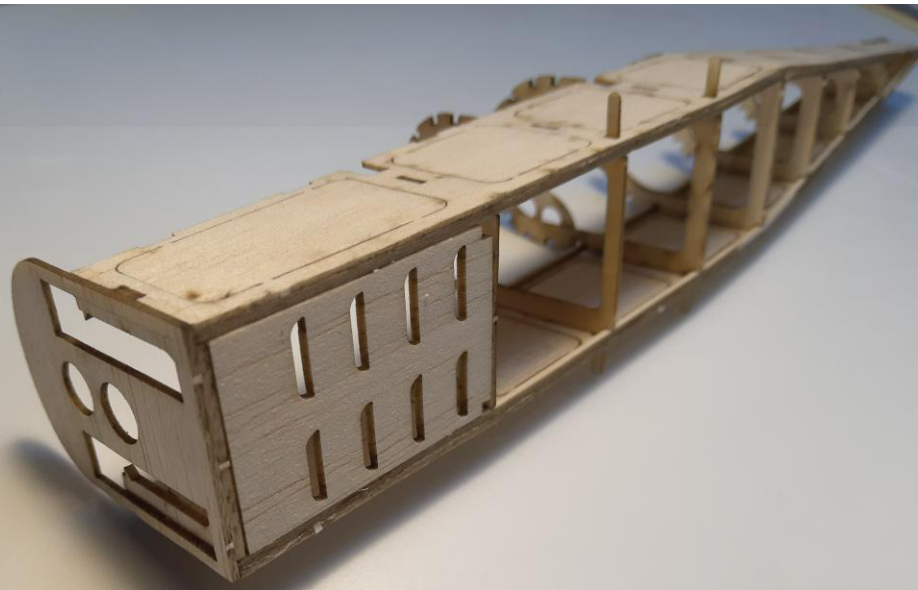

Step10

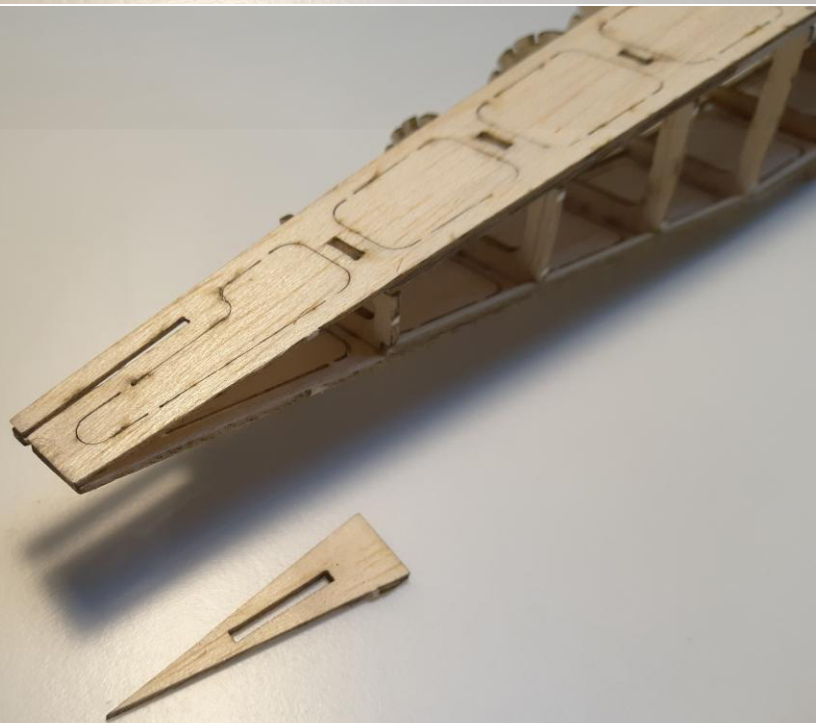

Step11

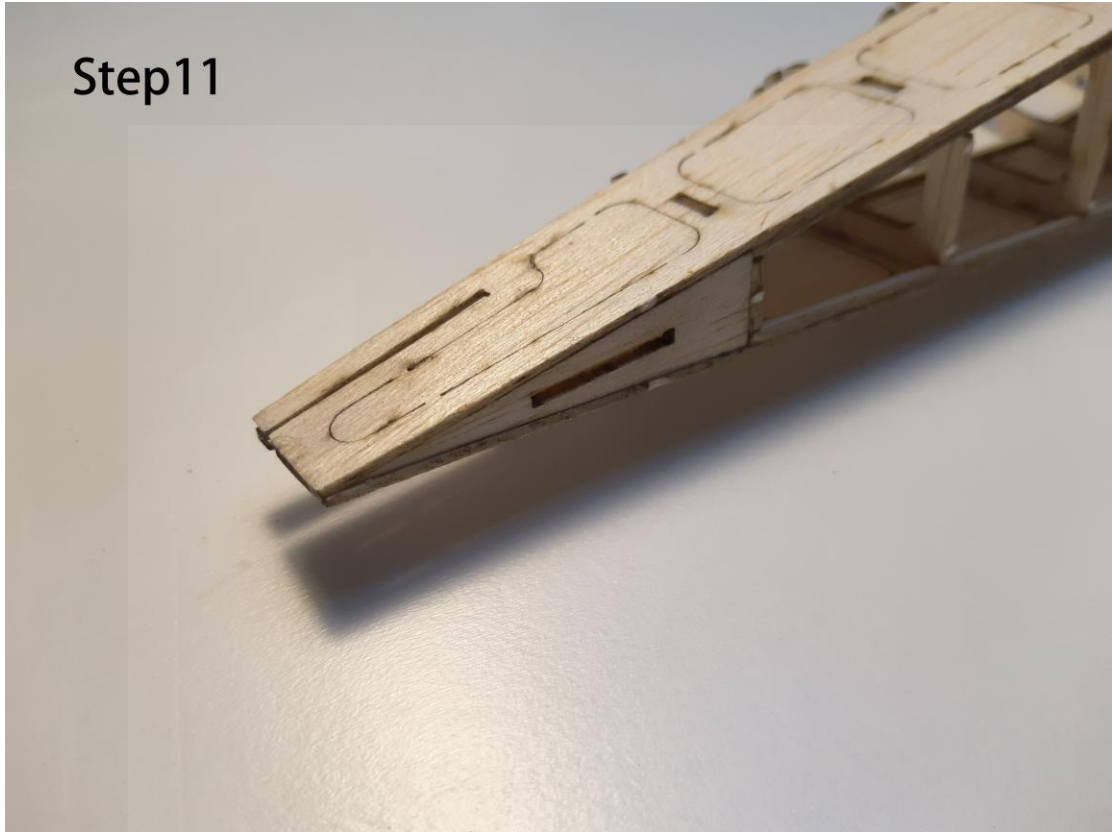

Step12

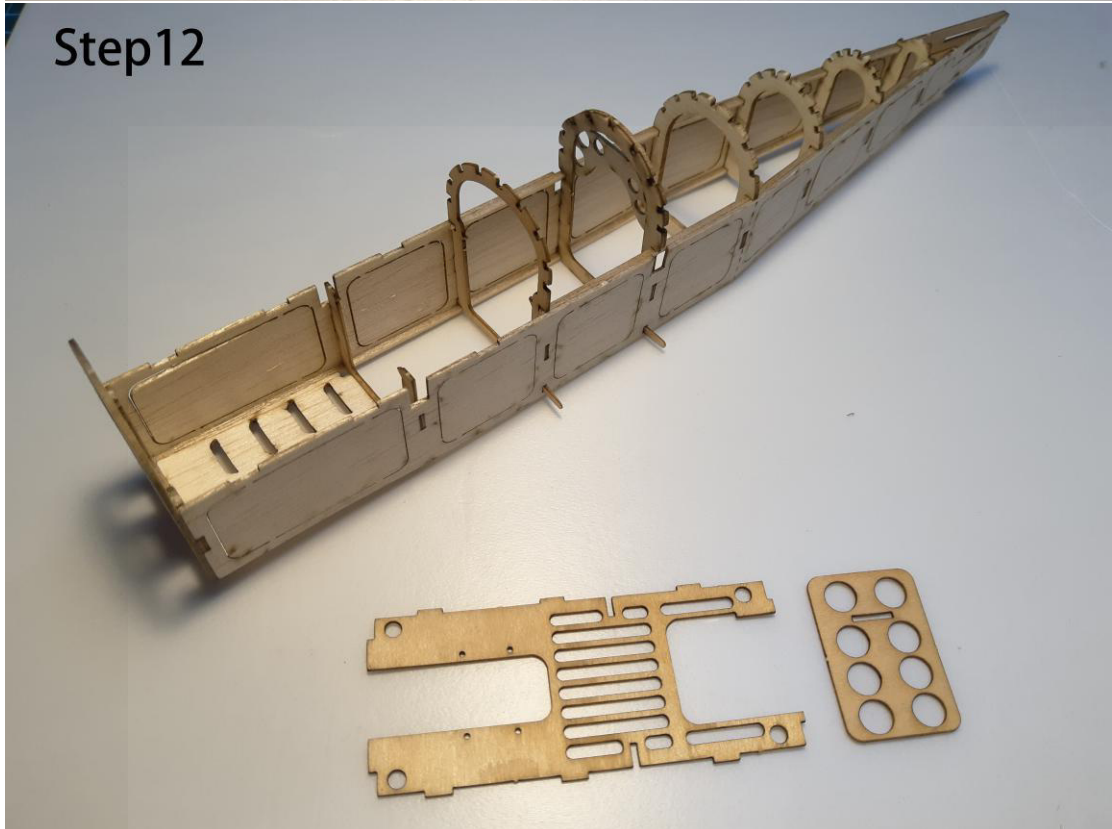

Step13

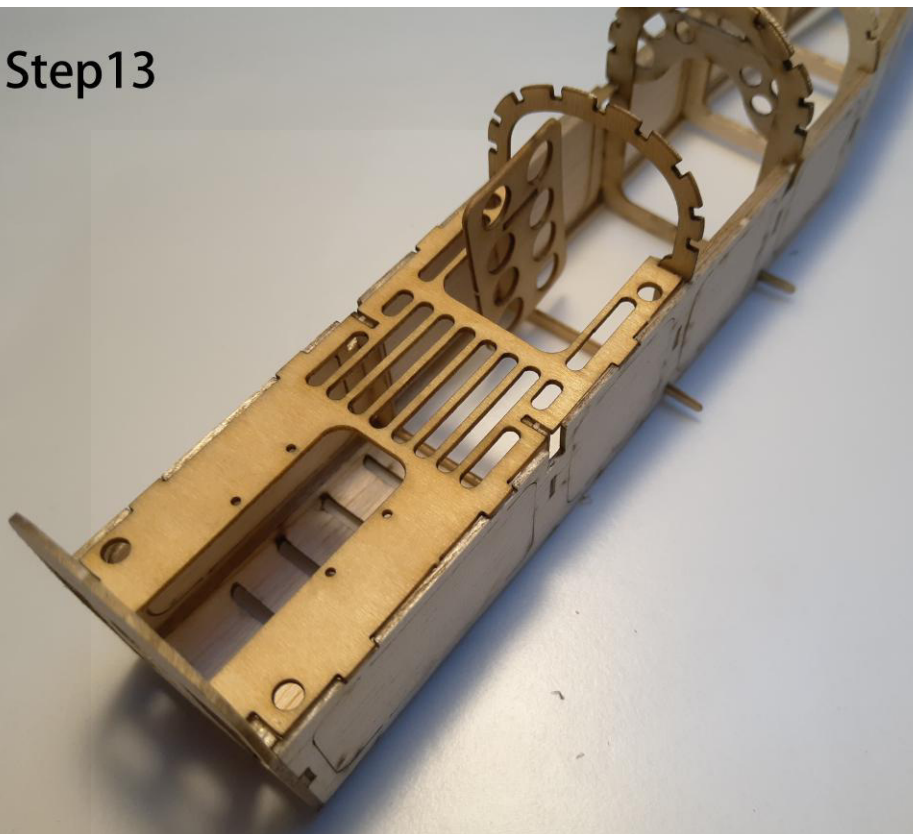

Step14

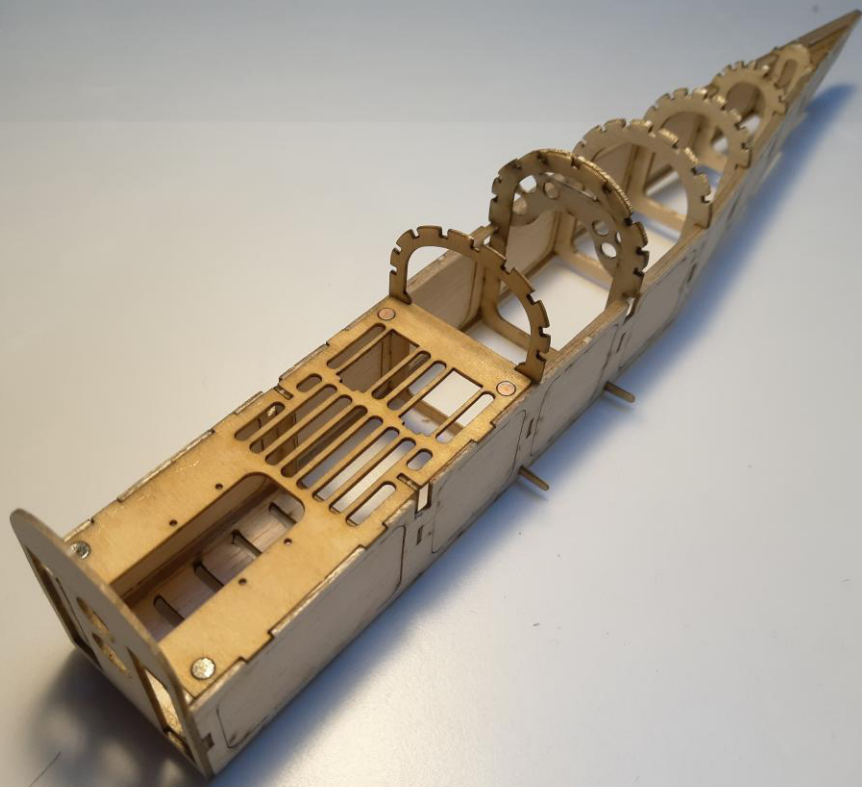

Step15

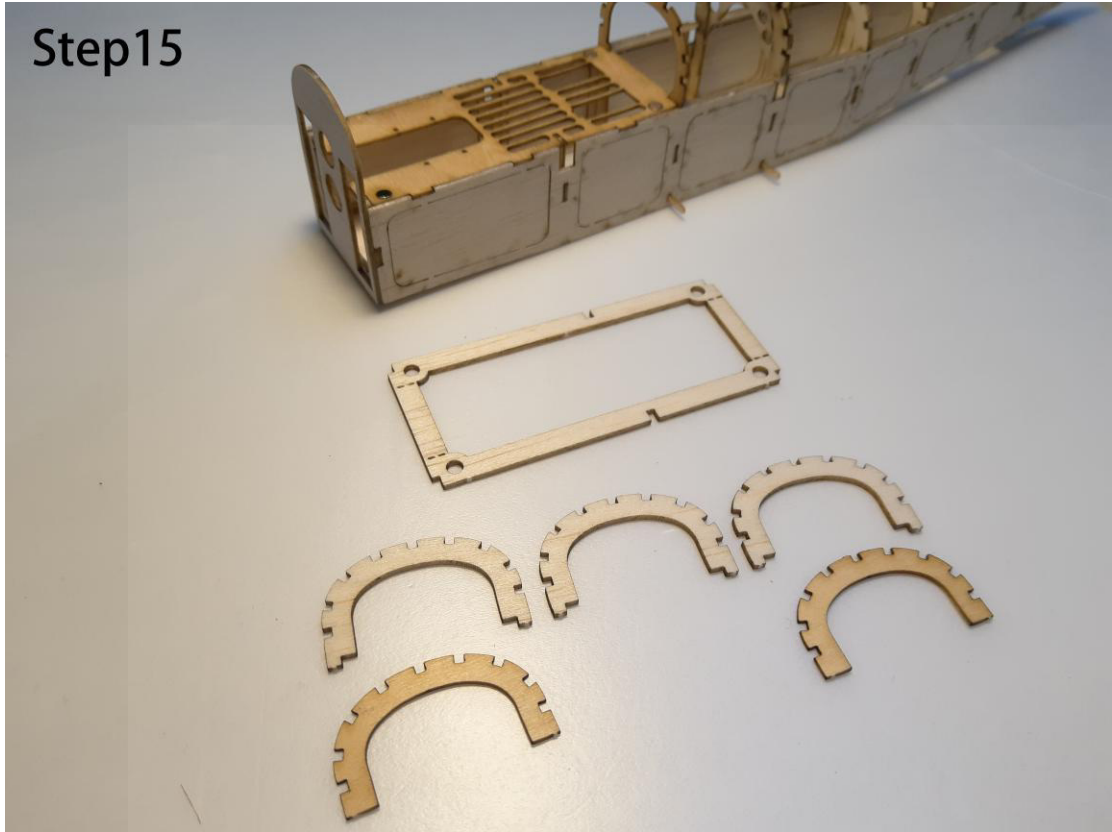

Step16

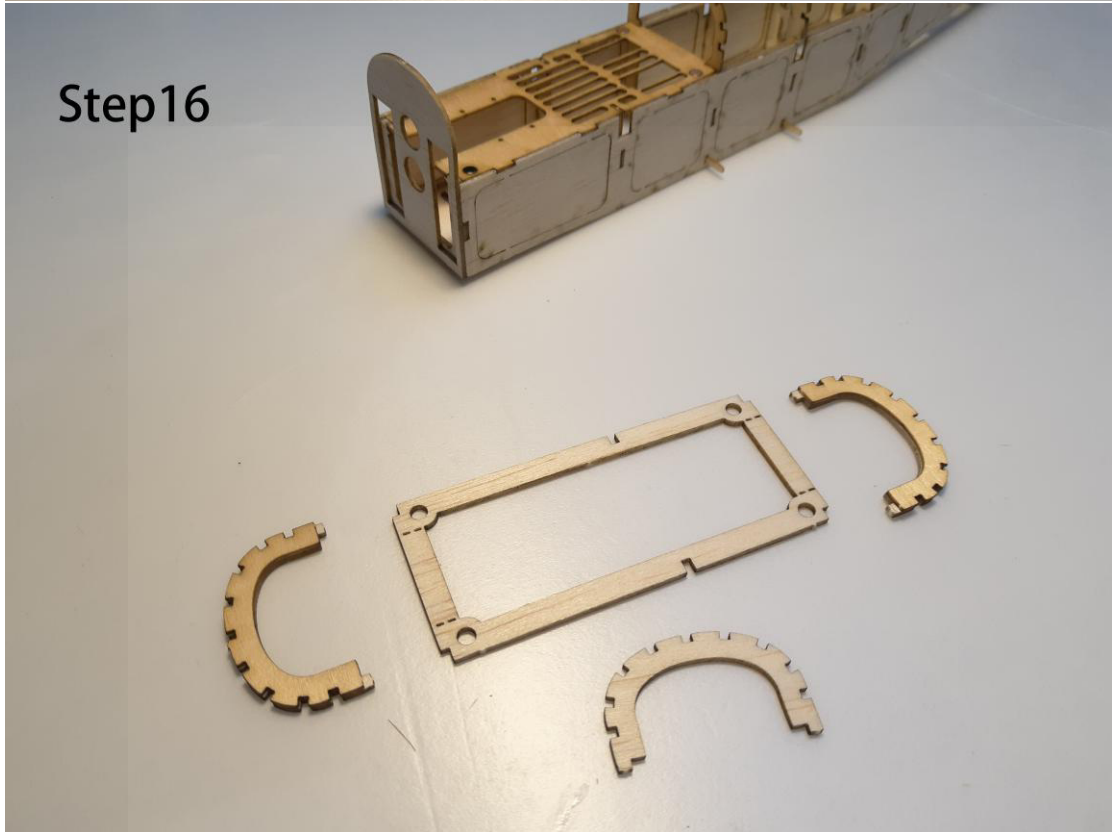

Step17

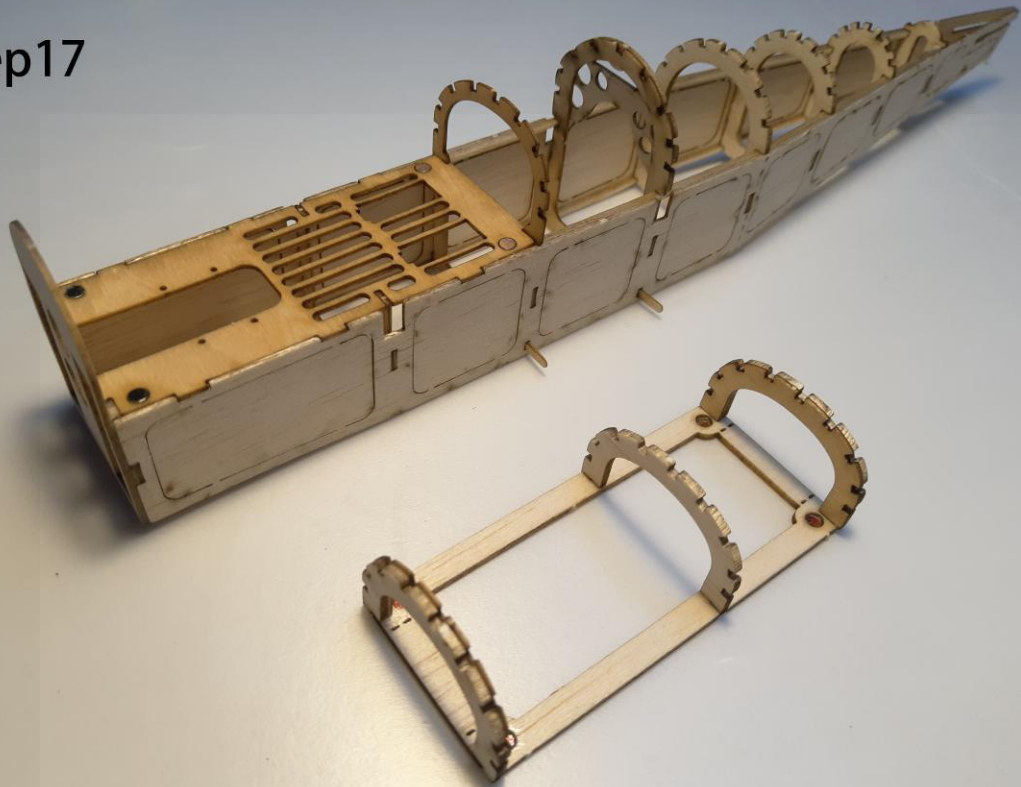

Step18

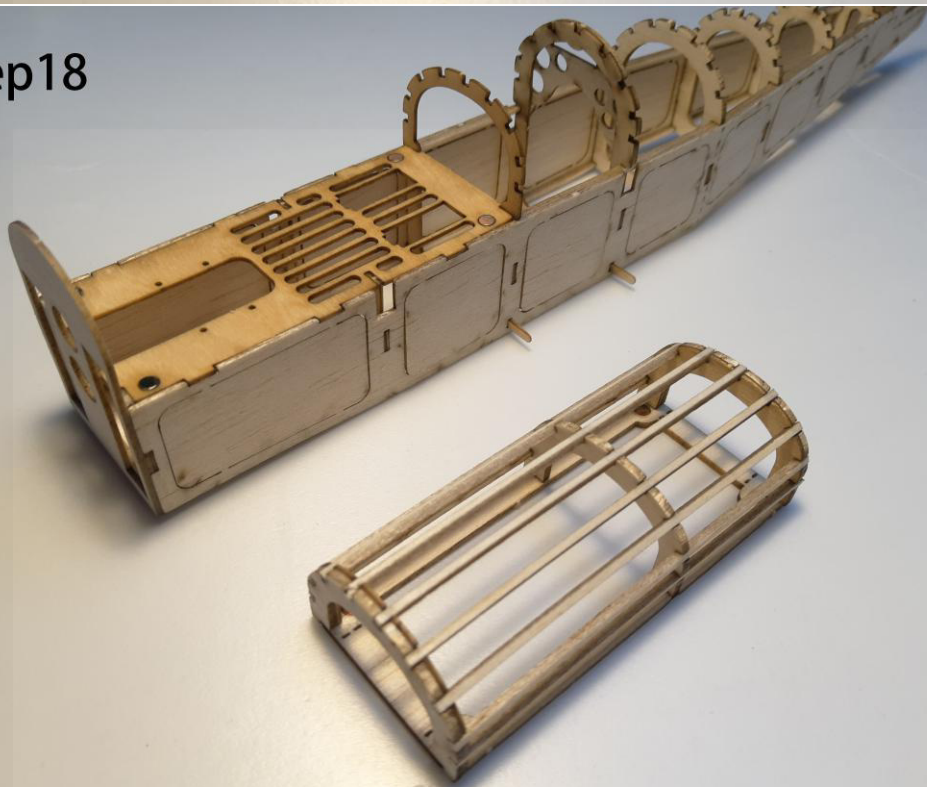

Step19

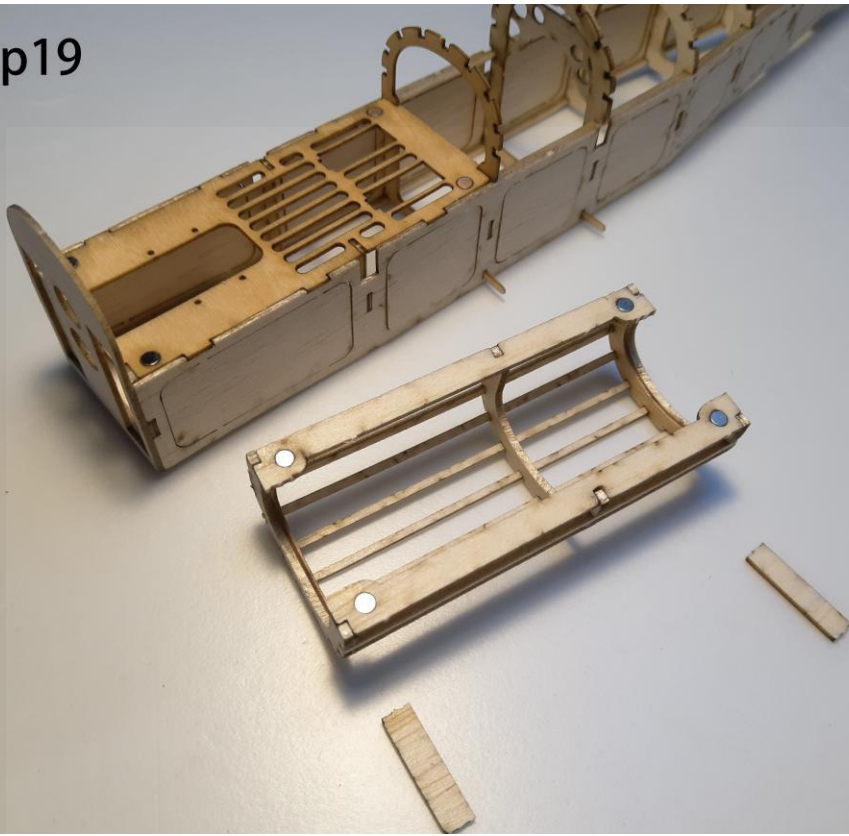

Step20

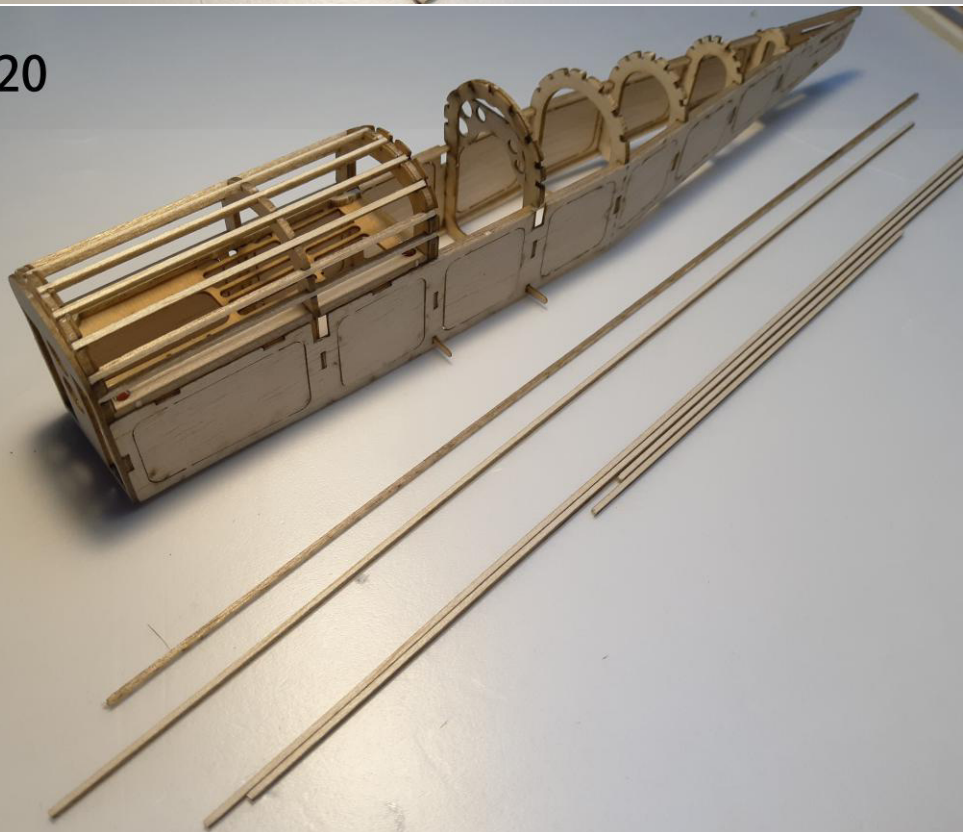

Step21



Step22

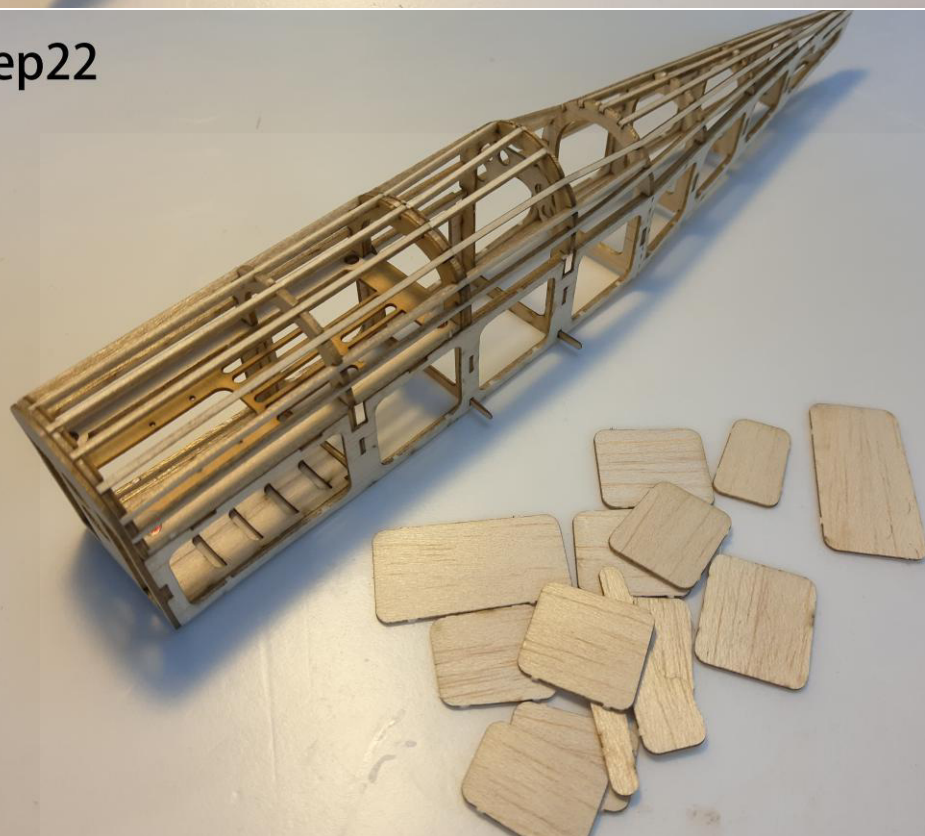

Step23

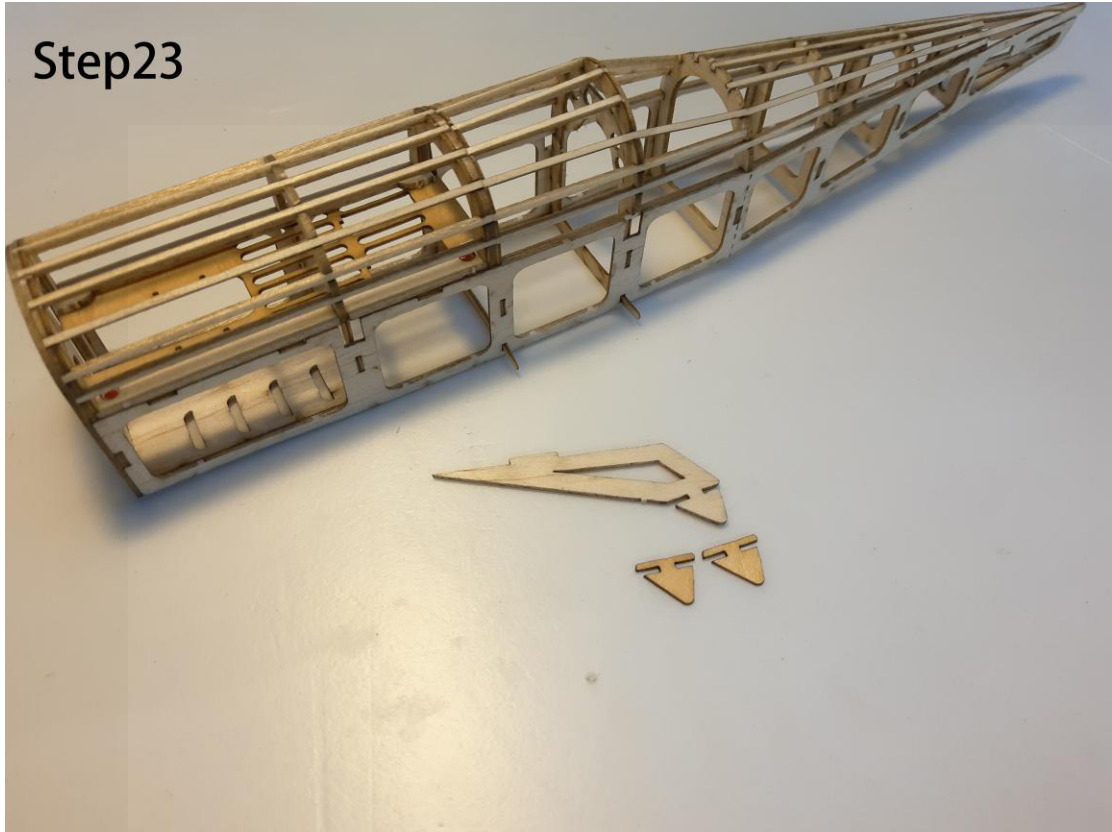

Step24

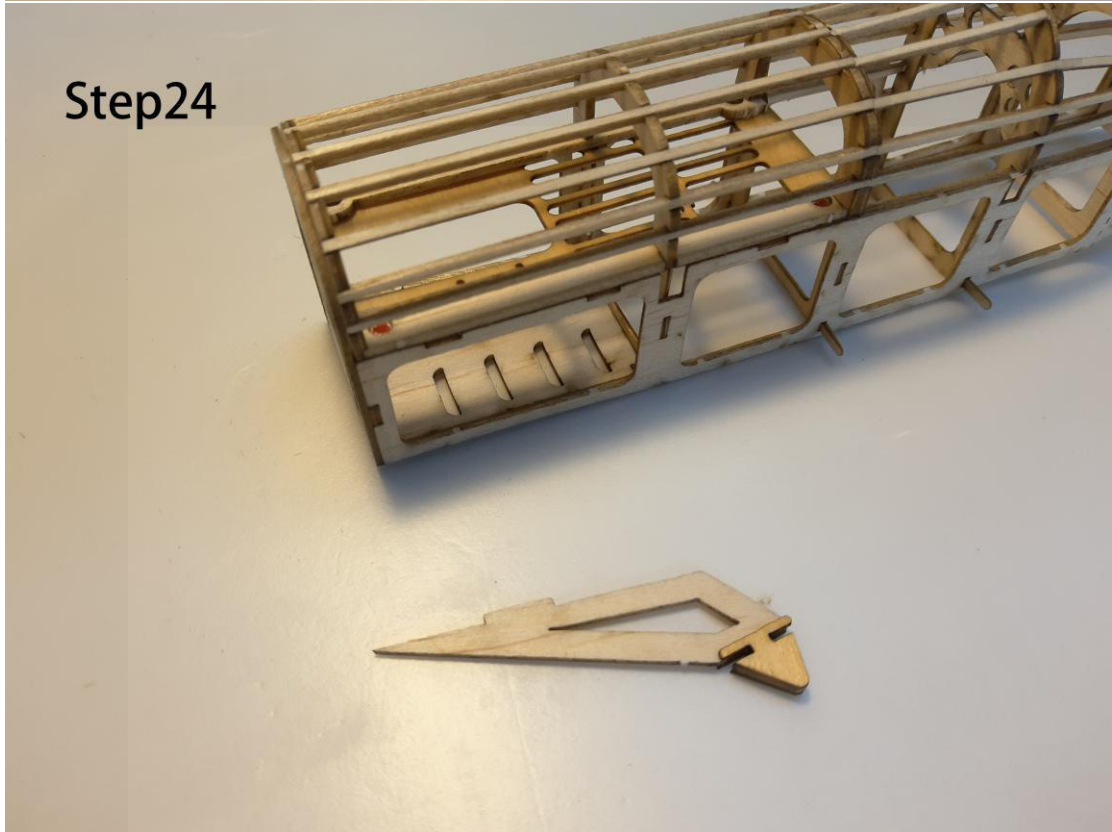

Step25

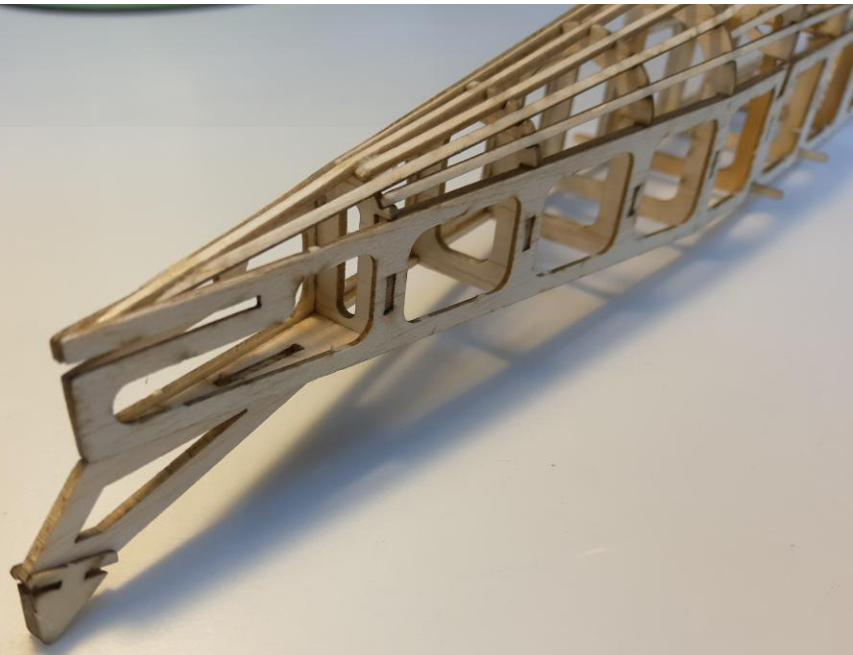

Step26

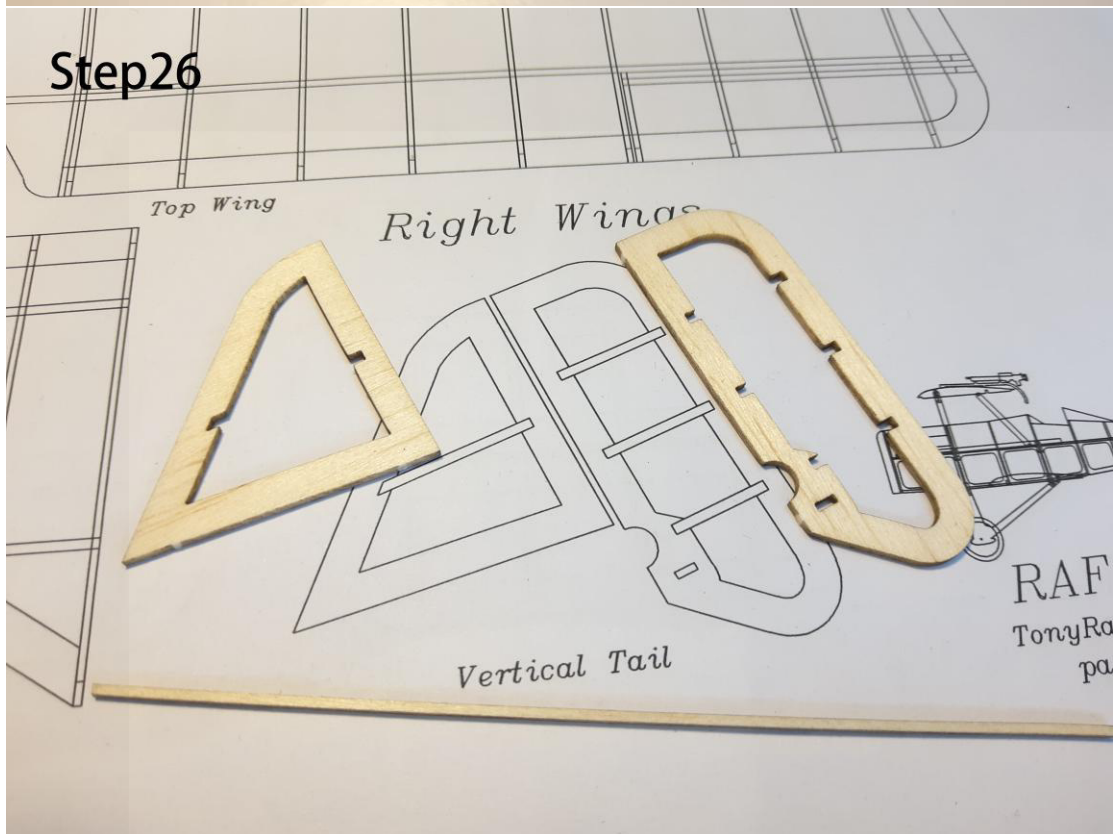

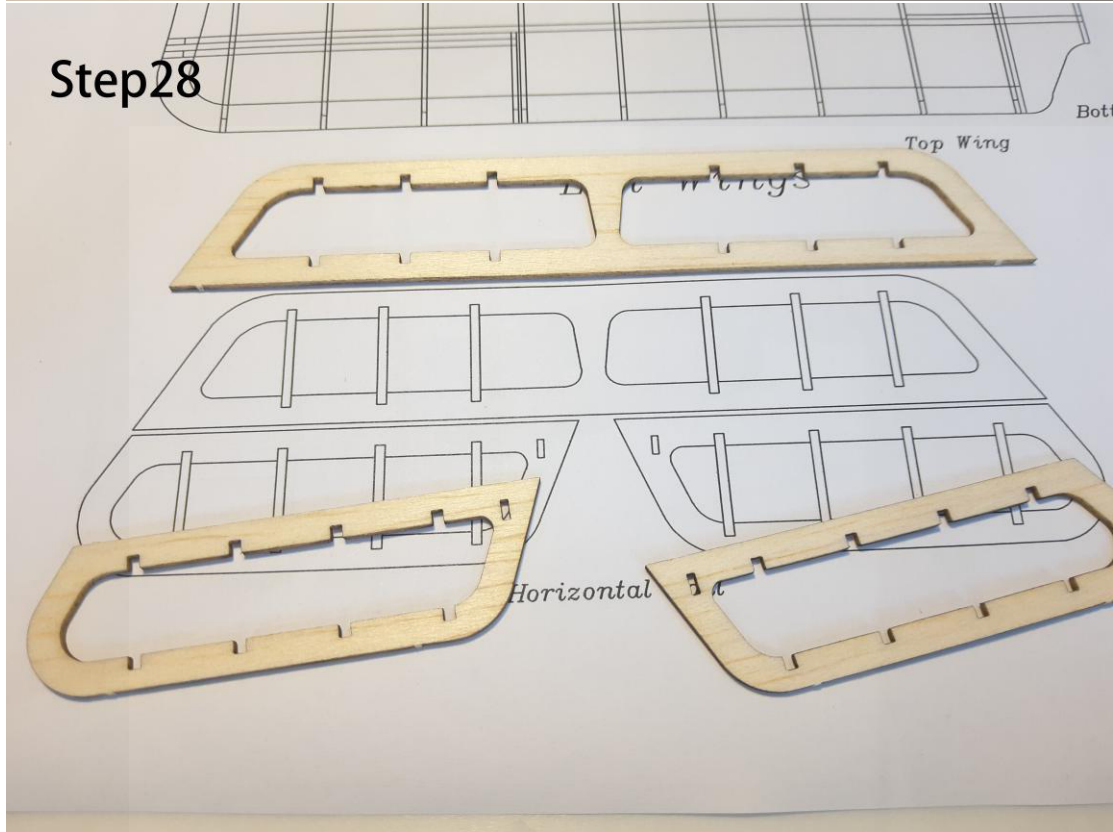
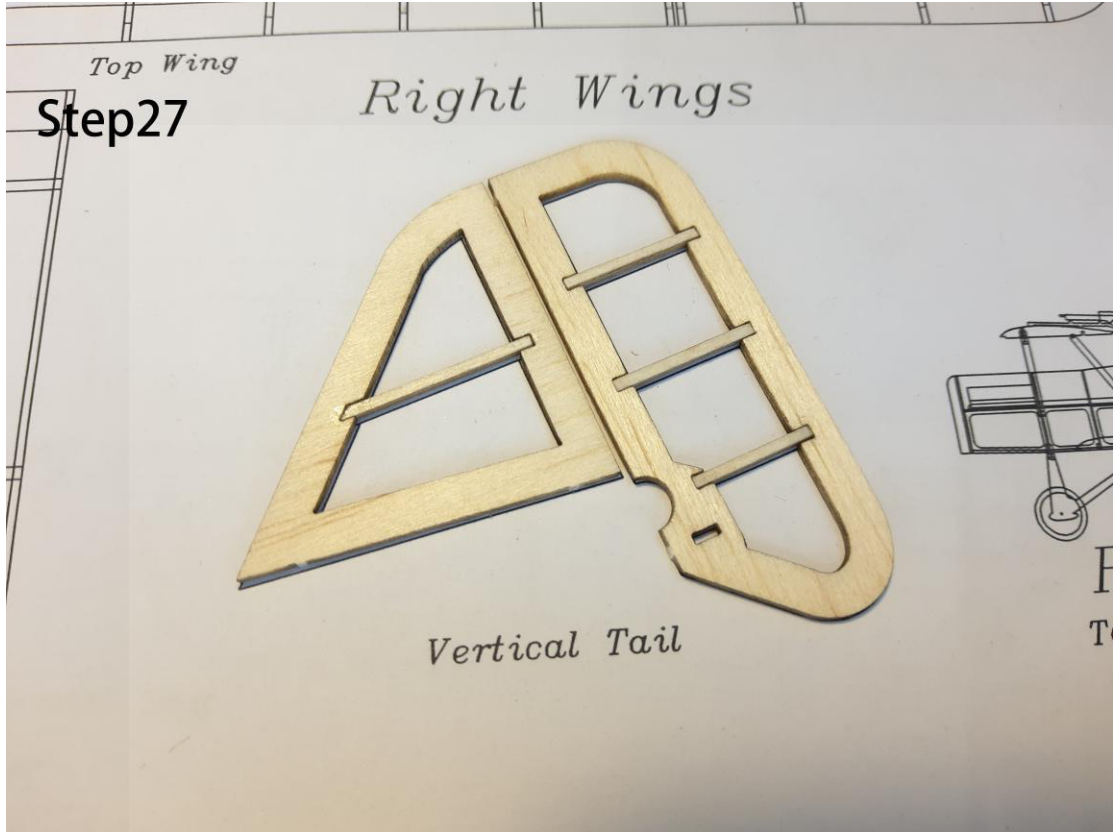

Step29

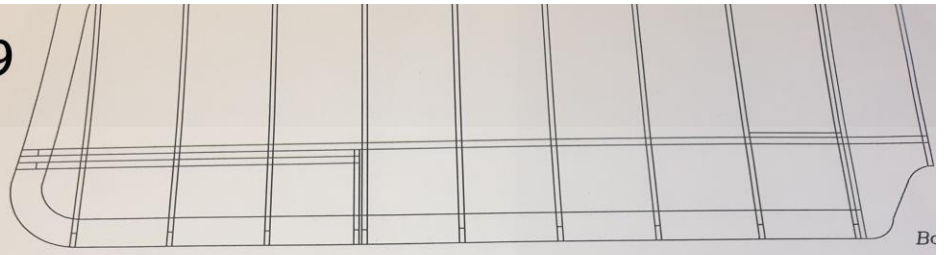

Top Wing

Left Wings

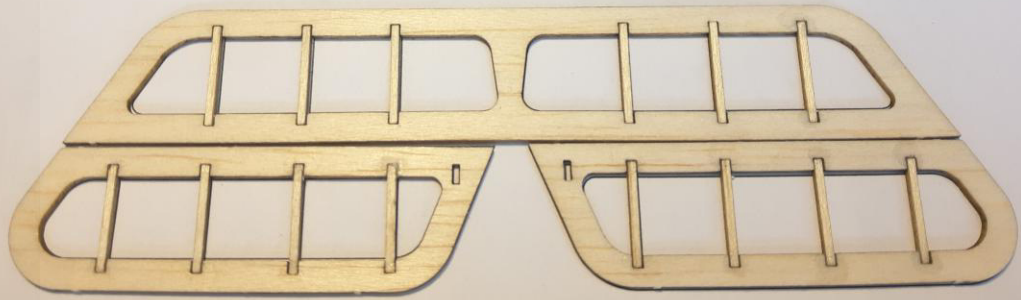

Horizontal Tail

Step30

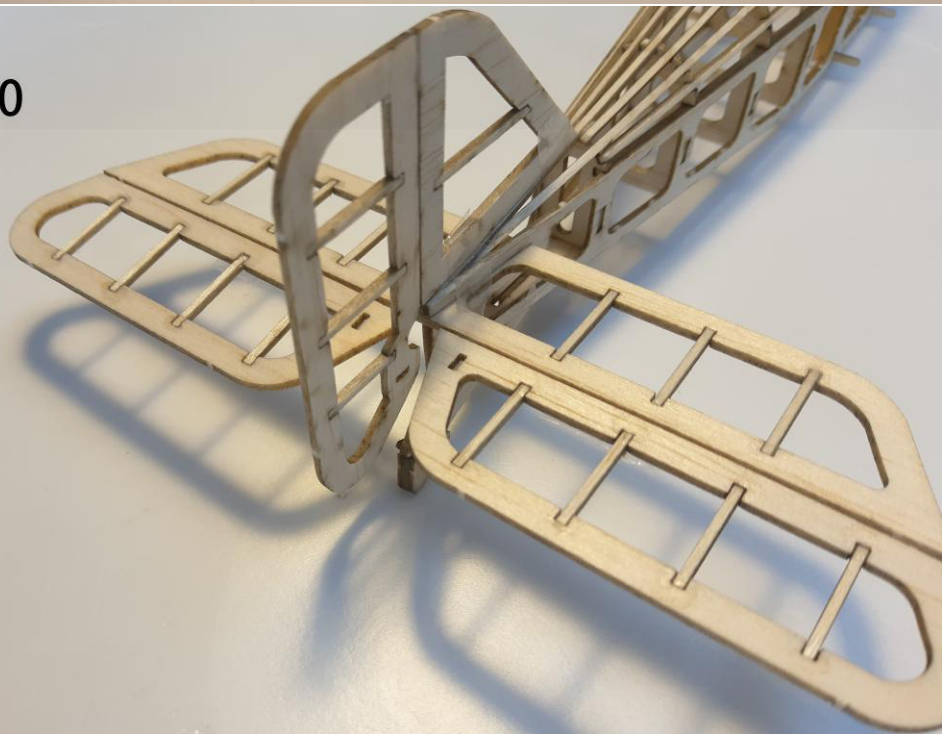

Step31

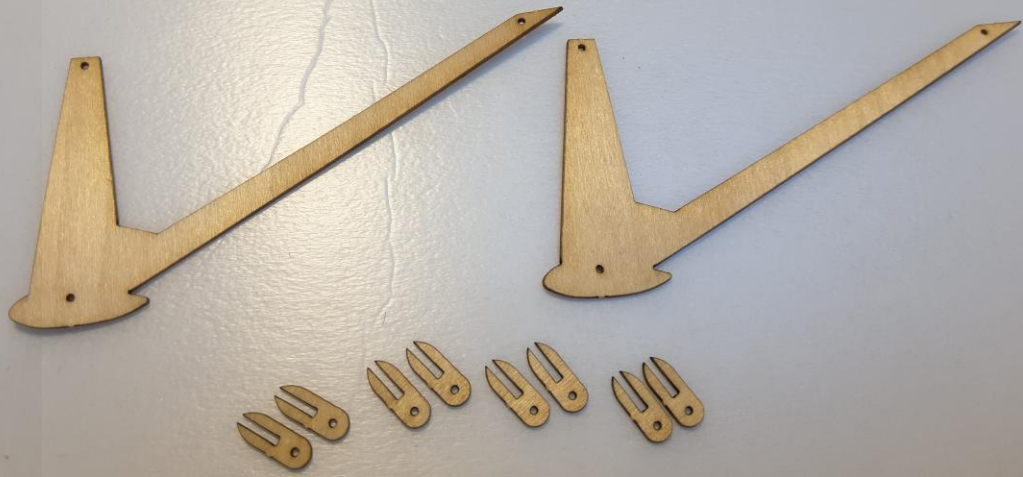

Step32



Step33

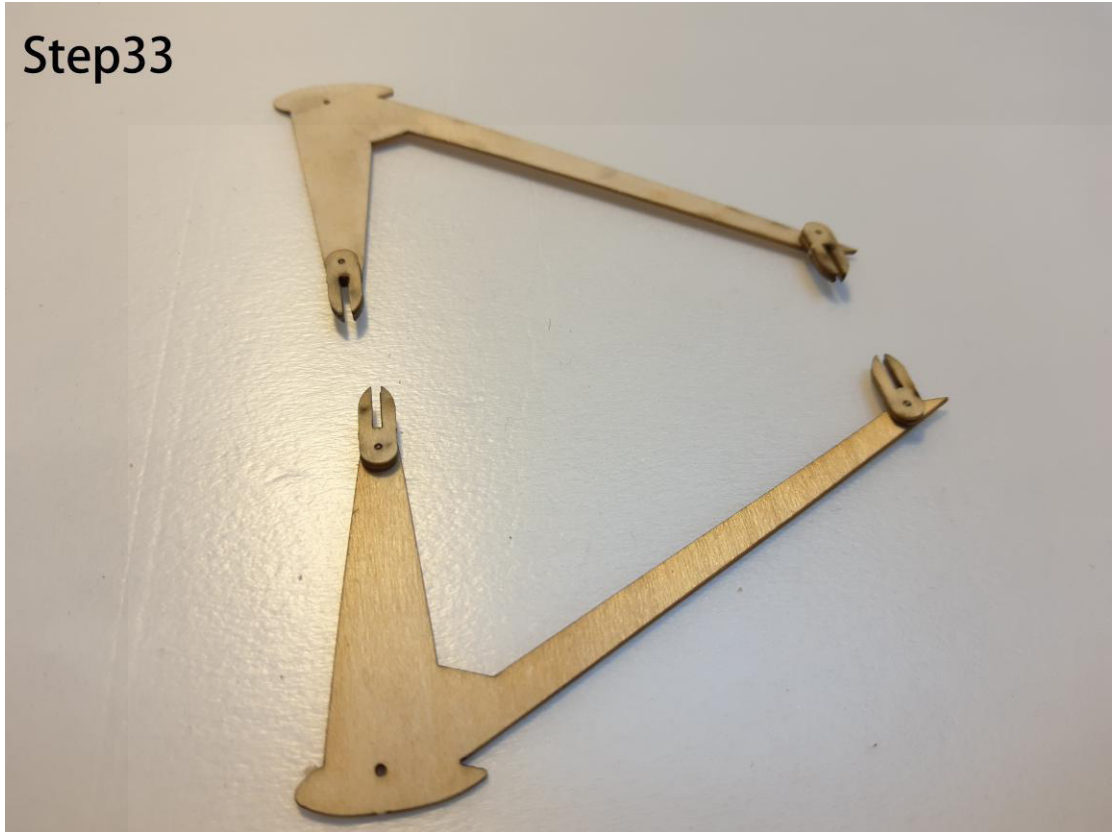

Step34

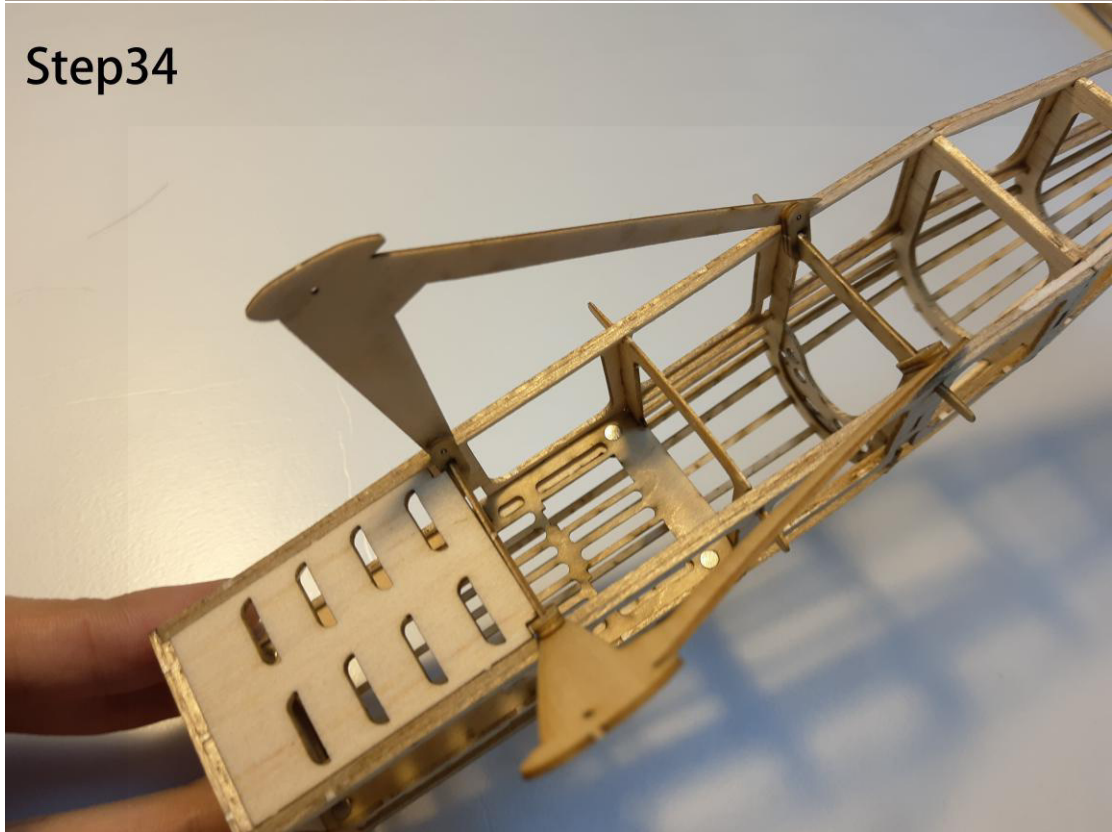

Step35



Step36



Step37



Step38

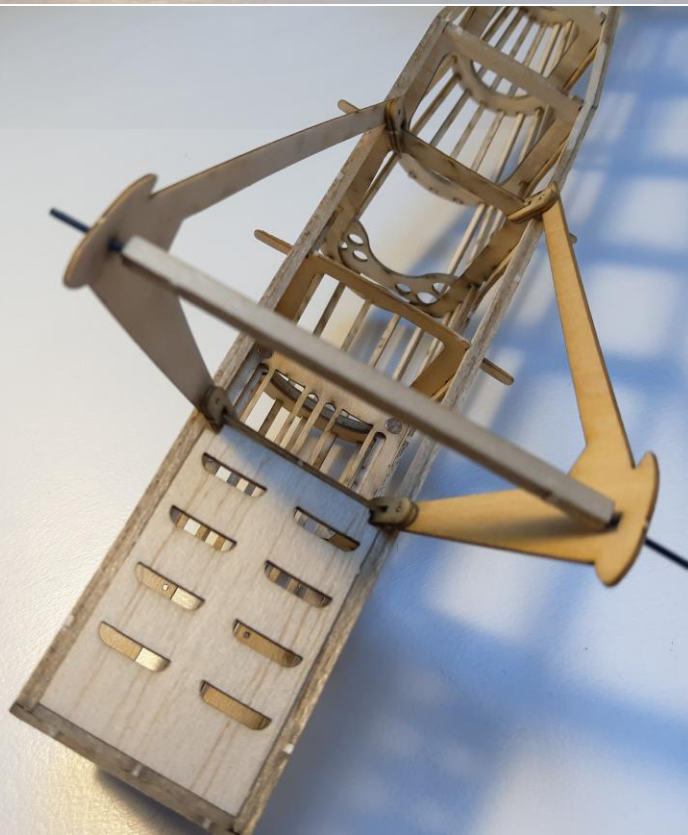

Step39

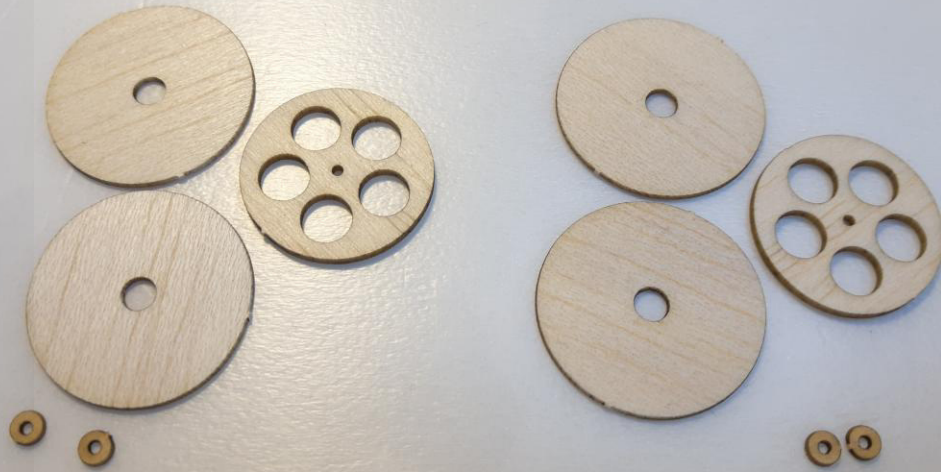

Step40

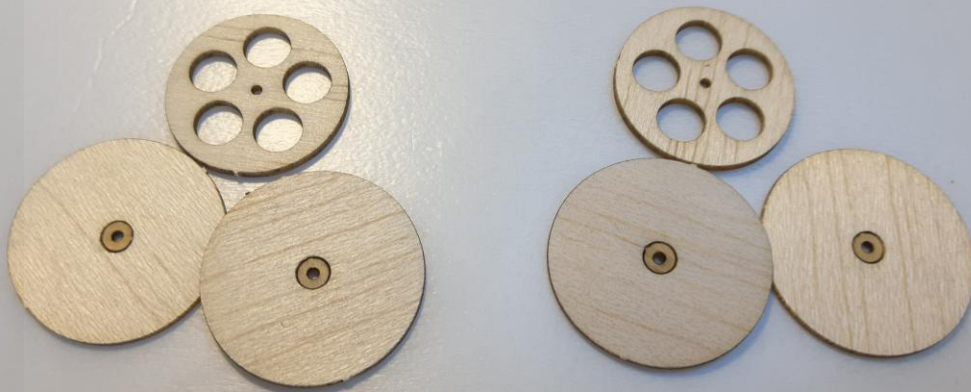

Step41



Step42



Step43



Step44



Teil 2: Flügel

Step1

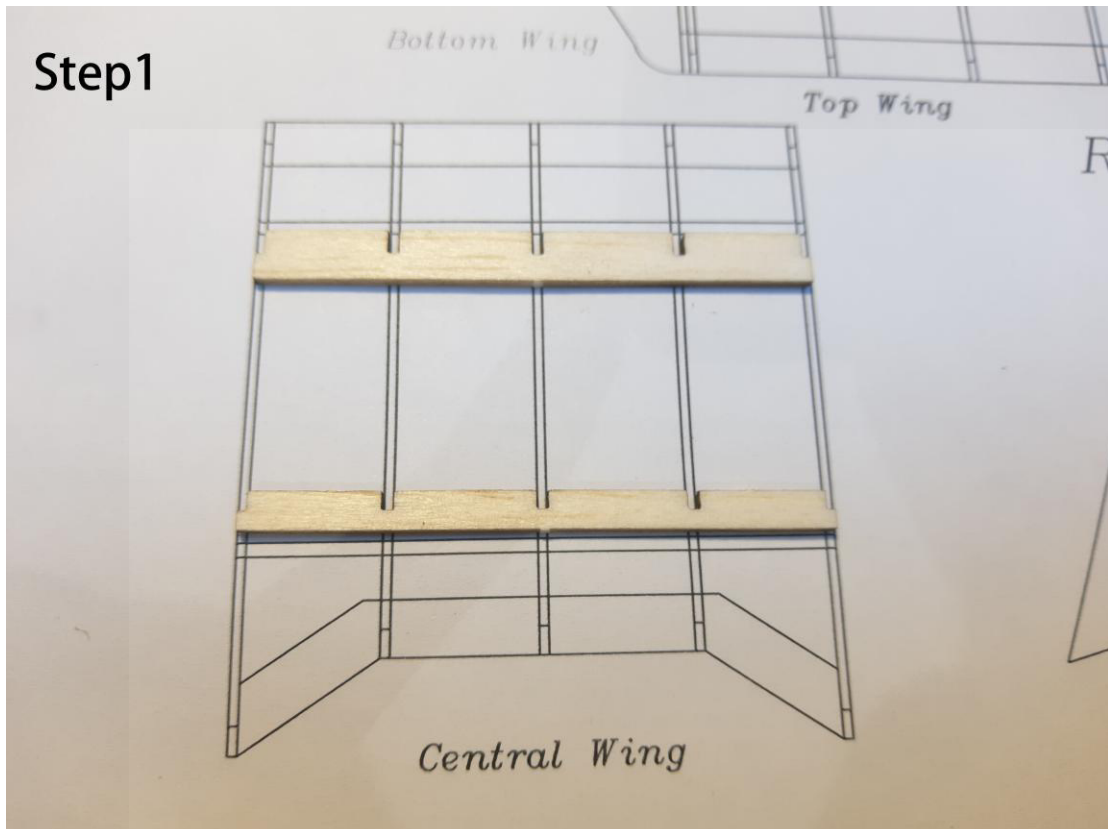

Step2

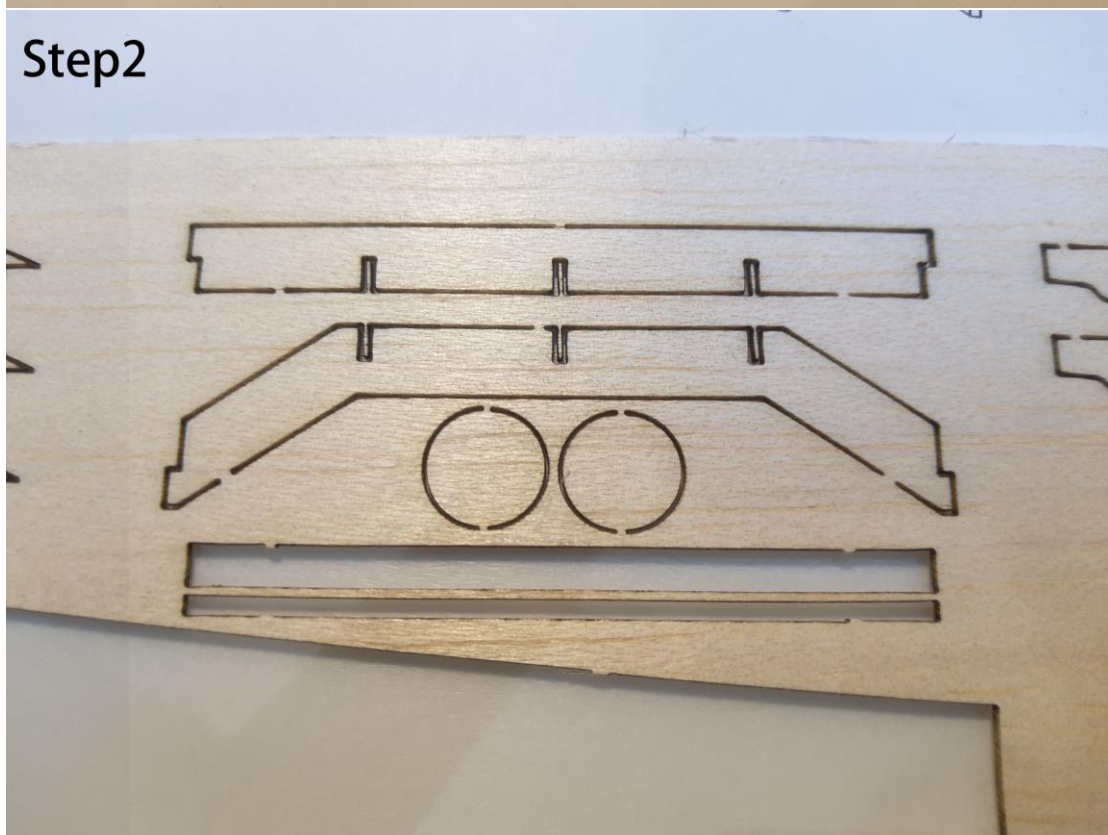

Step3

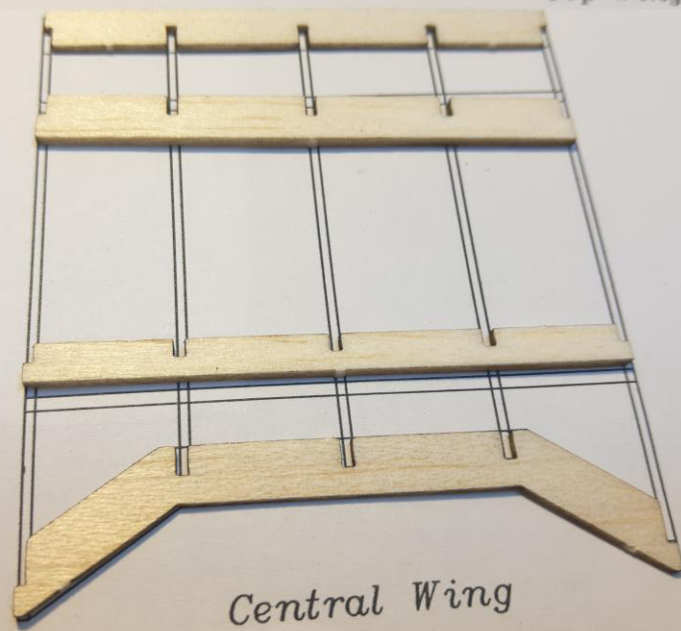

Step4

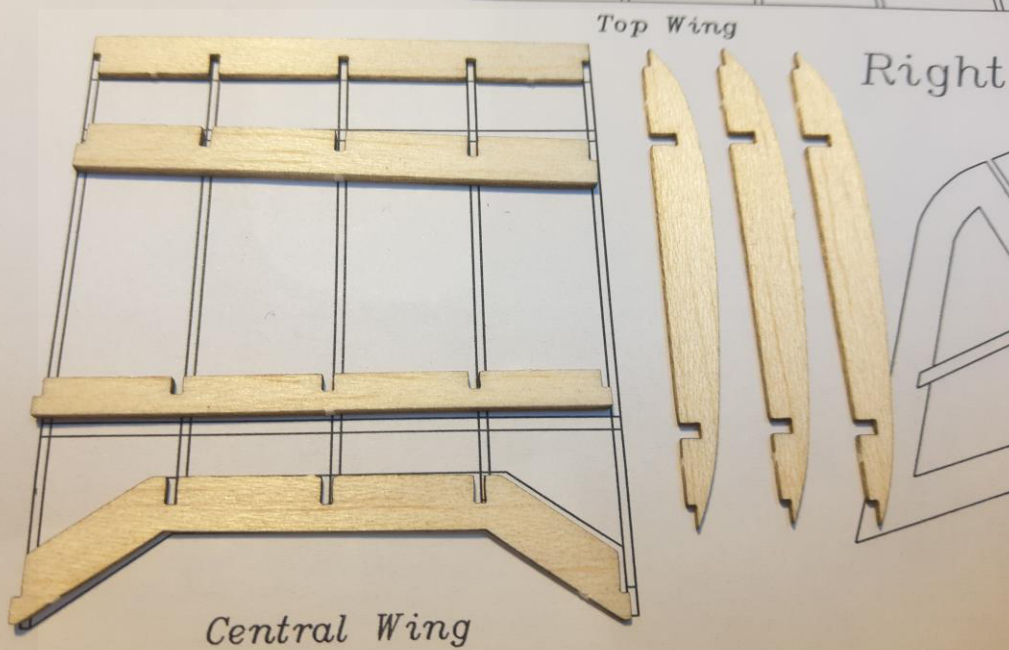

Step5

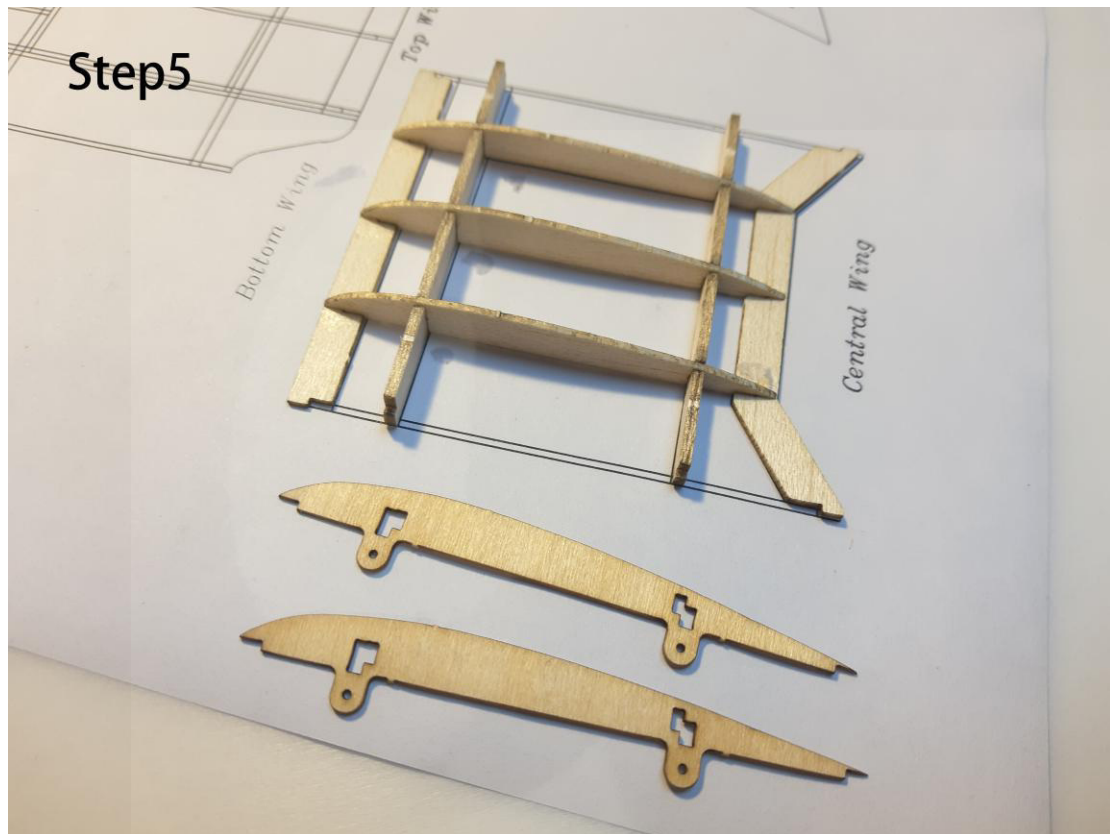

Step6

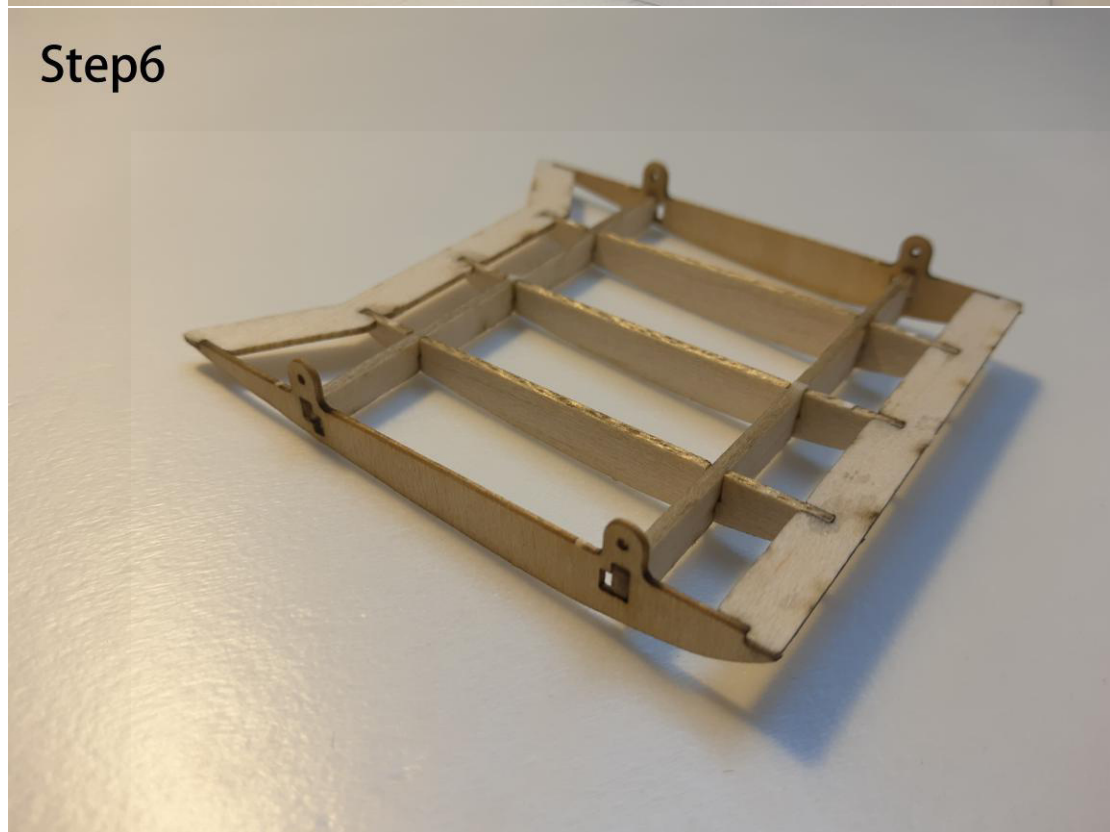

Step7



Step8

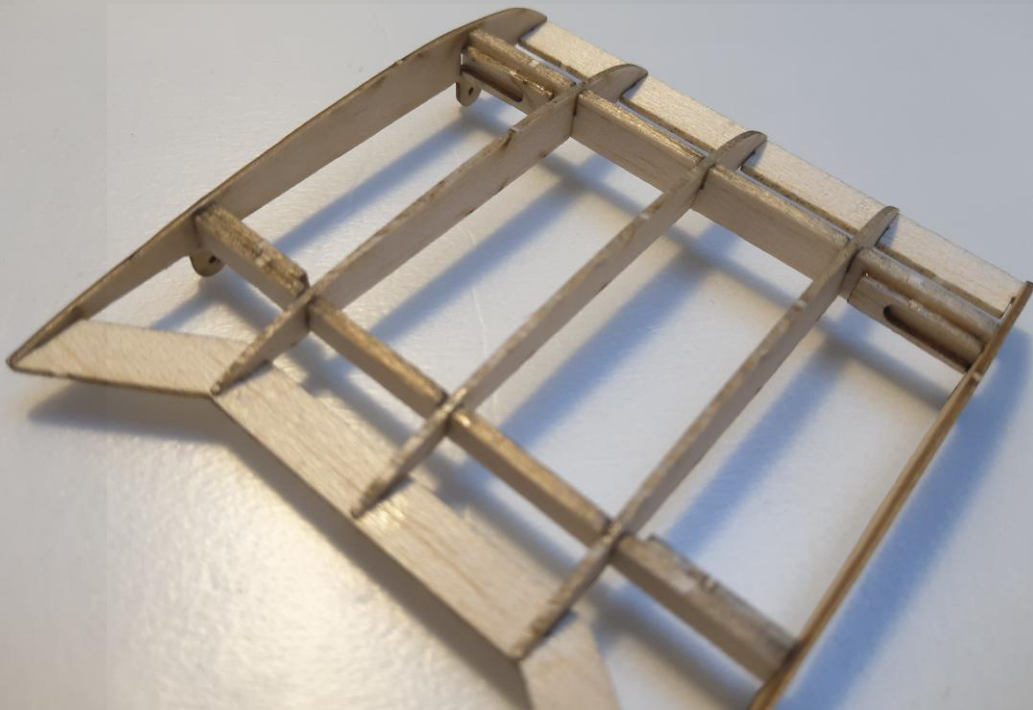

Step9

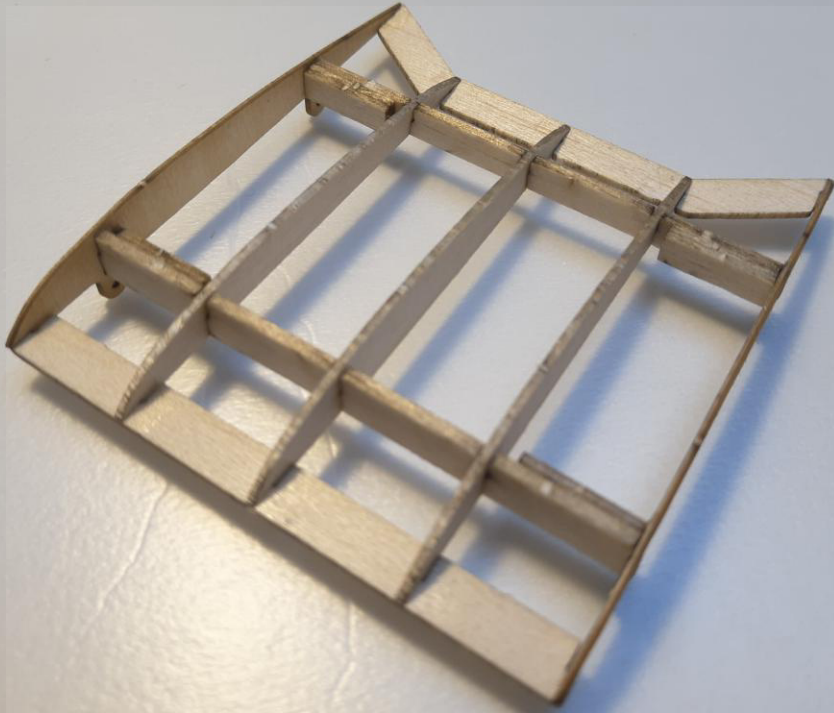

Step10

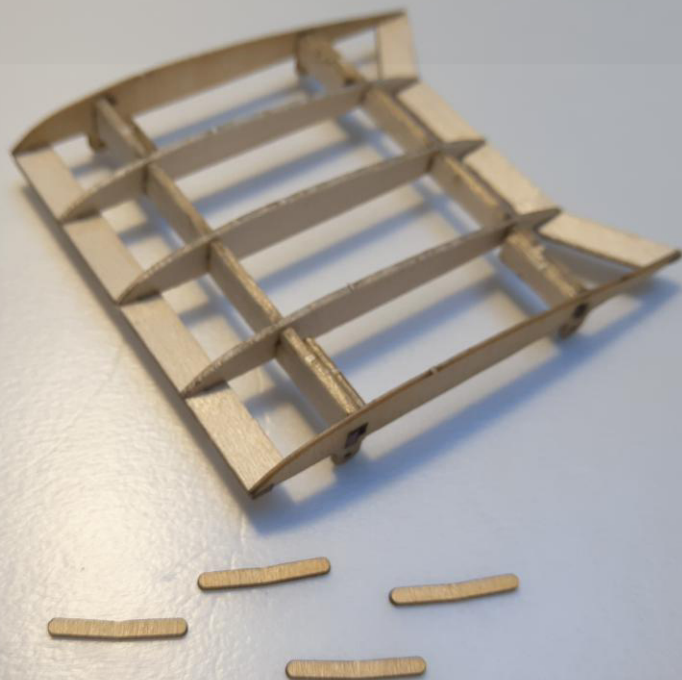

Step11

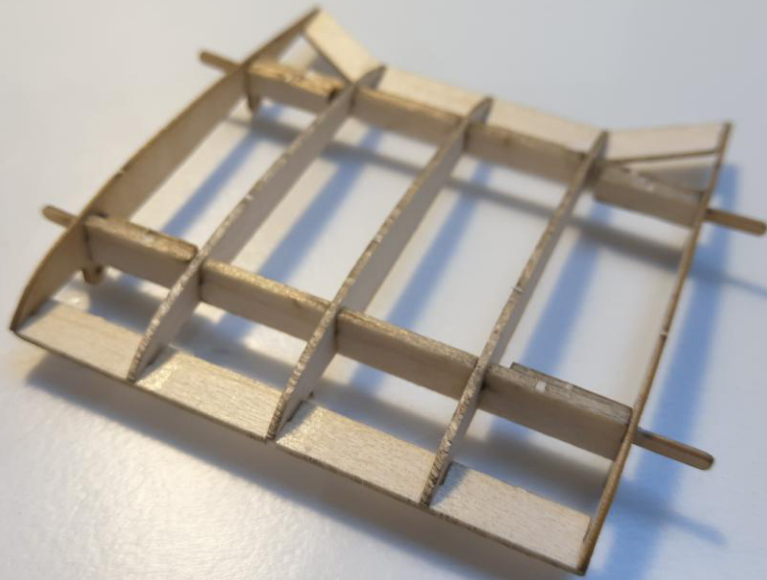

Step12

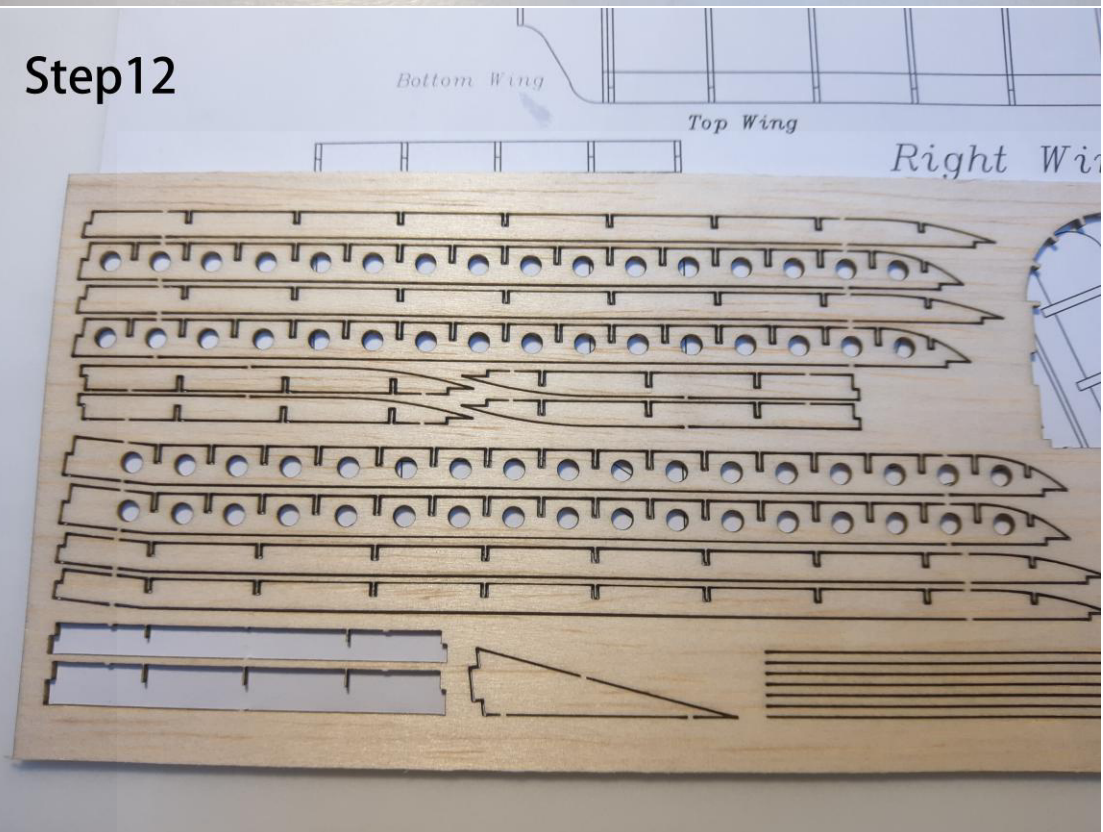

Step13

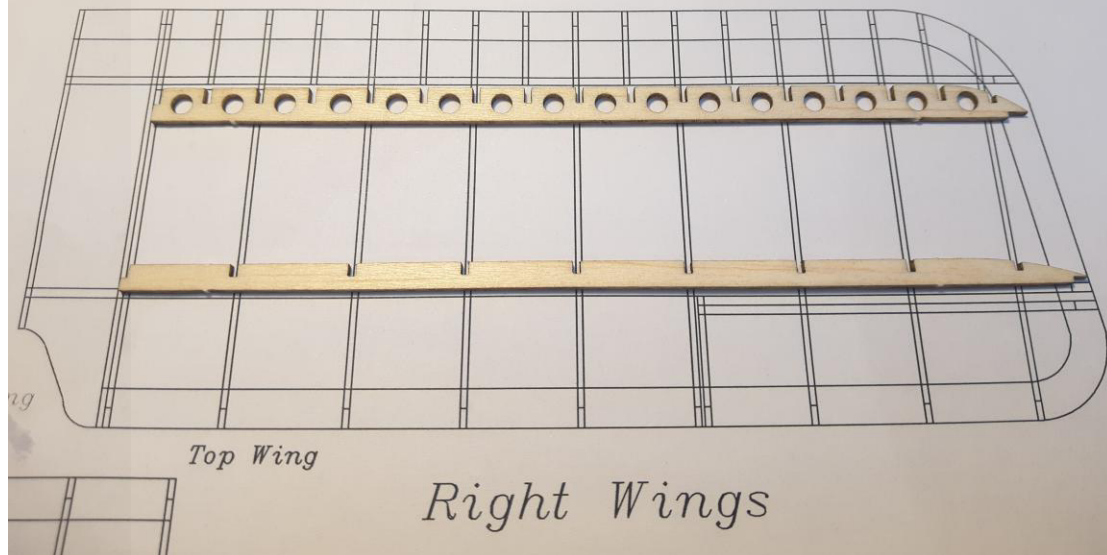

Step14

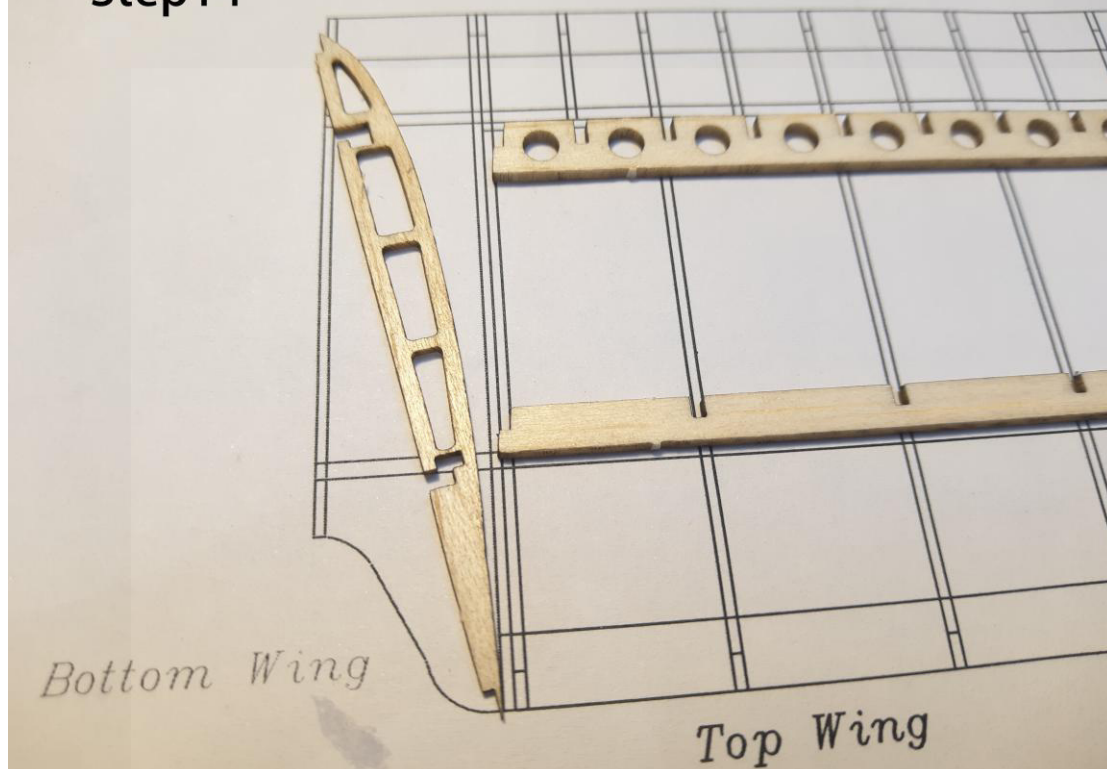

Step15

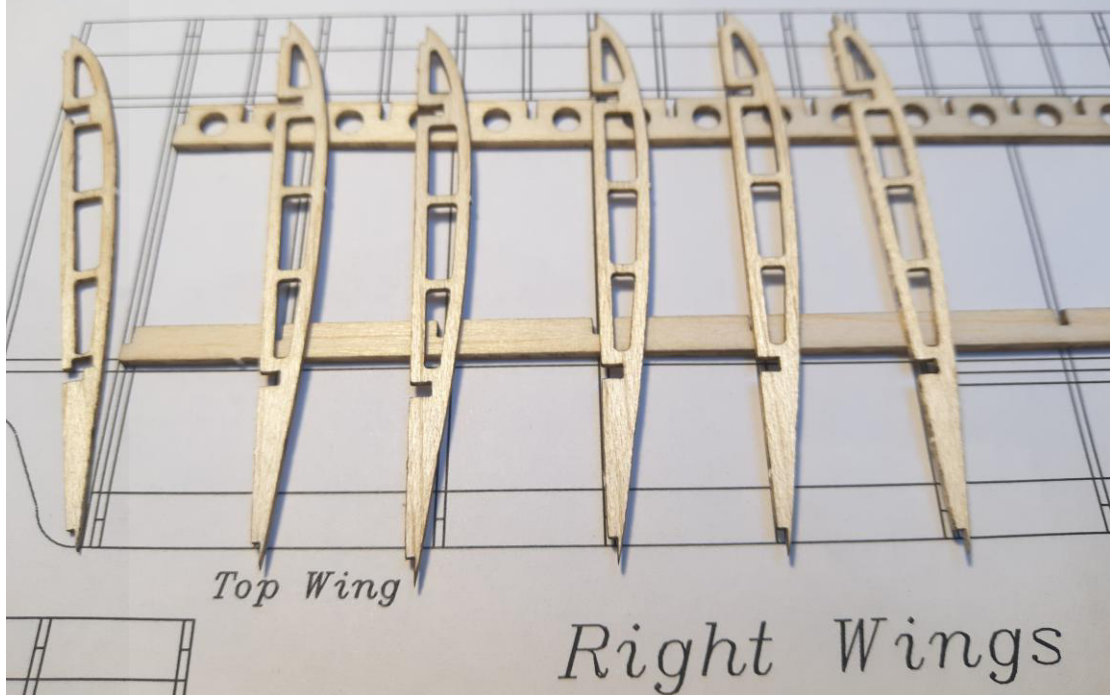

Step16

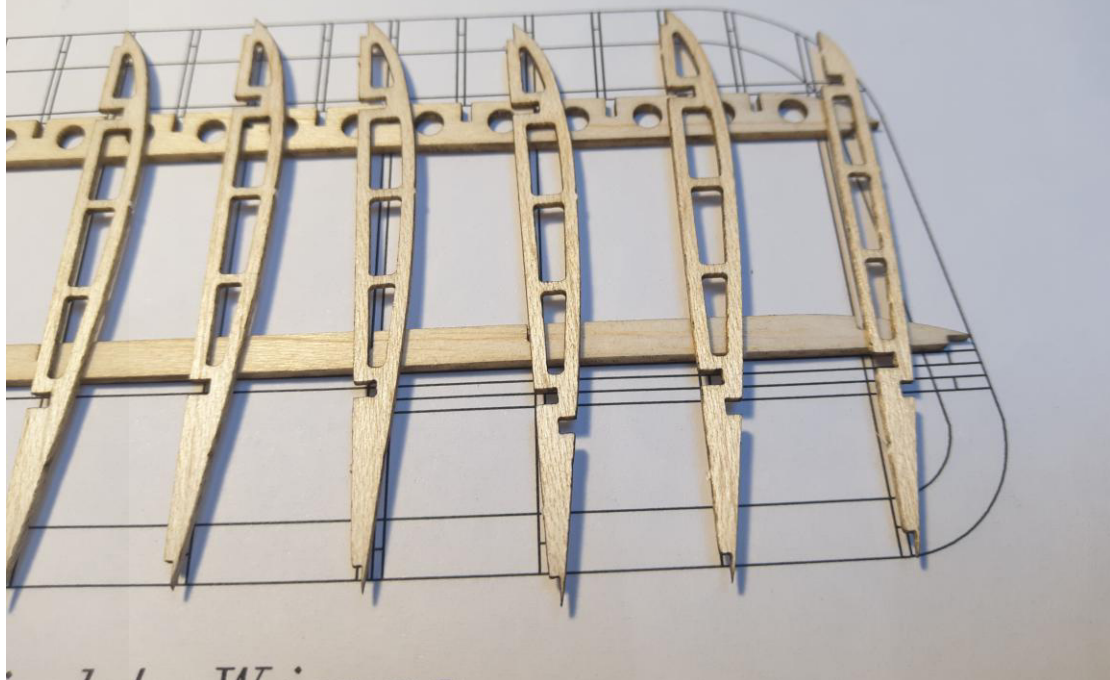

Step17

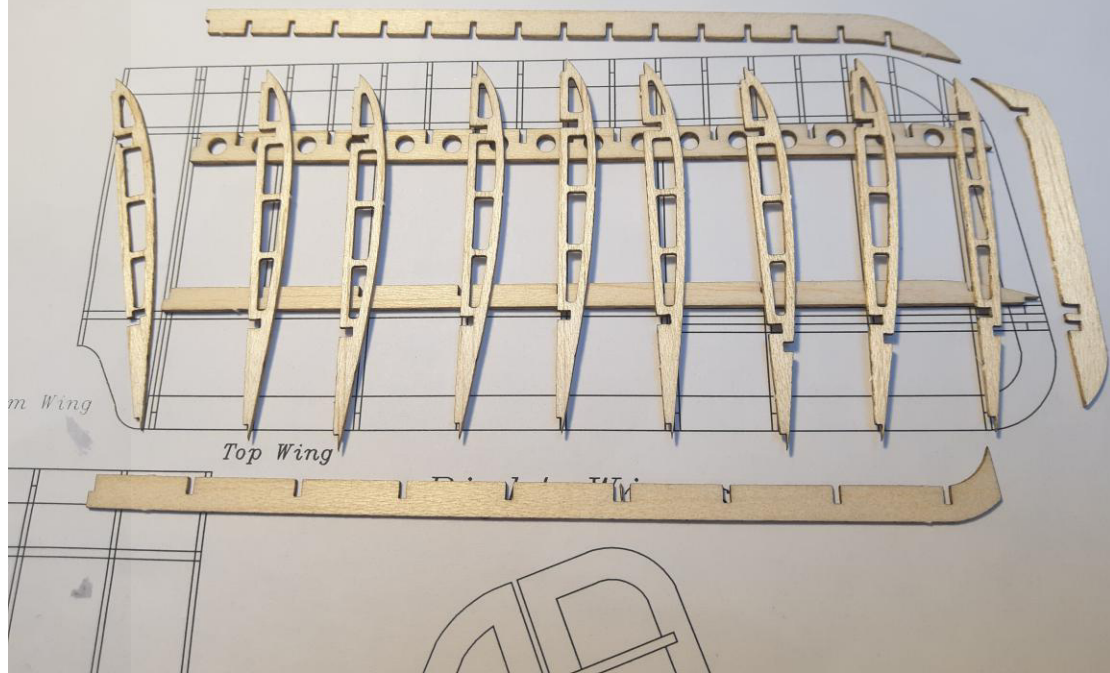

Step18

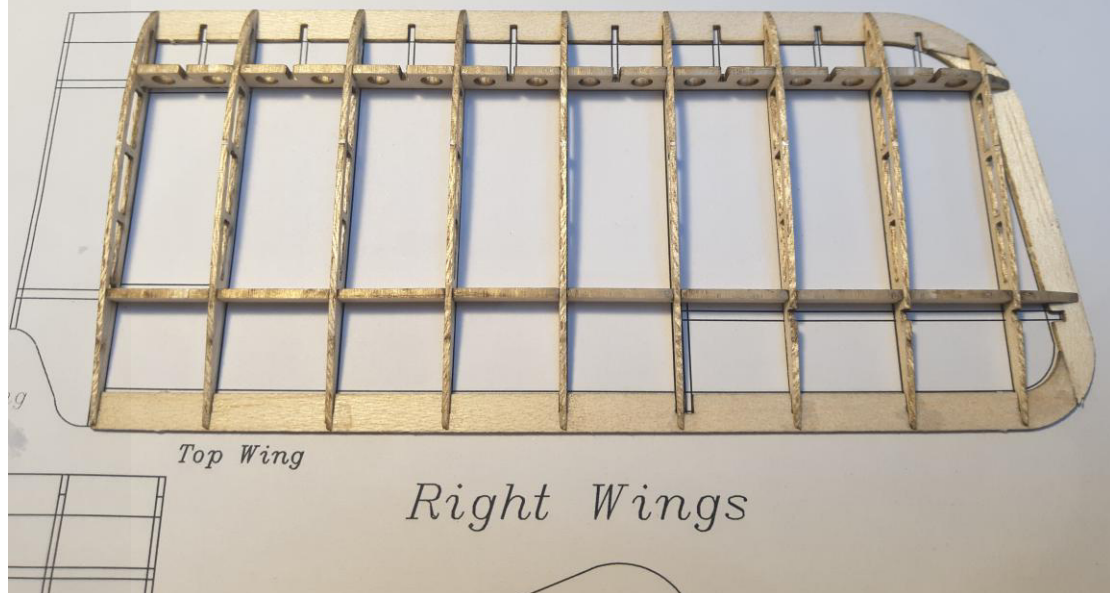

Step19

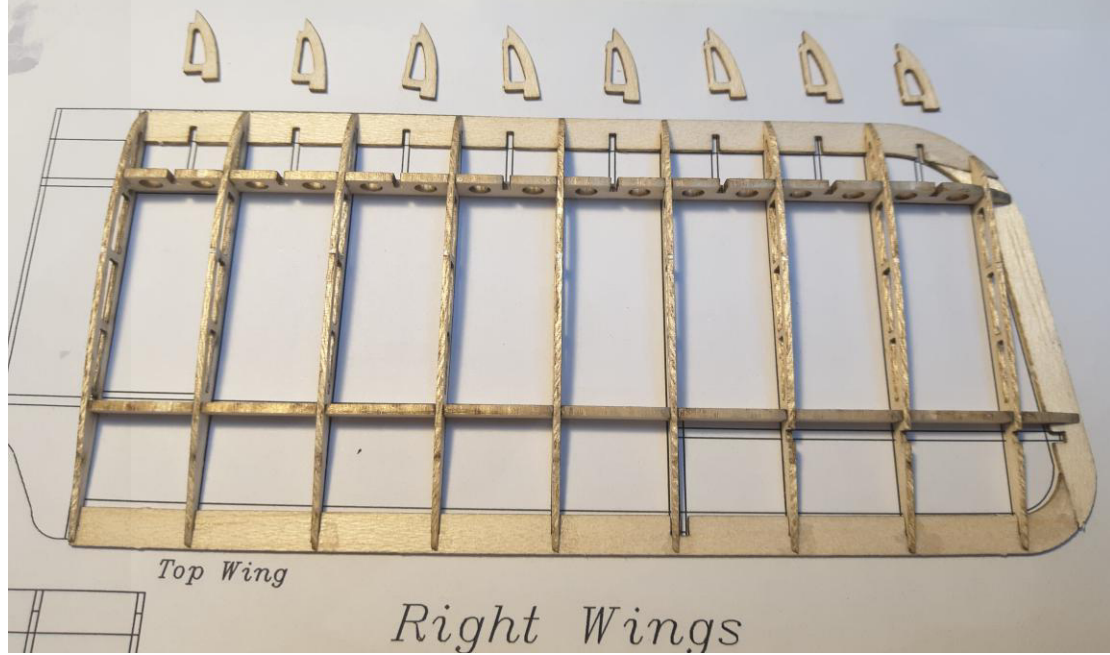

Step20

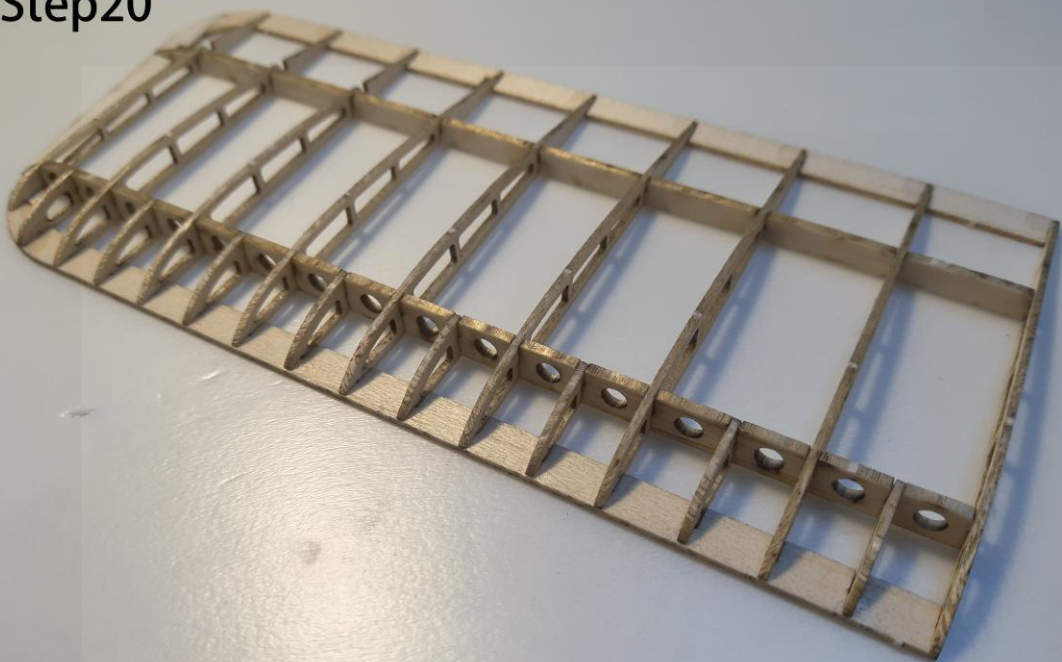

Step21

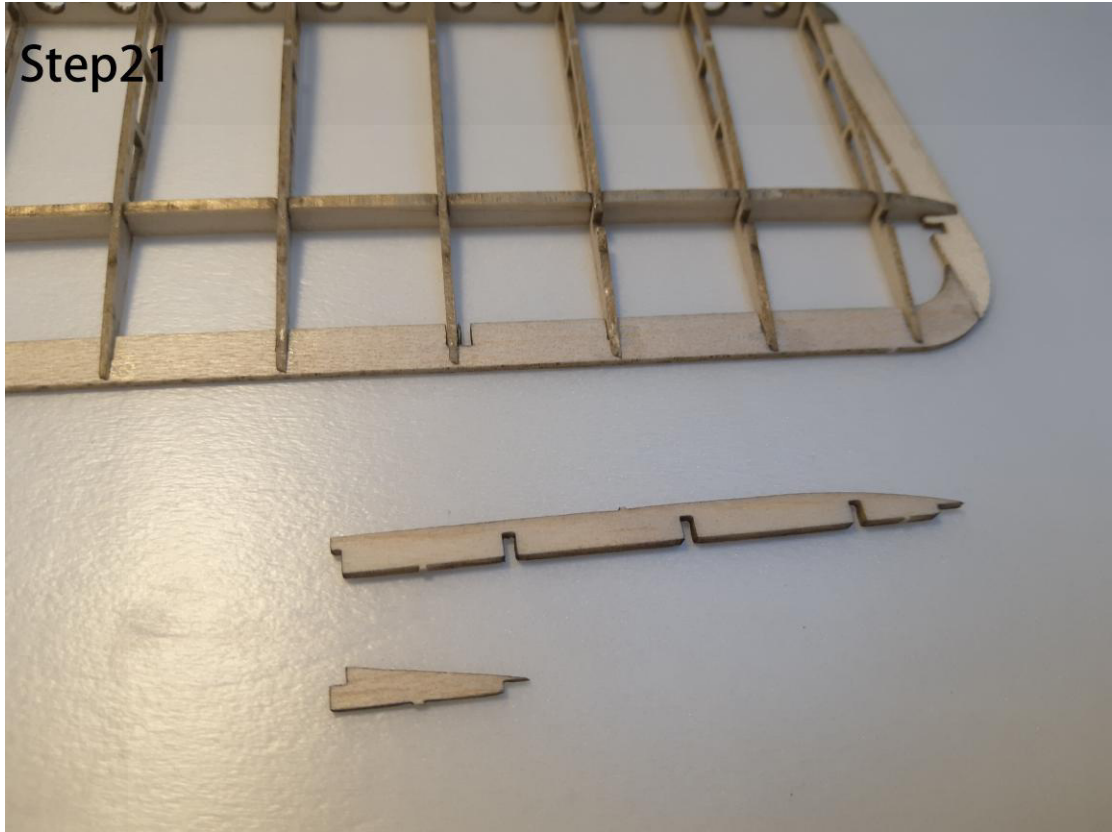

Step22

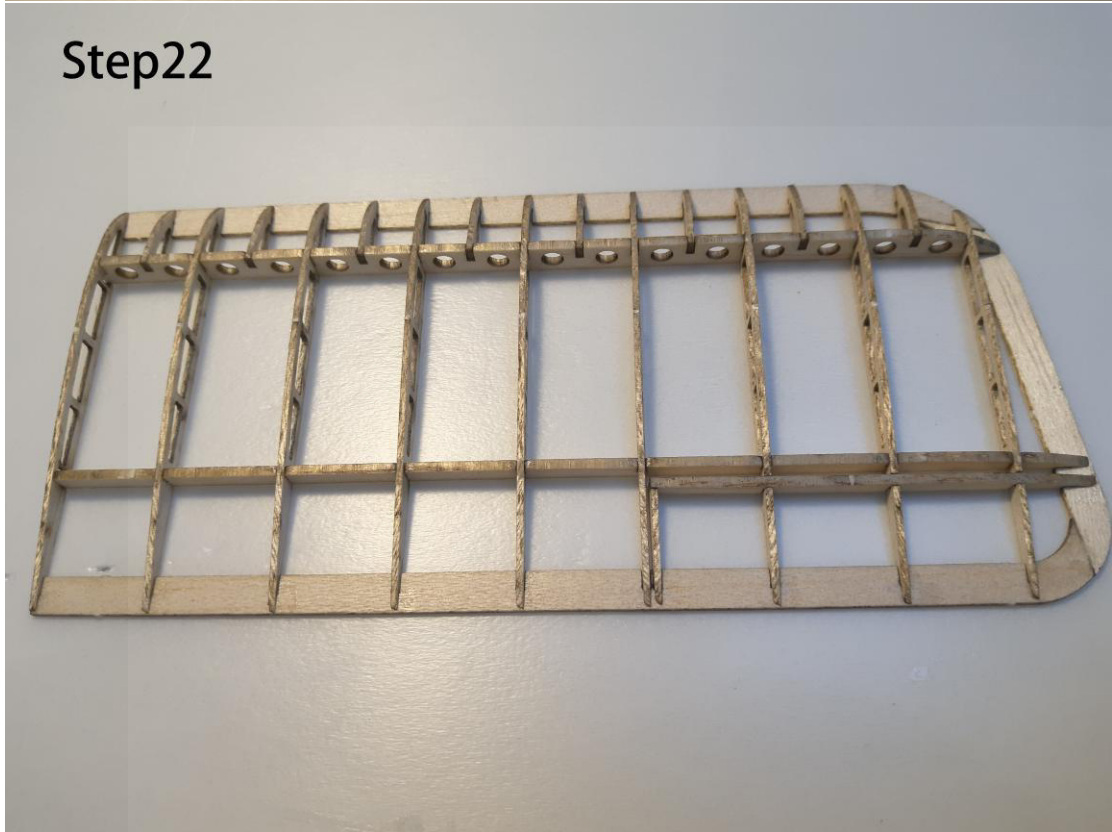

Step23

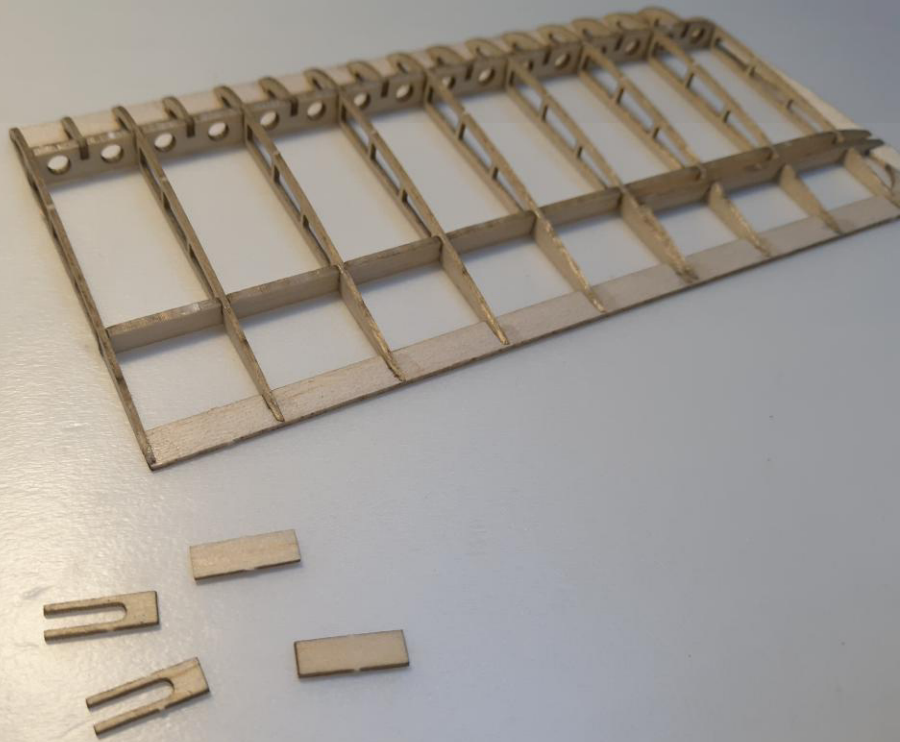

Step24

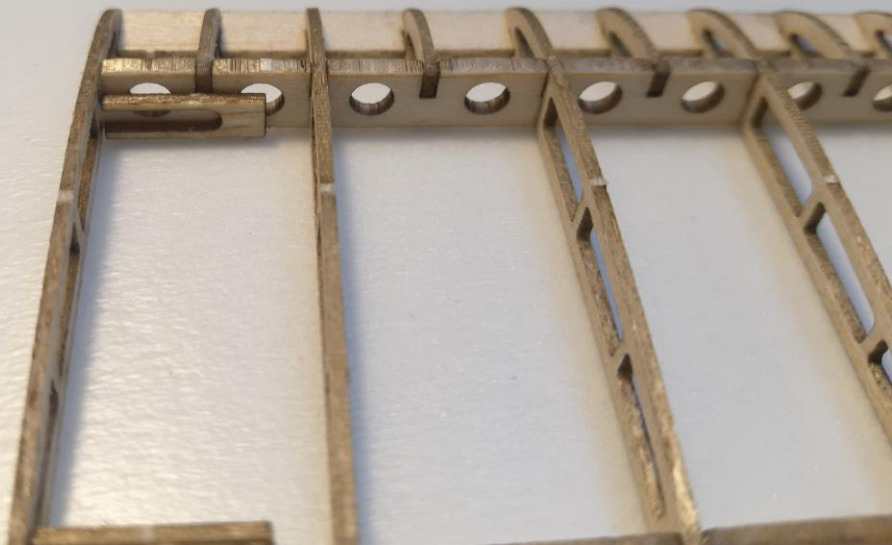

Step25

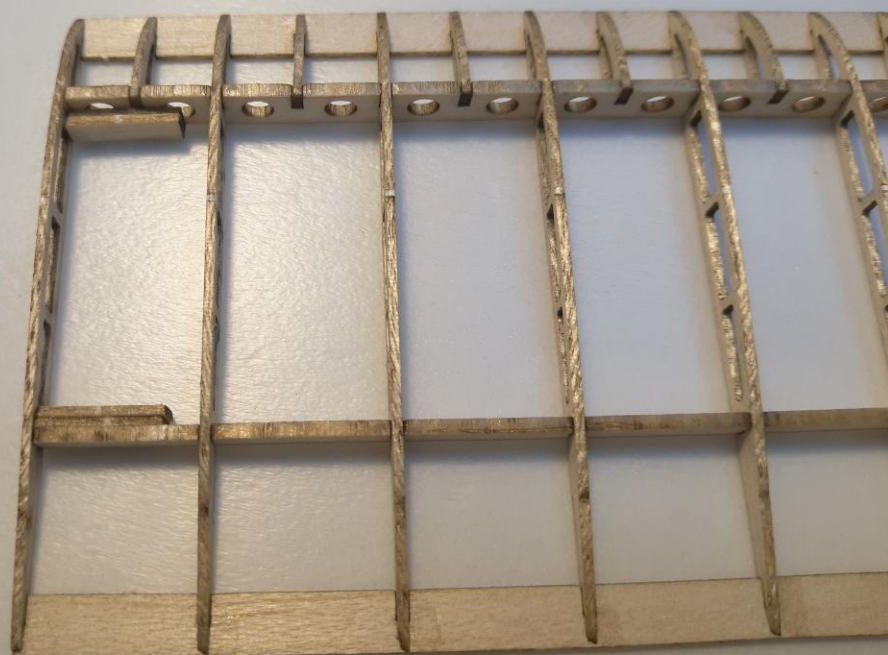

Step26

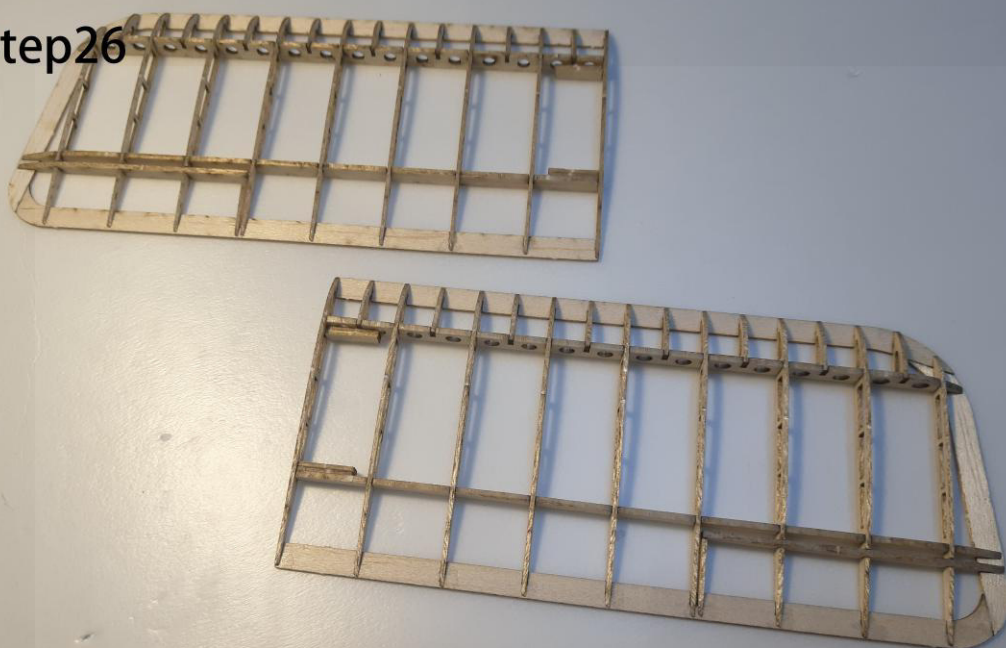

Step27

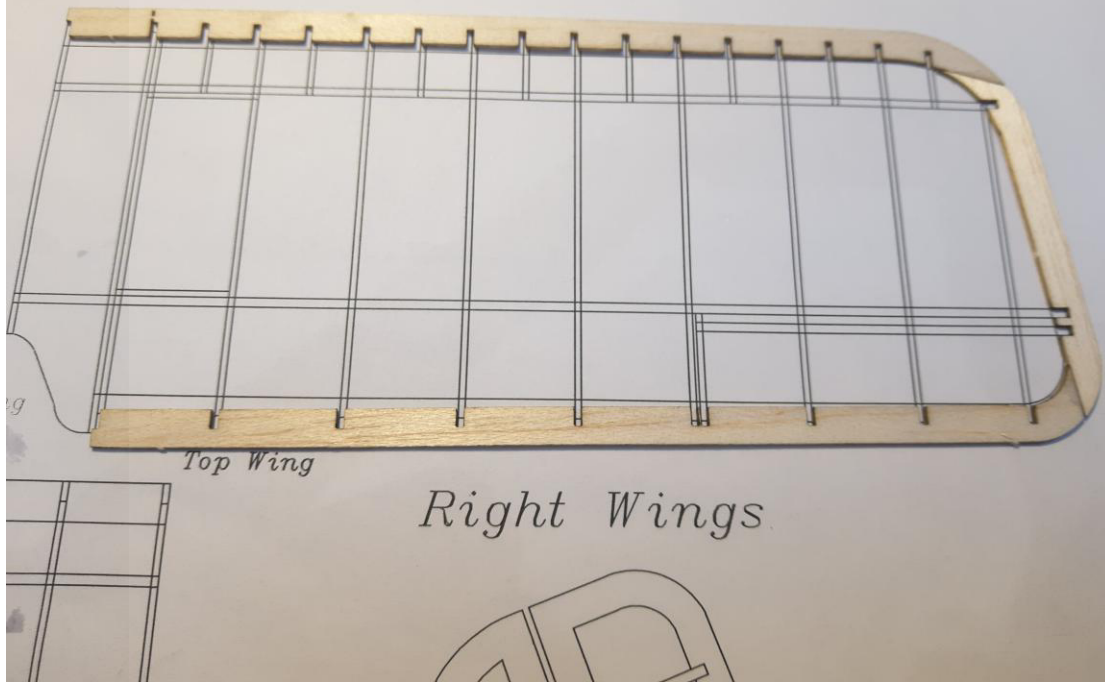

Step28

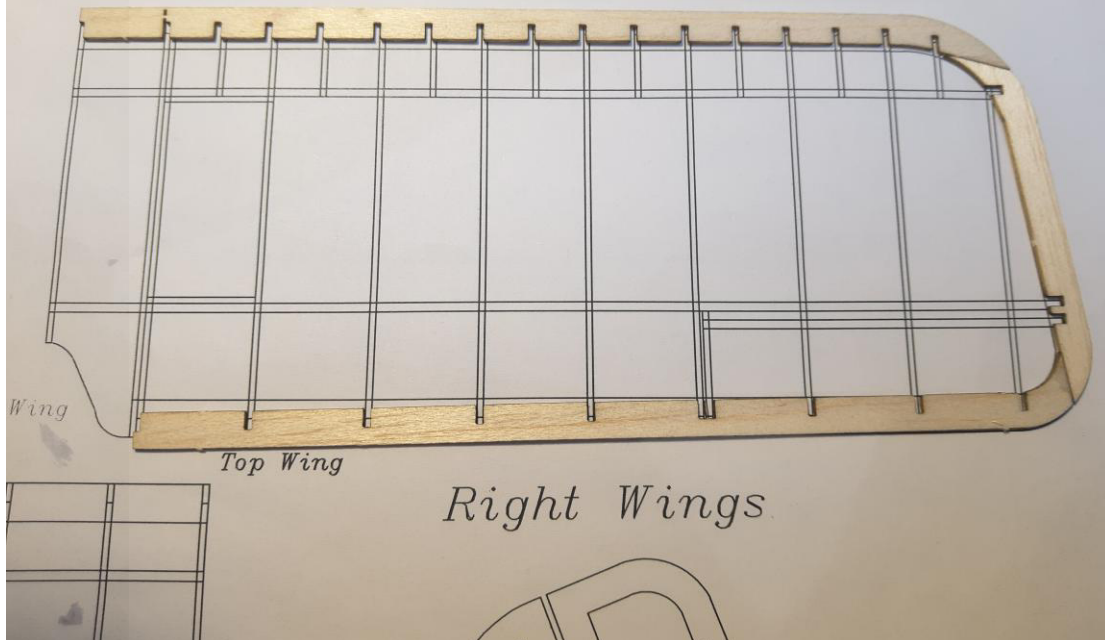

Step29

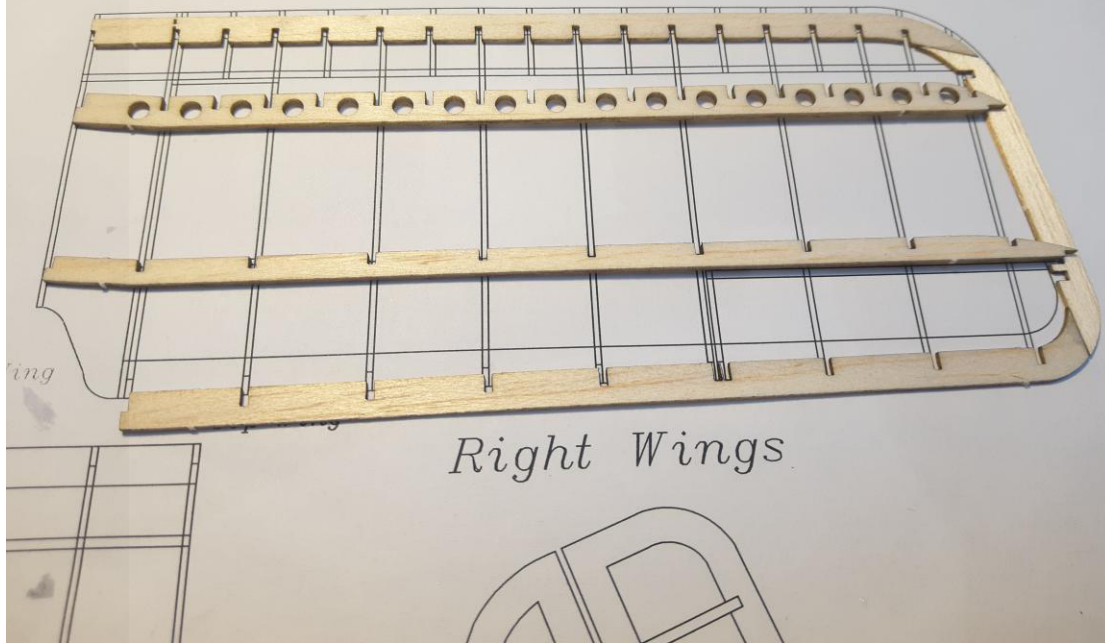

Right Wings

Step30

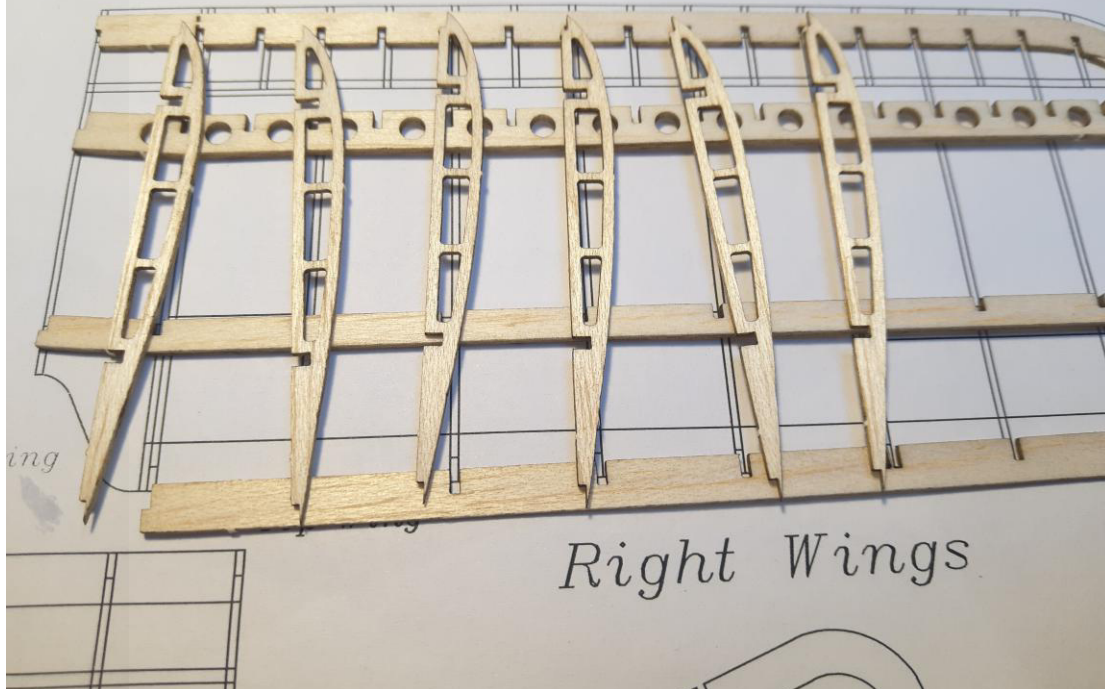

Right Wings

Step31

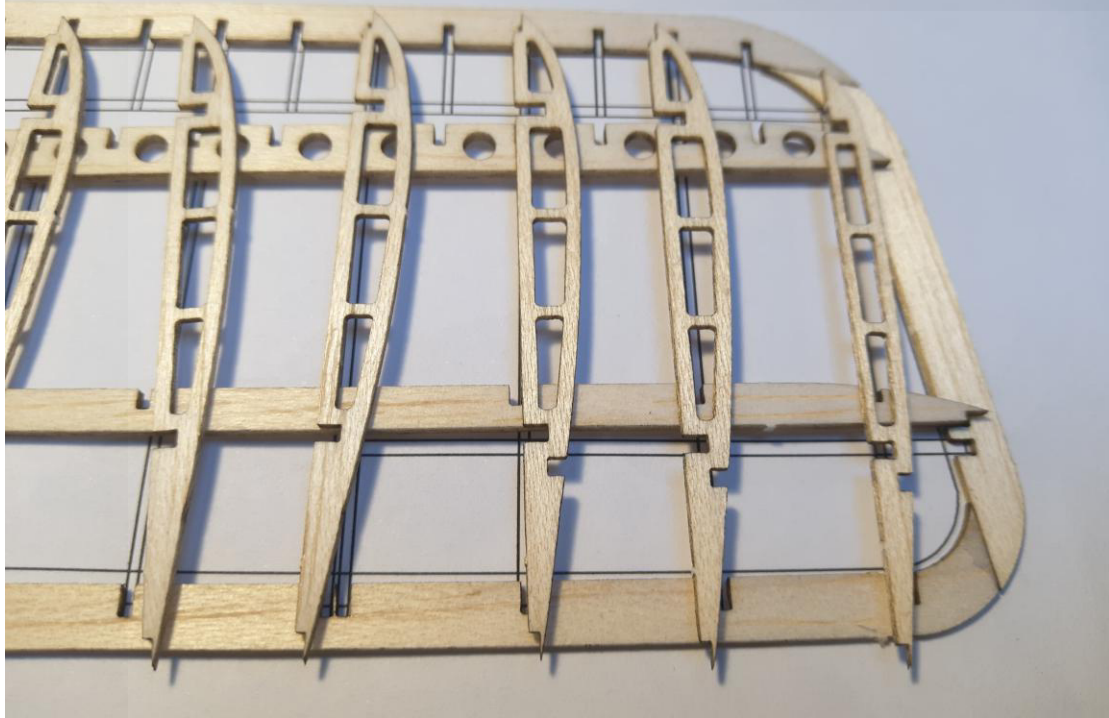

Step32

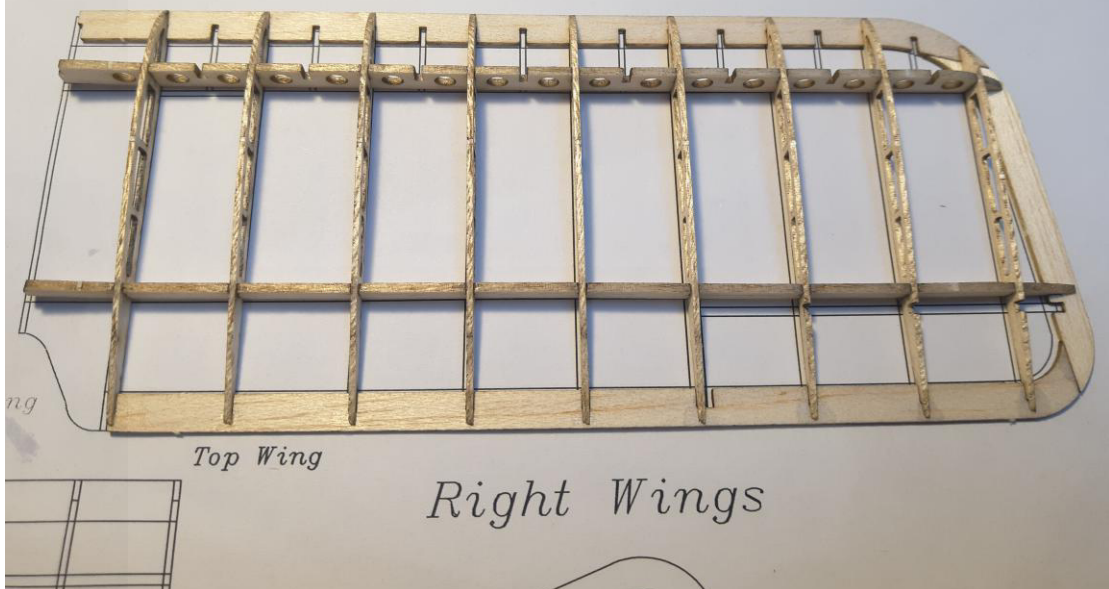

Step33

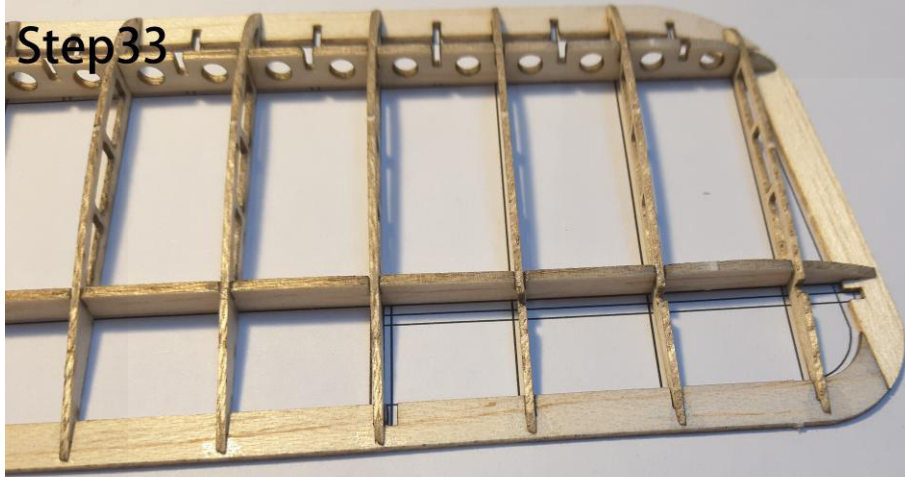

Right Wings

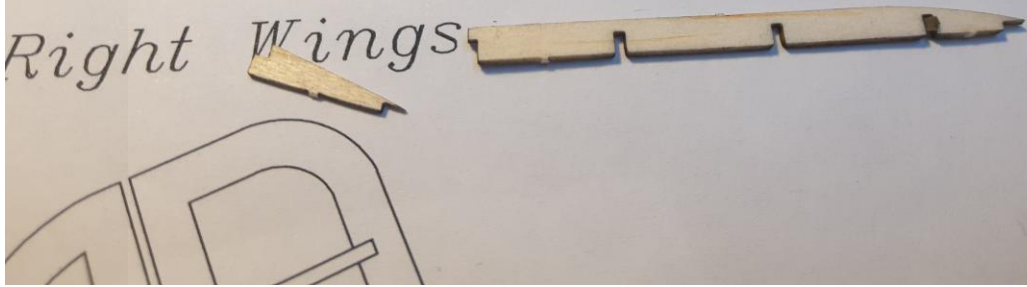

Step34

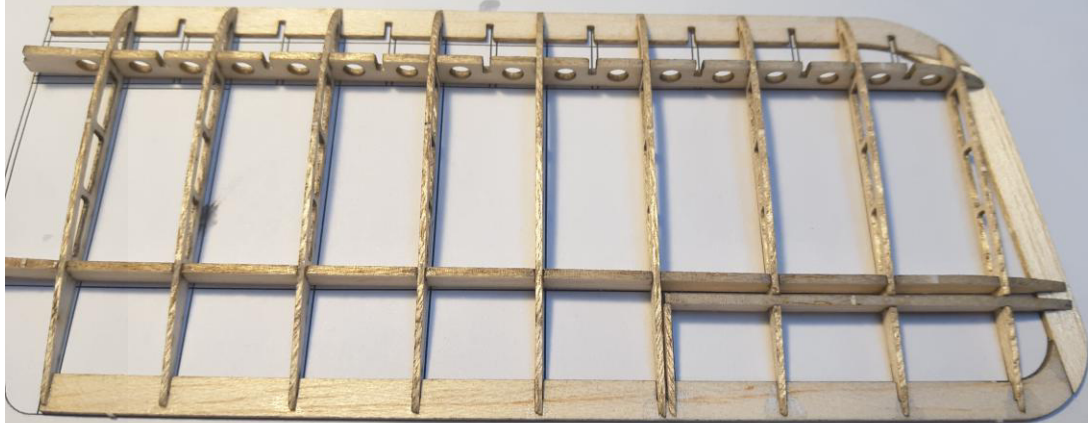

Top Wing

Right Wings

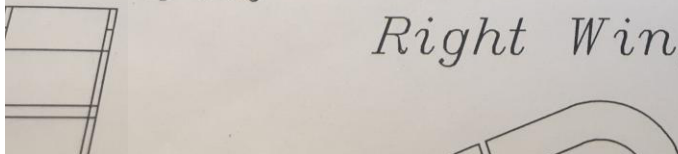

Step35

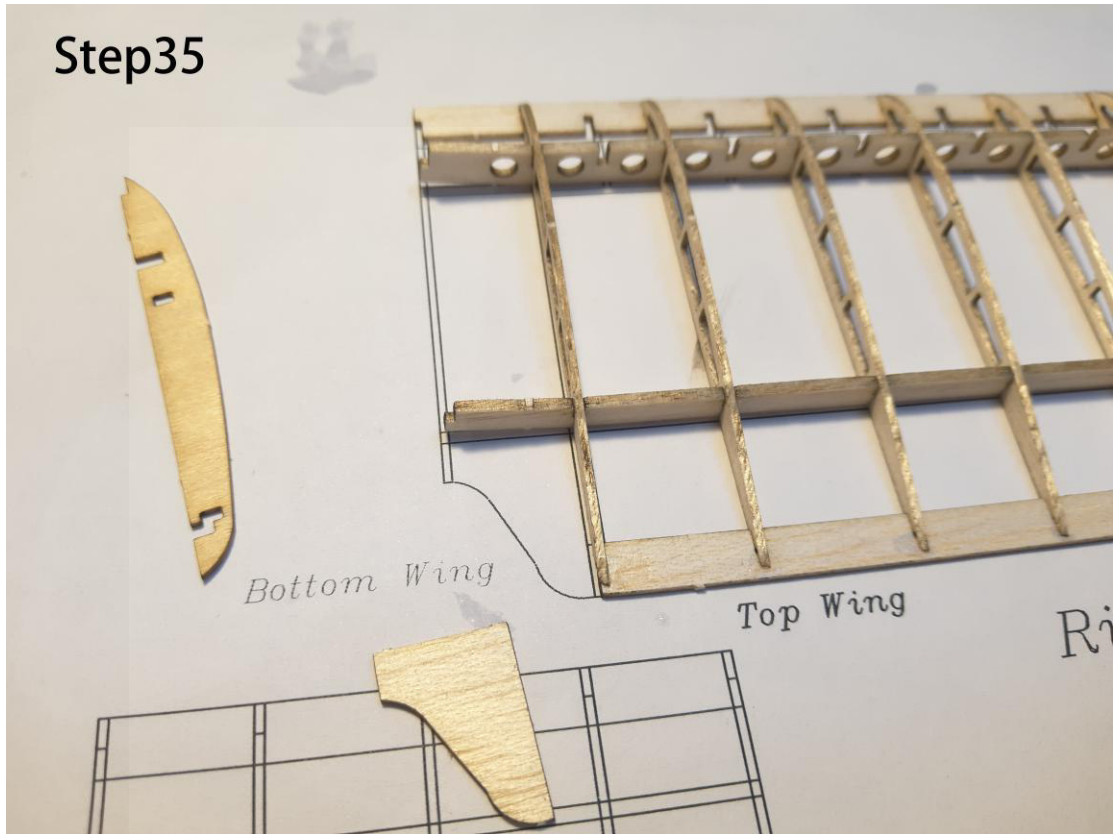

Step36

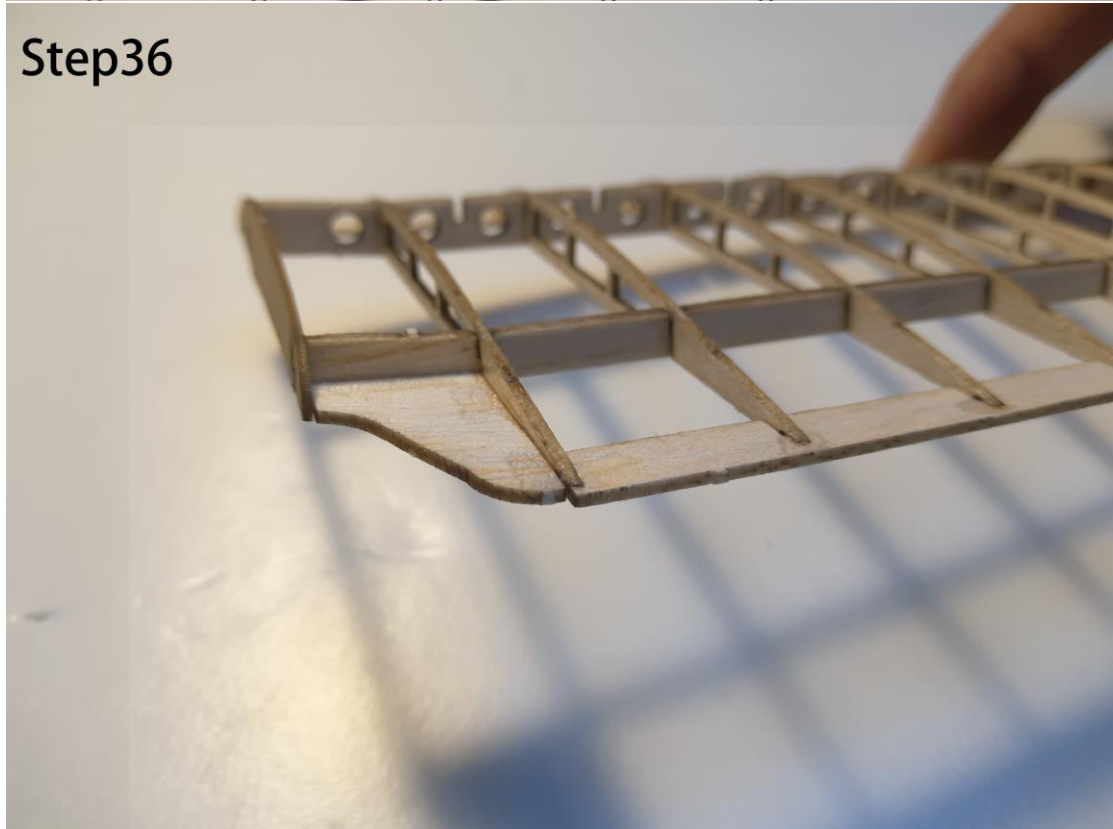

Step37

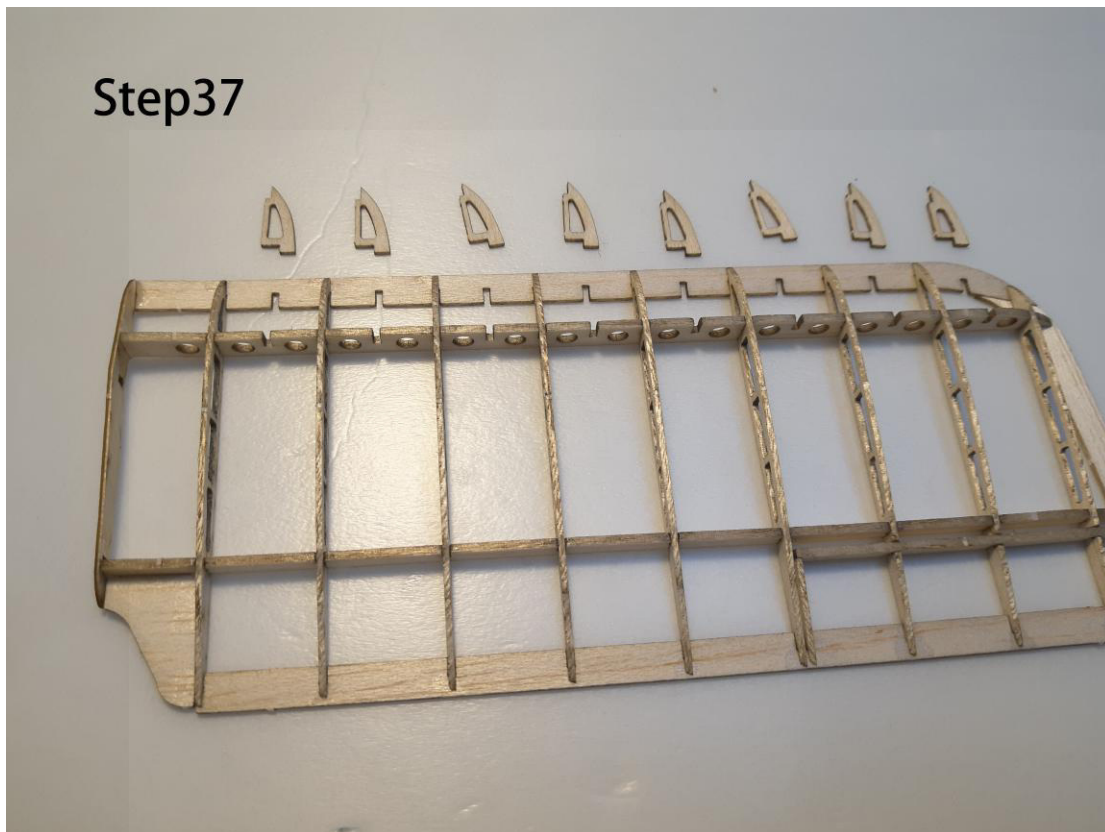

Step38



Step39

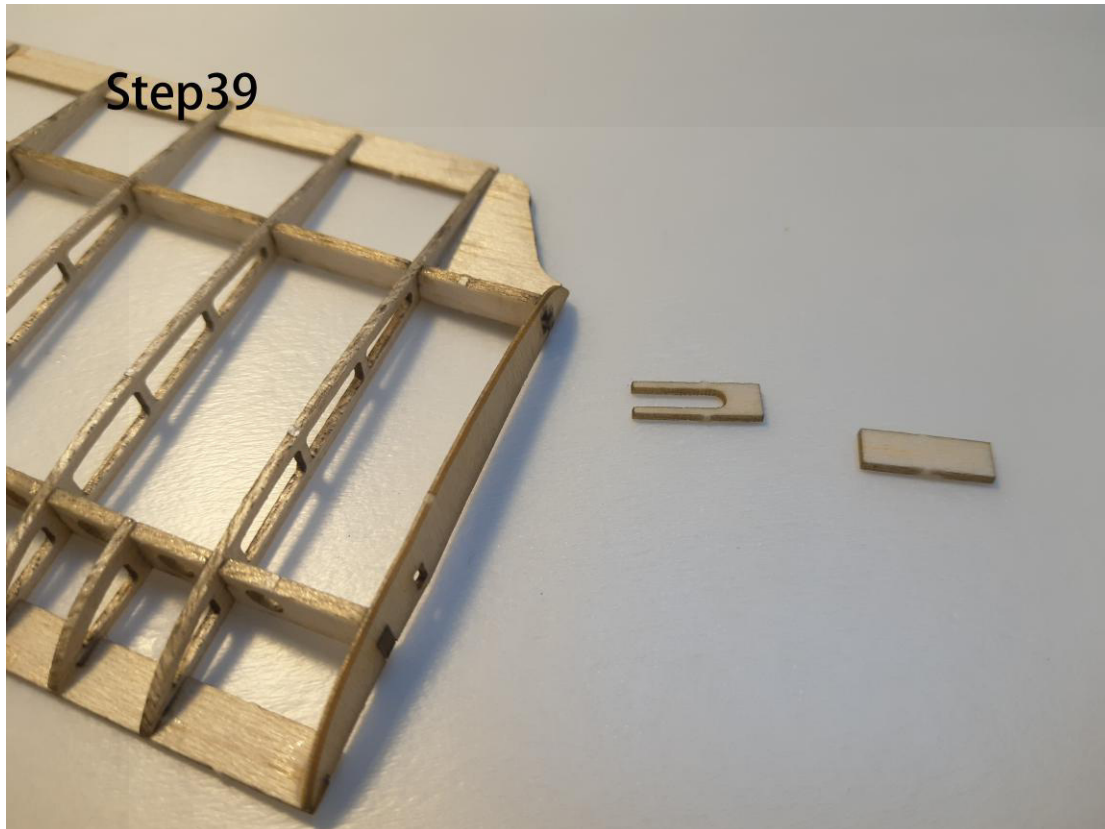

Step40

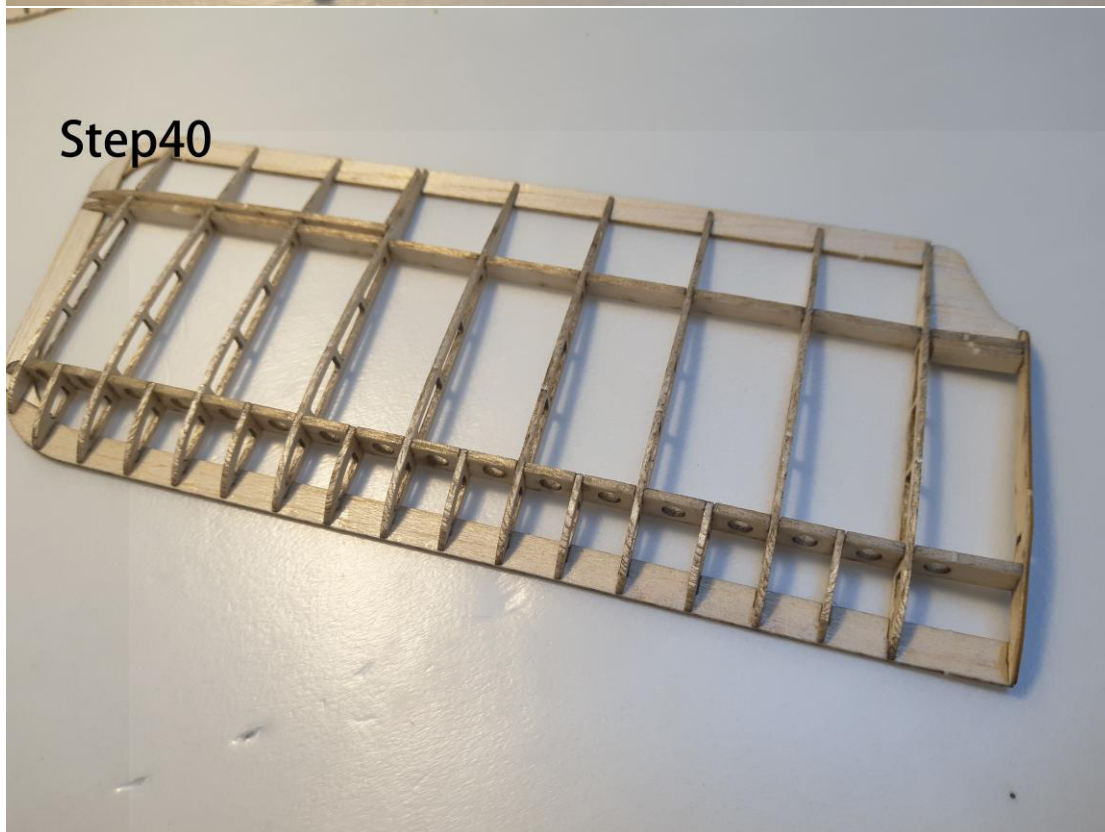

Step41

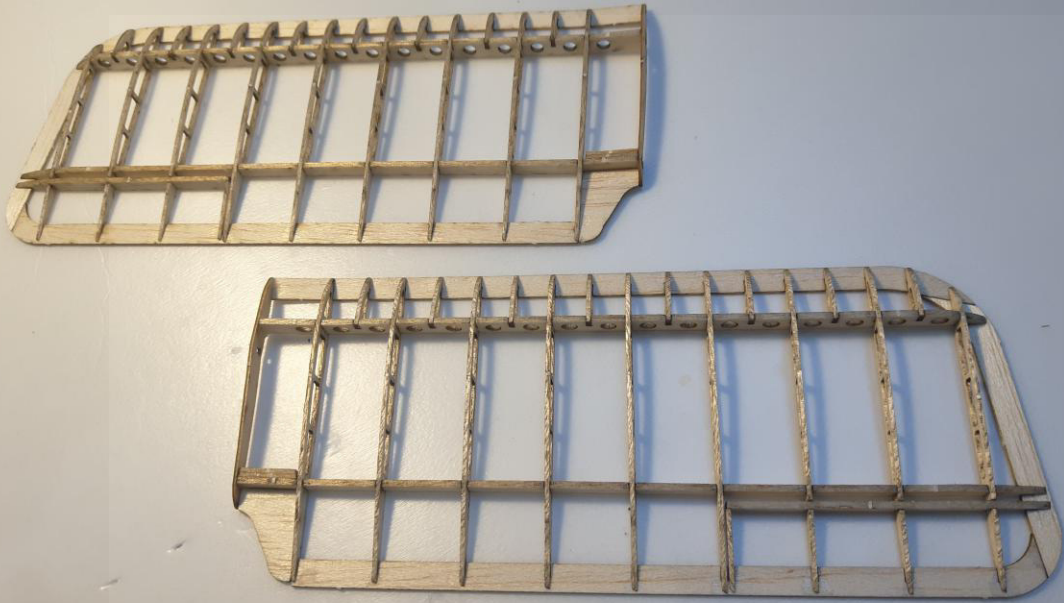

Step42

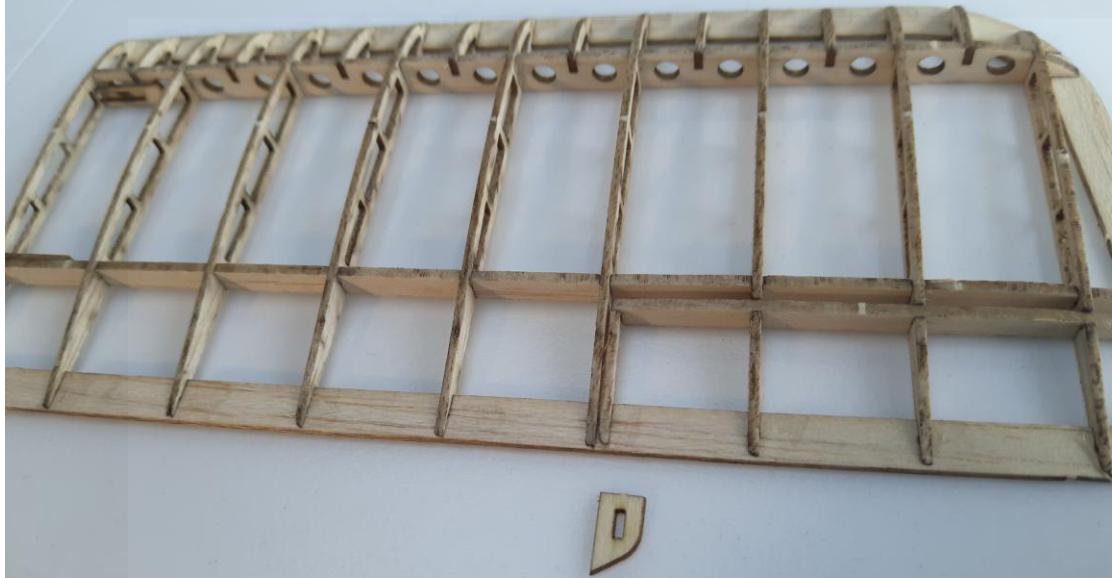

Step43

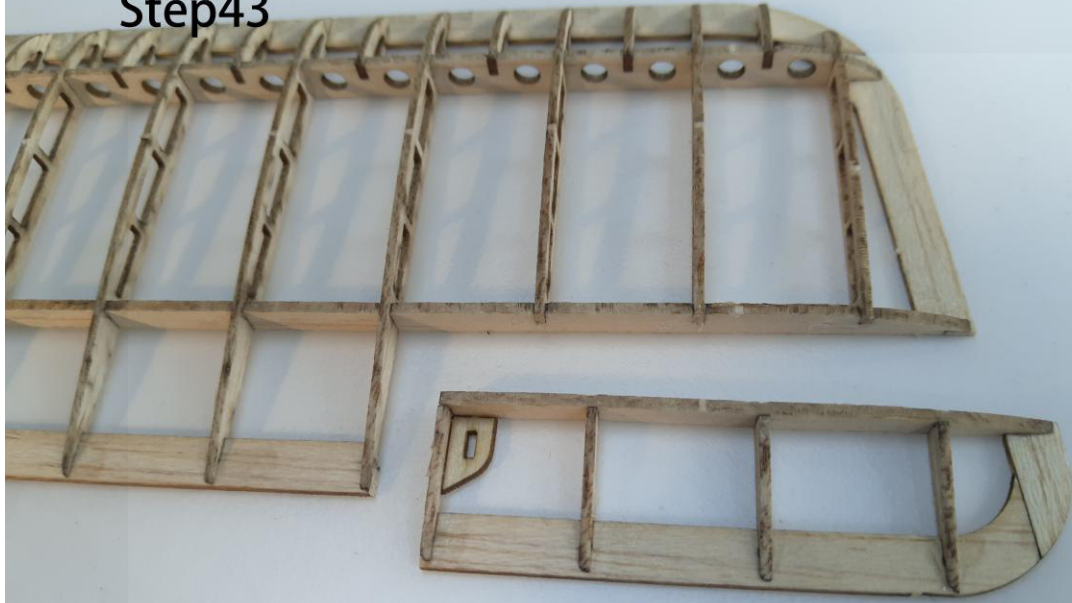

Attention: This plane suitable for both 3ch and 4ch flying, if you prefer to 3ch flying, please don't cut off the aileron.

Step44



Step45



Step46



Step47



Step48

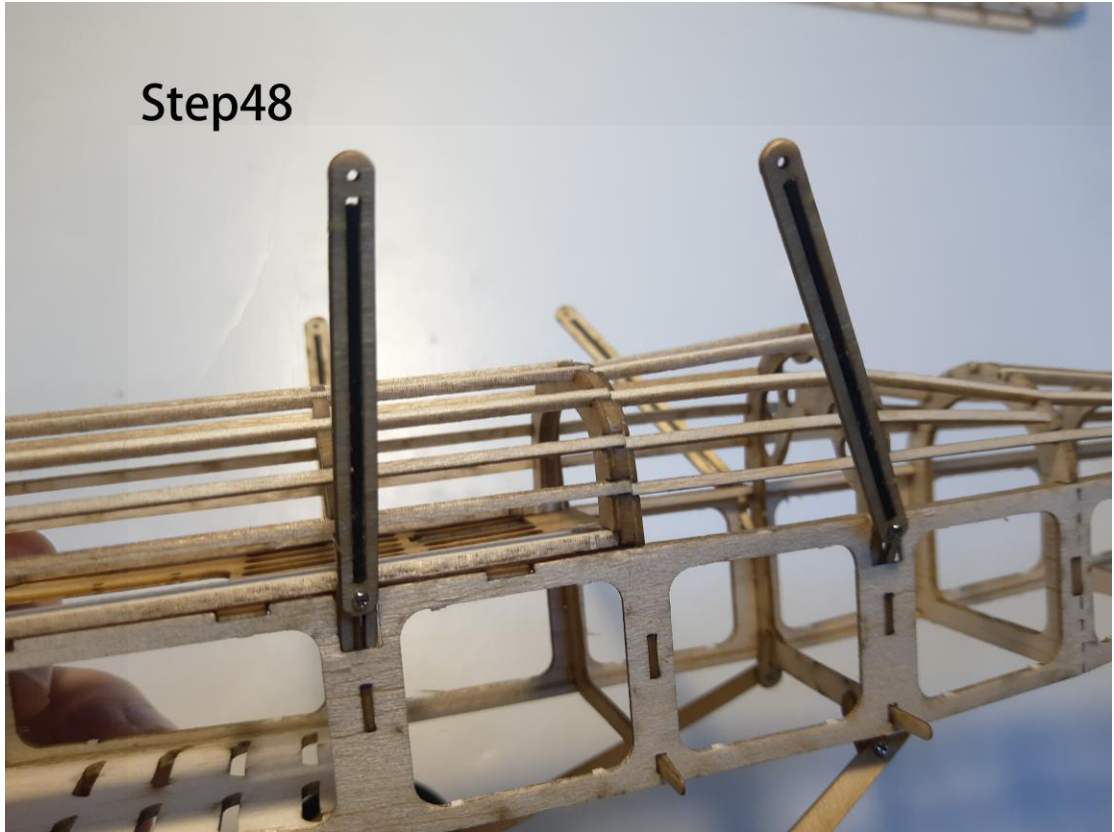

Step49



Step50



Teil 3: Zubehör

Step1



Step2



Step3



Step4



Step5

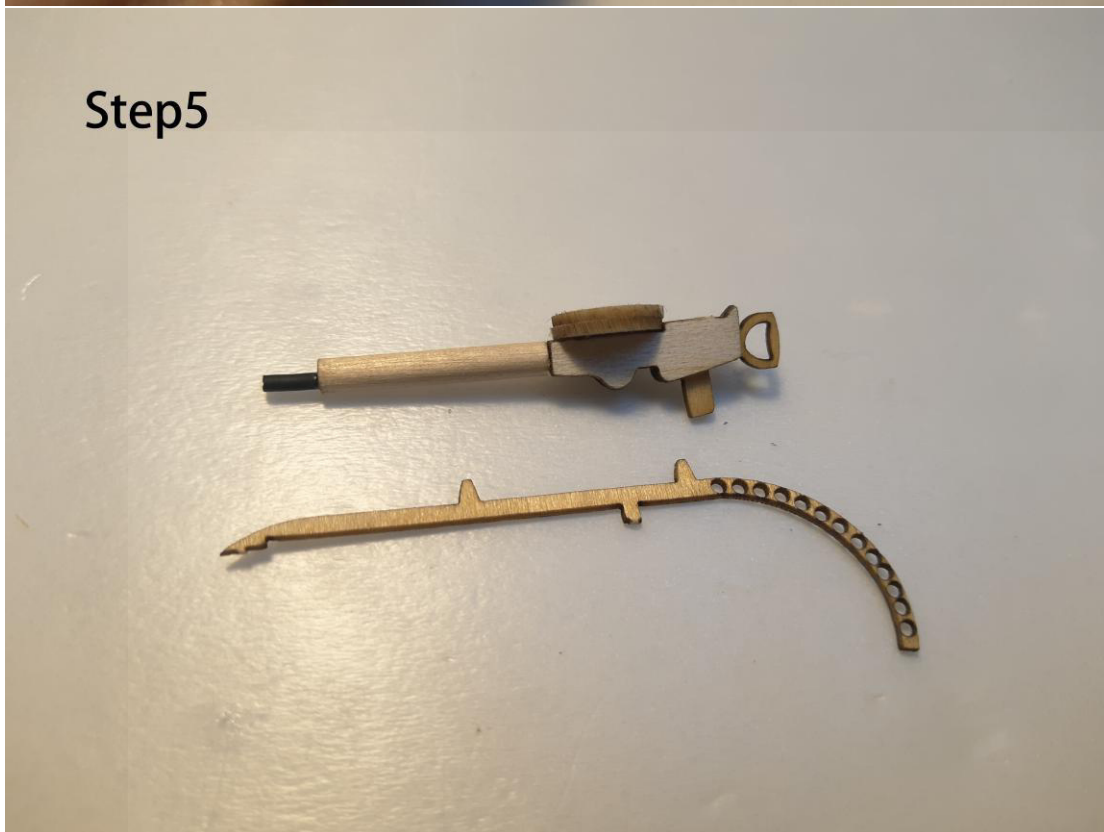

Step6



Step7

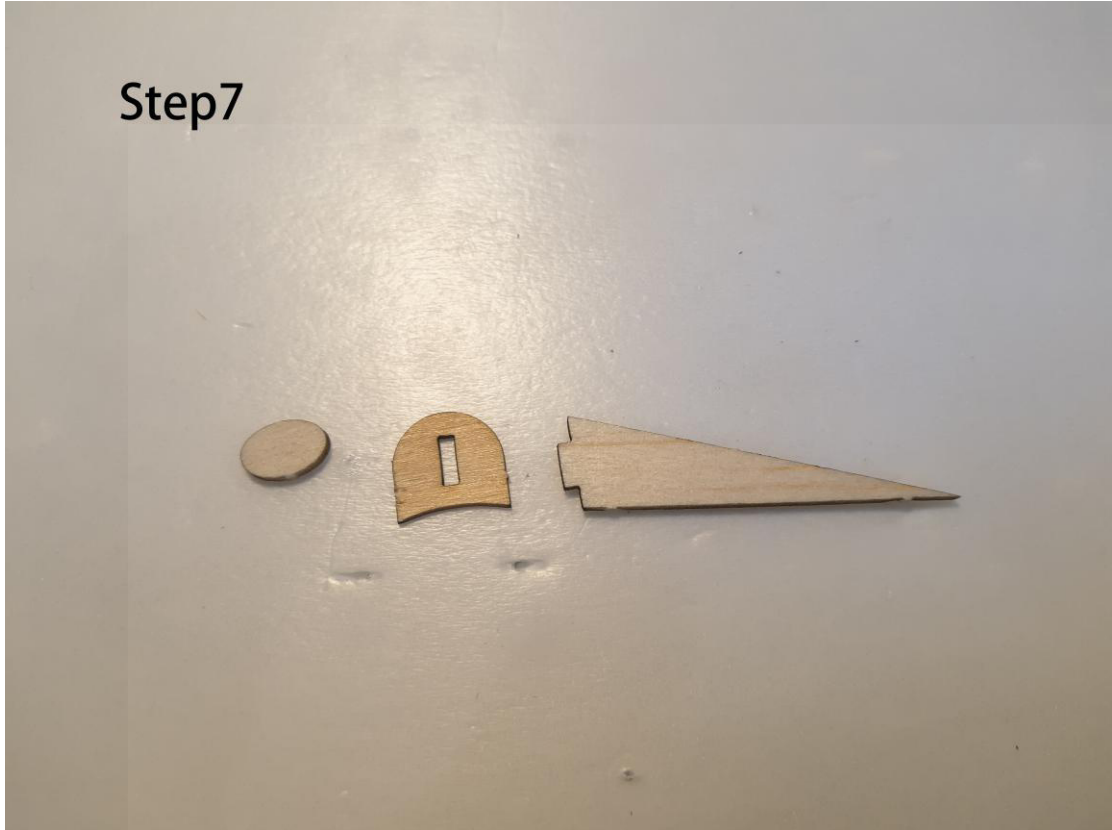

Step8



Step9

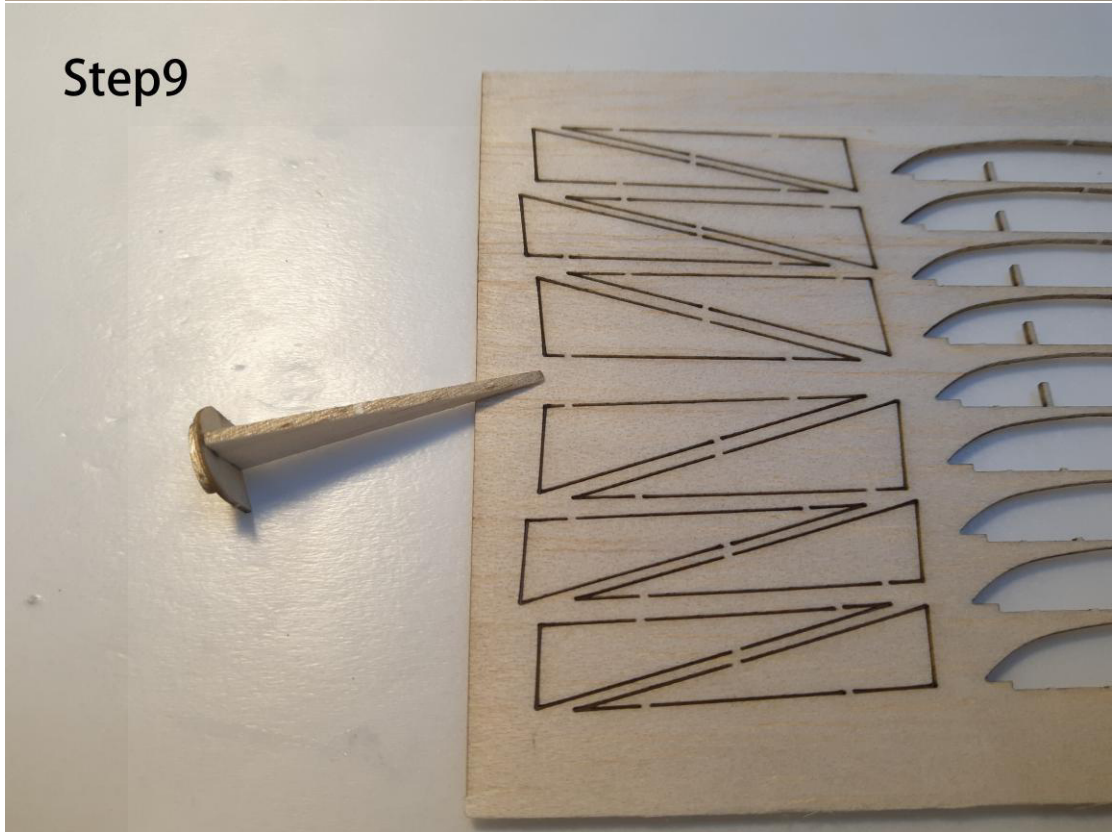

Step10



Step11



Step12



Step13



Step14



Step15



Step16



Step17



Step18

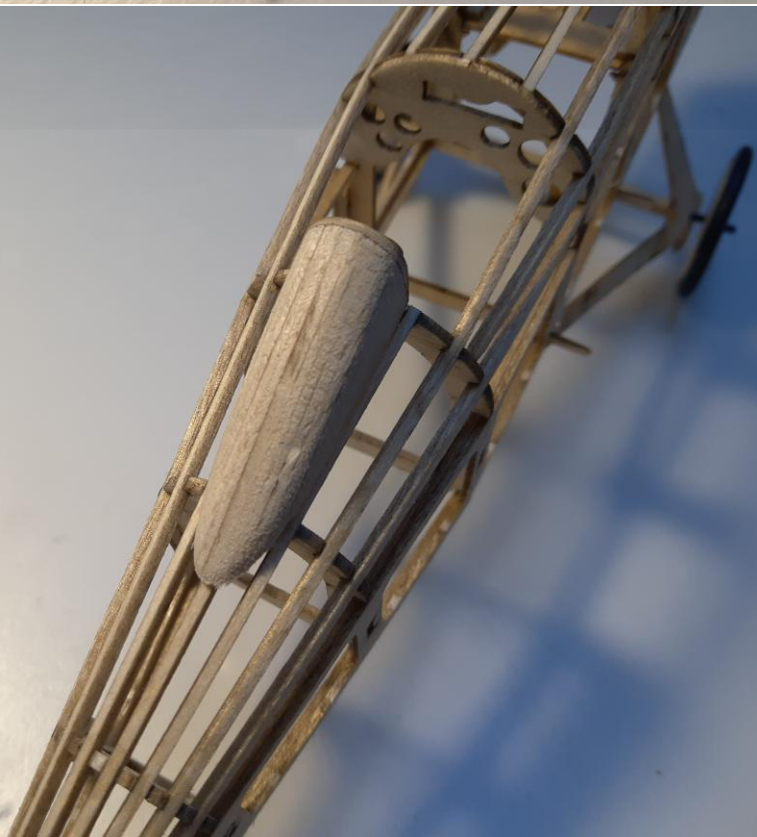

Step19

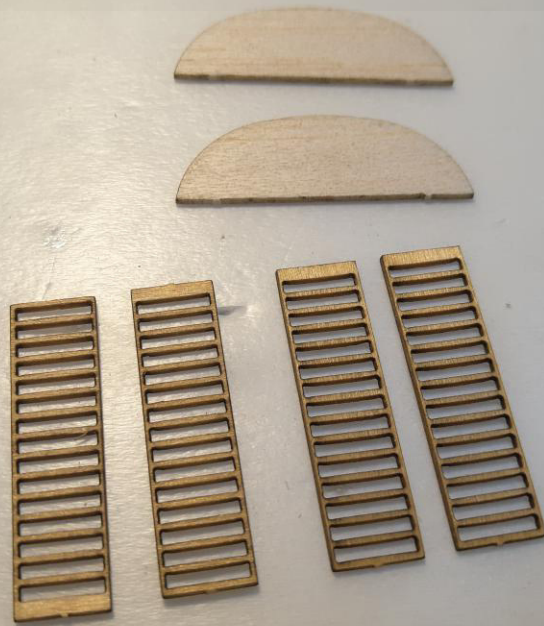

Step20

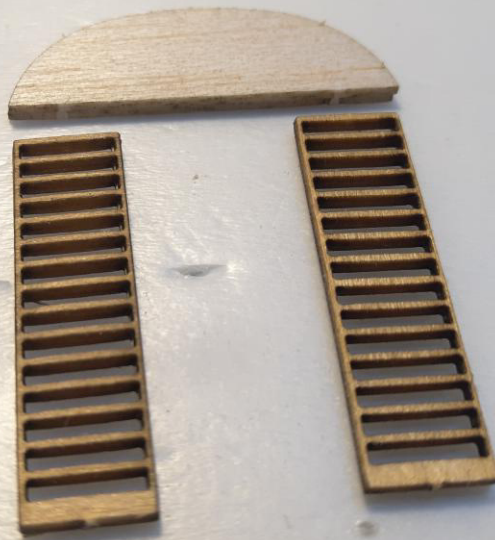

Step21



Step22

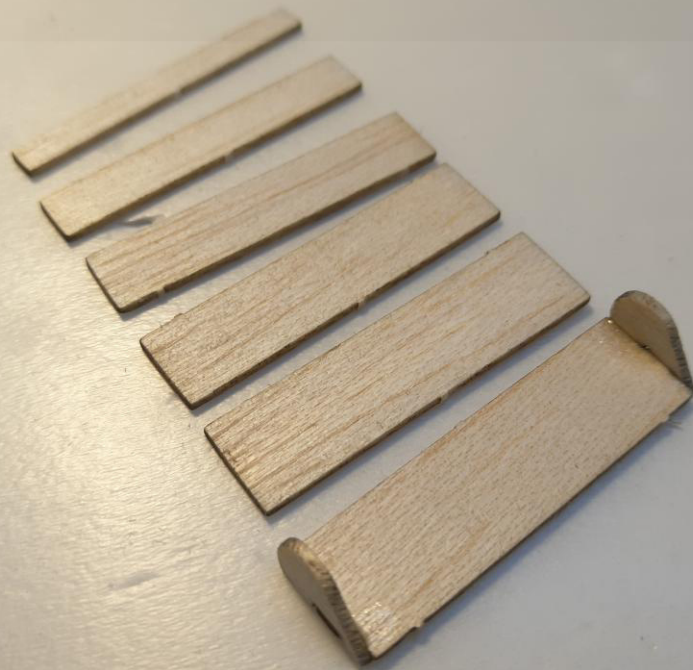

Step23



Step24



Step25



Step26



Step27

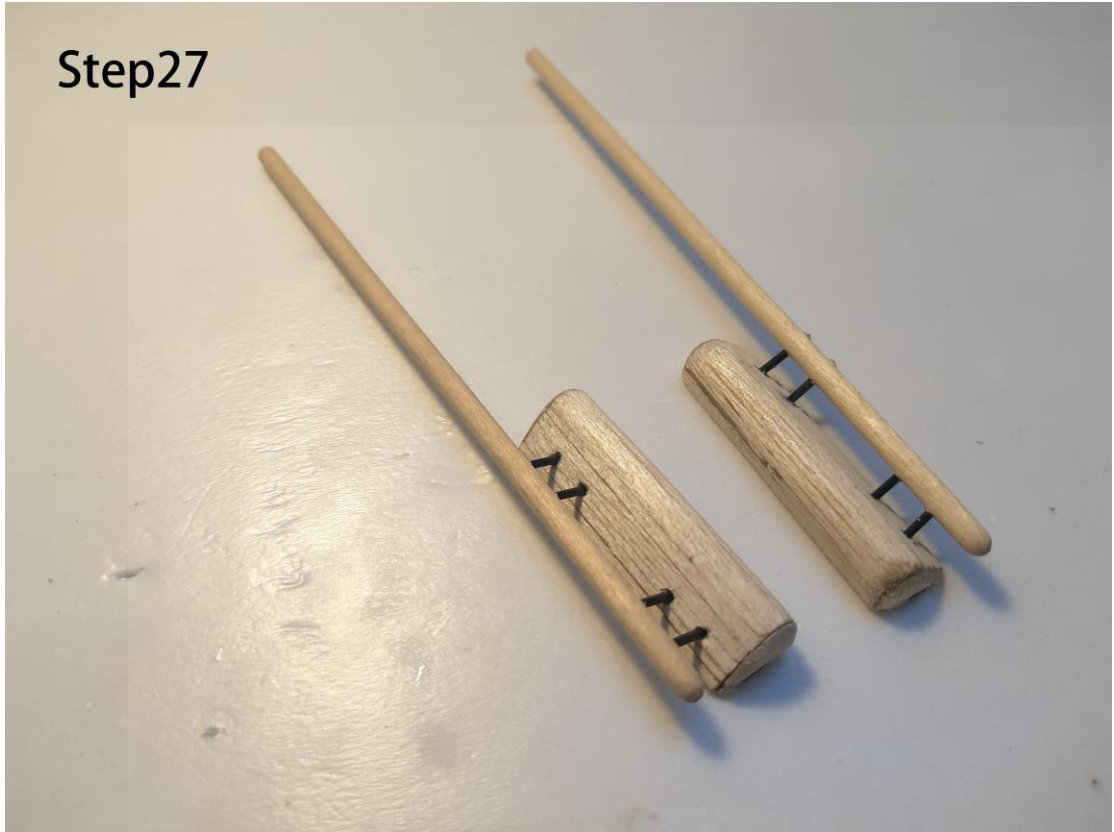

Step28

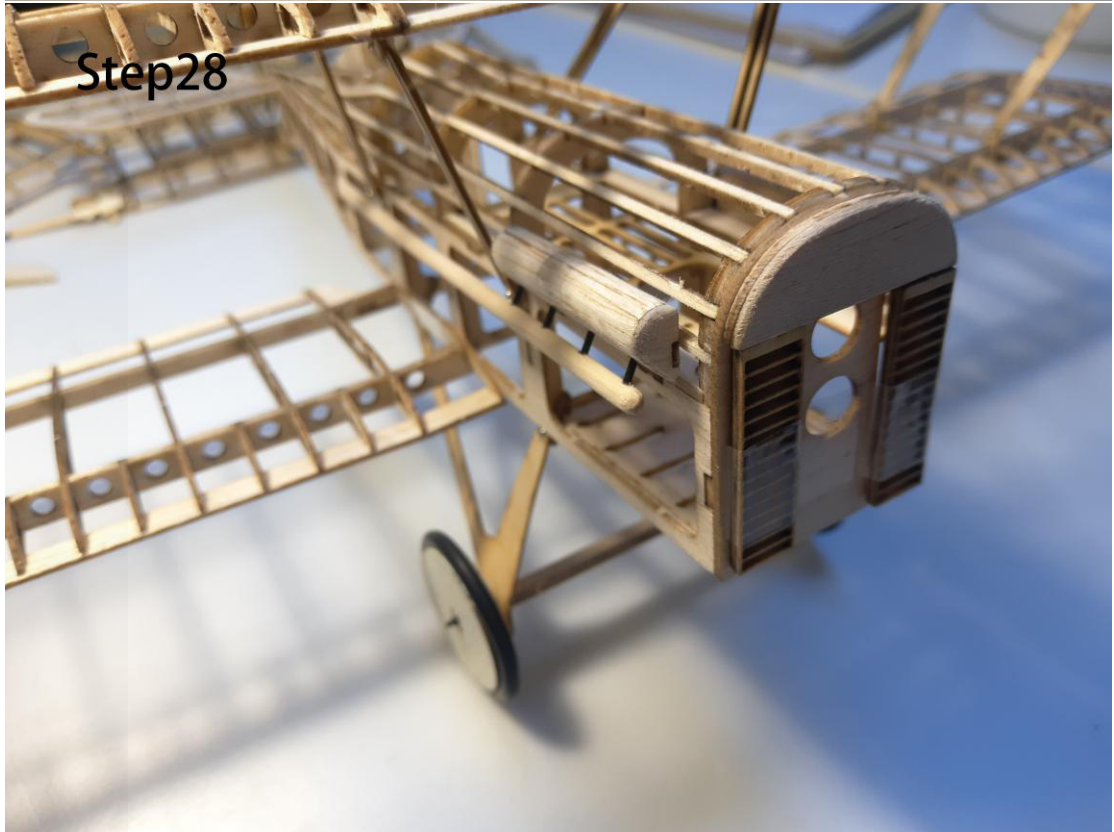

Teil 4: Elektronik

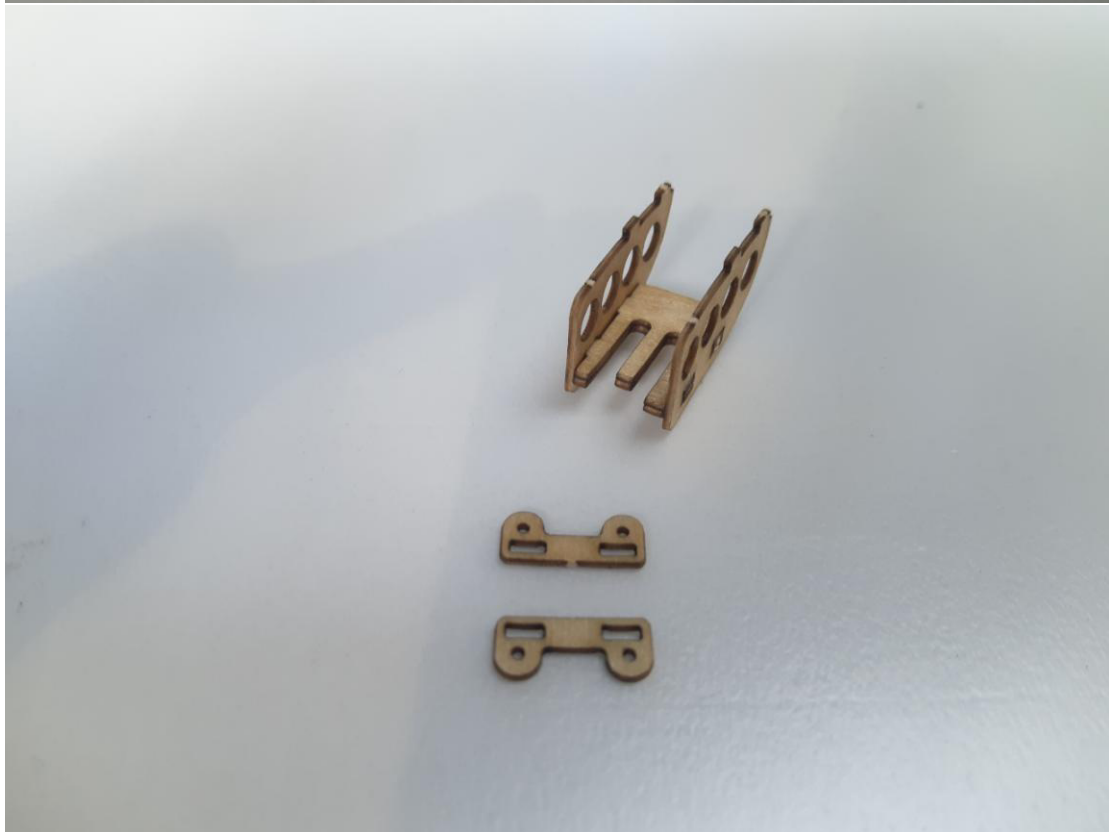

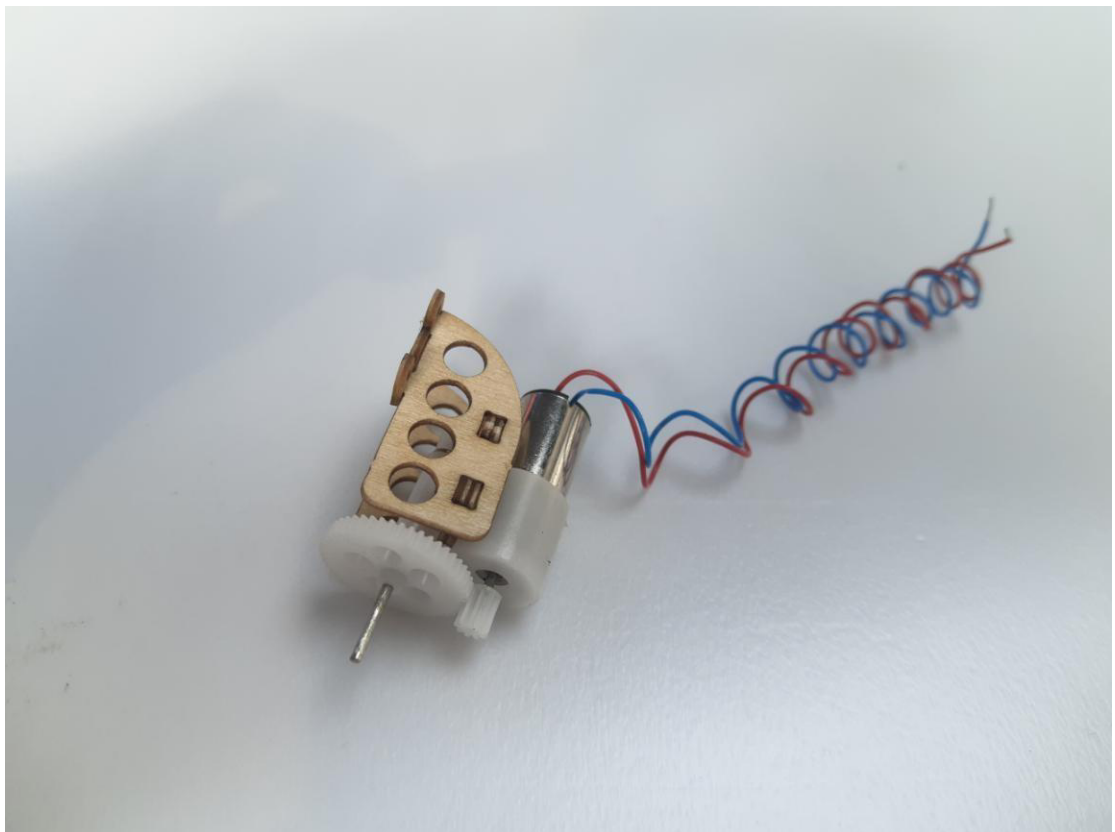

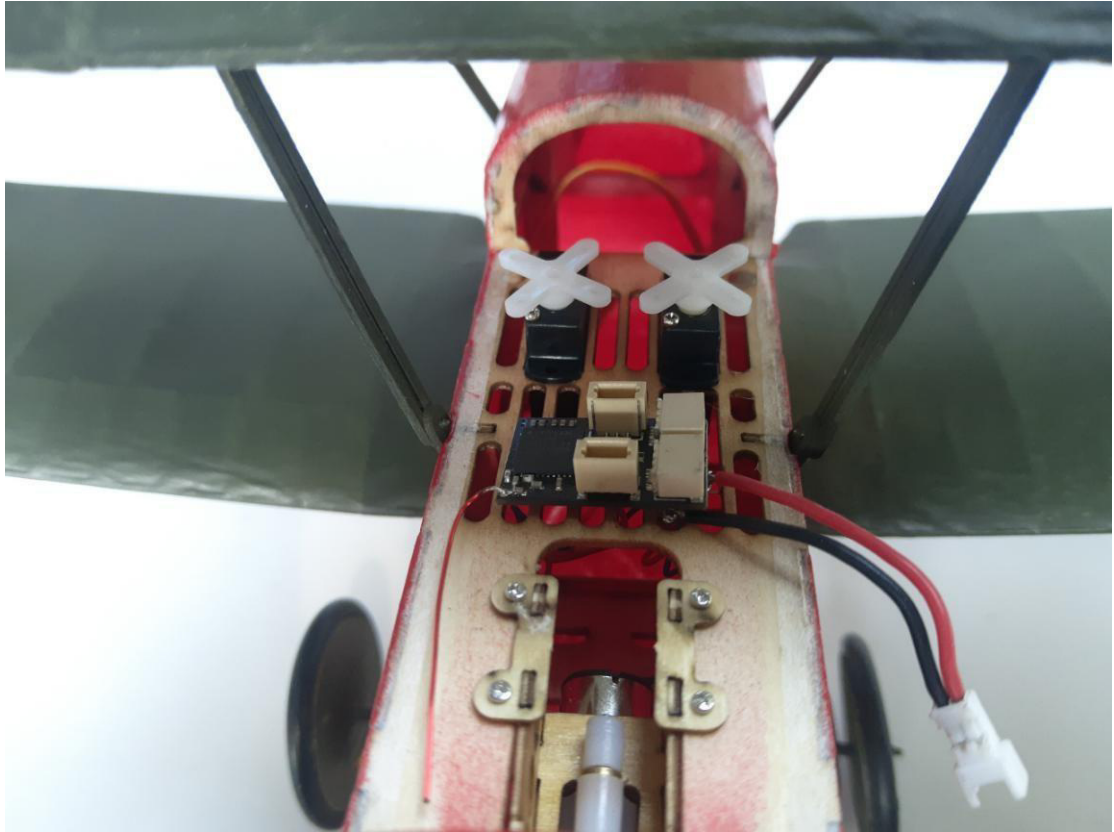
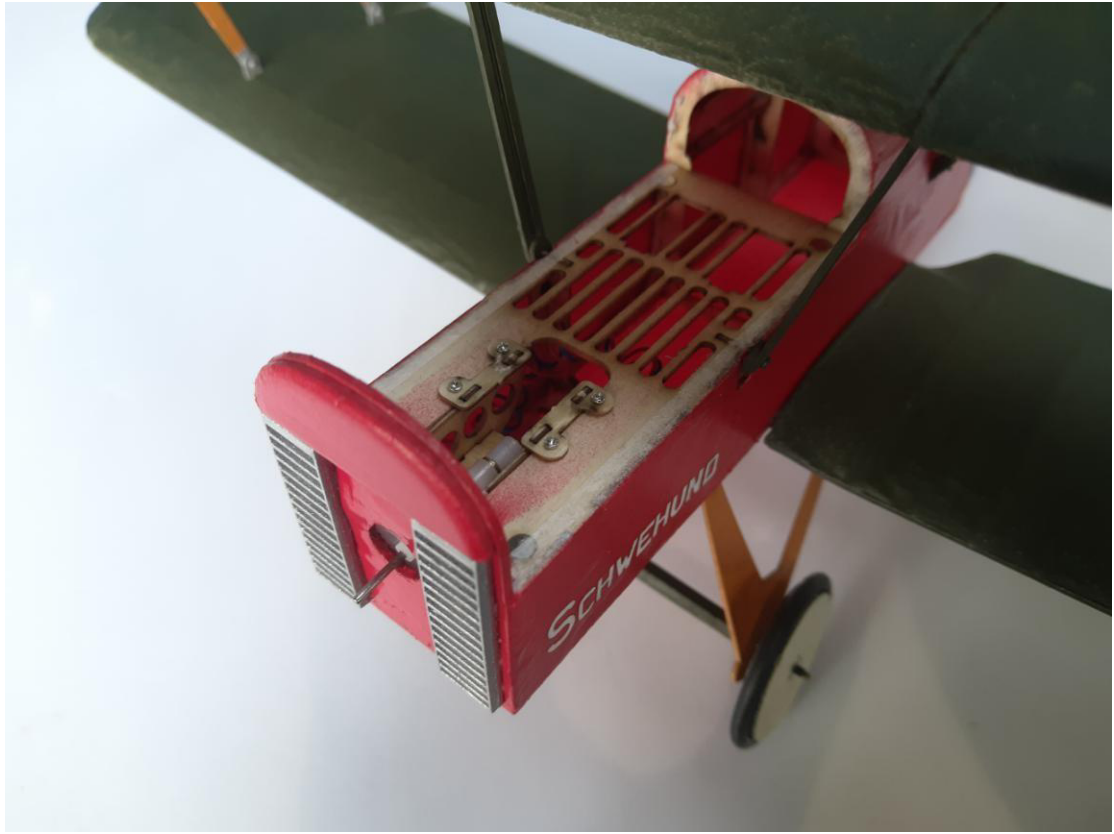



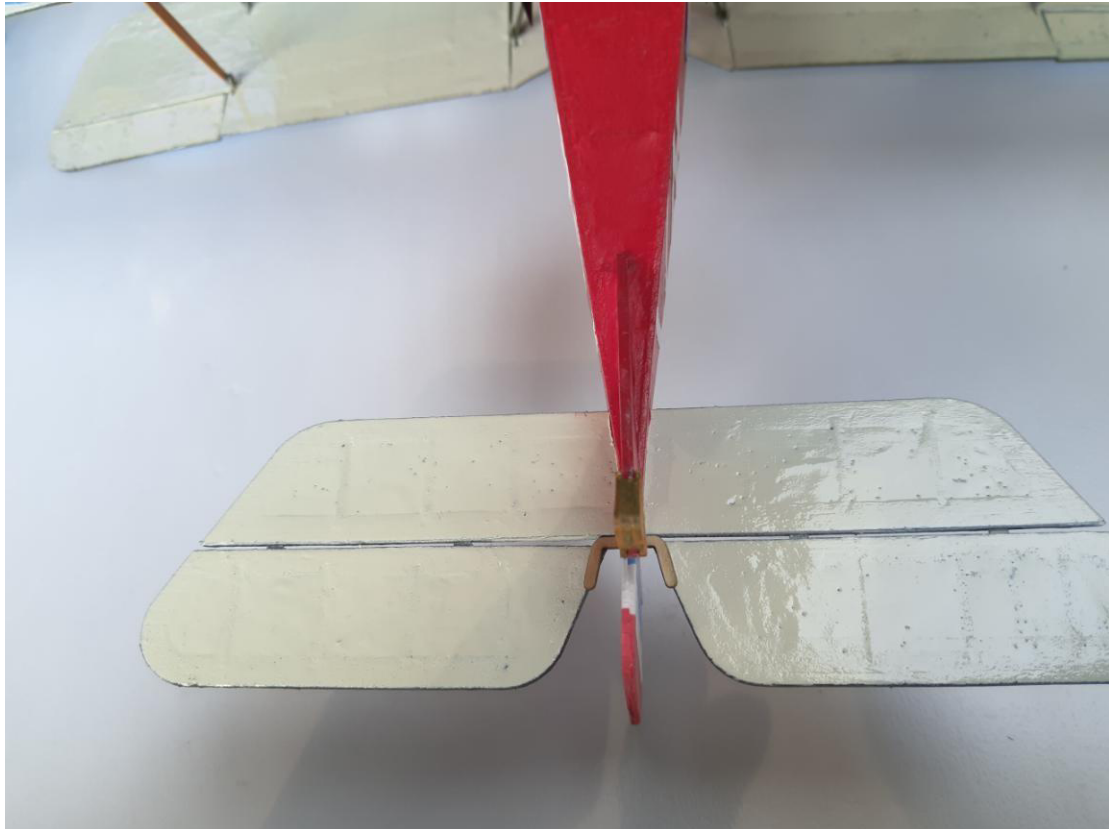

This plane designed for both 3ch and 4ch flying. If you prefer to 4ch flying, please add a 1.7g liner servo for the aileron.



(Same way with the Fokker dr.1)

Geschafft!

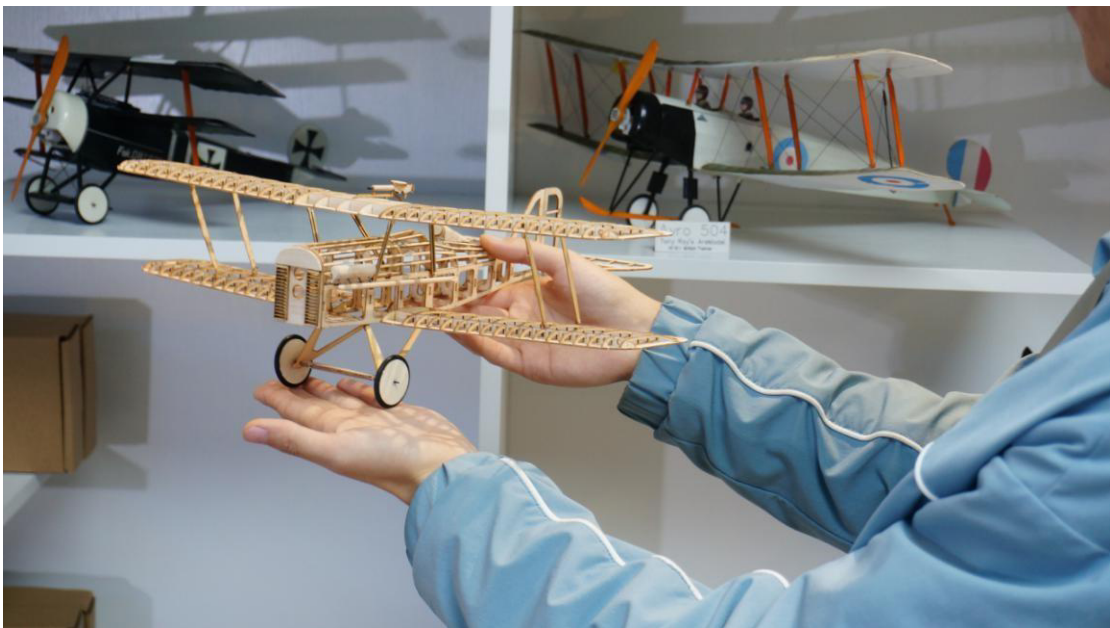

Herzlichen Glückwunsch, Sie haben Ihre RAF SE5A fertig gebaut.

Nun müssen Sie die elektronischen Kleinteile richtig zusammensetzen und Ihr Modellflugzeug mit Bespann-Folie eindecken.

Sie haben noch nie Bespannfolie verwendet?

Hier haben wir Ihnen eine hilfreiche **Anleitung** verlinkt:

<http://www.ffscale.co.uk/comp8.htm>



Sie können gar nicht genug von Slow Flyern kriegen?

Uns geht es genauso!

Für Ihre Sammlung haben wir **viele weitere Modelle** im Angebot.

Wie wäre es zum Beispiel mit dem erfolgreichsten britischen **Doppeldecker?**

Die Sopwith Camel.



Wir schicken Ihnen Ihre Modelle wie gewohnt schnell und sicher verpackt zu.

Weitere viele schöne Modelle warten auf Sie!

Klicken Sie einfach auf folgende Links:

1. [Modellflugzeug Zubehör \(Sticker, Dekoration, Elektronik, Motor\)](#)
2. [Etrich Taube KIT](#)
3. [Blériot XI KIT](#)
4. [Fokker E.3. KIT](#)
5. [Sopwith Camel KIT](#)
6. [Avro 504k KIT](#)
7. [P-51D Mustang KIT](#)
8. [Mitsubishi A6M2 Zero Fighter KIT](#)
9. [Fokker DR.1 KIT](#)
10. [Humming Bird KIT](#)

Bei Fragen und Anregungen erreichen Sie uns jederzeit unter:

info@slowflyer-bausaetze.de

